

WE MAKE RIDERS

CHICOUTIMI, QUÉBEC



TECHNICAL MANUAL

EWOC FS 2024+

DEVINCI



BRINGING TOGETHER BIKES AND RIDERS SINCE 1987



ABOUT OUR MANUALS

Like many sports, cycling involves risk of injury and accidents, so you must be fully aware of these risks. Neither the manufacturer, the retailer, nor the person who sold you the bike, nor the people who maintain the trails are responsible for these risks. As you are solely responsible, it is, therefore, essential that you read and fully understand all the parts contained in this manual.

To enjoy maximum safety and enjoyment right from the get go, it is important that you are familiar with your new bike, its handling and its possibilities. It is your duty to maintain your bike well and reduce the risk of injury. Biking can be a dangerous activity, even under the best conditions. These are risks associated with using a bicycle that cannot be predicted or avoided. These are the sole responsibility of the cyclist.

YOUR AUTHORIZED DEVINCI RETAILER

Your authorized Devinci retailer is at your service to guide your choices of bike and accessories which are best suited to the style of biking you wish to perform. This will help you maintain your equipment in good condition so that you can take full advantage of your investment. The staff at your authorized Devinci retailer have the training, experience and tools to carry out the repairs and provide you with reliable advice.

However, your authorized Devinci retailer cannot make decisions for you, and cannot be held responsible for your lack of knowledge, experience, qualification or common sense. However, it will take the necessary time to explain the operation of a component or to help you choose an accessory that meets your specific needs.

For further information, please see the Devinci's User Manual available on www.devinci.com or ask your authorized Devinci retailer. He will take the time to answer any questions you may have and will advise you with great pleasure.



TABLE OF CONTENTS

FRAME: TECHNICAL SPECIFICATIONS	6
---------------------------------	---

CABLE ROUTING	10
---------------	----

SERVICE KITS	20
--------------	----

WARRANTY	27
----------	----



FRAME

TECHNICAL SPECIFICATIONS

HEADSET DIMENSION		
1. UPPER (S.H.I.S)	ZS44	1-1/8" Zerostack
2. LOWER (S.H.I.S)	ZS56	1.5" Zerostack
BOTTOM BRACKET		
3. STANDARD	73mm BSA	
MECHANICAL DRIVETRAIN		
4. REAR HUB SPACING O.L.D. (Over Locknut Dimension)	TA 12x148 BOOST	
5. MAX & MIN CHAINRING	30T	28T
6. SMALLEST COG COMPATIBLE	12s 9T	
7. BIGGEST COG COMPATIBLE	12s 52T	
8. RECOMMENDED CHAINLINE	52 mm	
9. MINIMUM Q-FACTOR	173 mm	
SEATPOST & SEATCLAMP		
10. SEATPOST INSIDE DIAMETER (ID)	31.6 mm	
11. SEAT TUBE OUTSIDE DIAMETER (OD)	35 mm	
12. DROPPER POST COMPATIBLE	Oui Interne/externe à partir de la boîte de pédalier	
BRAKES		
13. BRAKE MOUNT (FRAME)	Post mount 180 direct	
14. MAX ROTOR SIZE COMPATIBLE (FRAME)	180 mm	
ACCESSORIES		
15. PROTECTORS	DT & CS	
16. WATER BOTTLE COMPATIBILITY	NO	
GEOMETRY INPUTS		
EWOC FS FORK 140 MM TRAVEL 125MM		
17. FRONT SUSPENSION TRAVEL & SAG	140 mm	20-25%
18. FORK AXLE-TO-CROWN & OFFSET	519	42
19. REAR SUSPENSION TRAVEL & SAG	125 mm	33%
20. SHOCK LENGTH AND STROKE (upper & lower)	40x10 mm	35x10 mm
21. TIRE CLEARANCE	Compatible with up to 26x2.4 (61-559) based on 24x2.4 (61-507)	

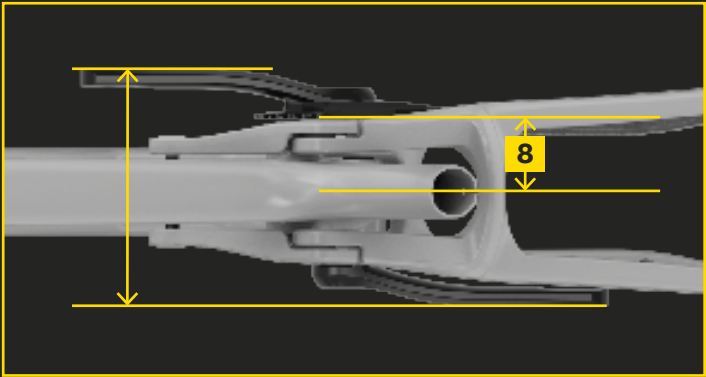



C A B L E R O U T I N G

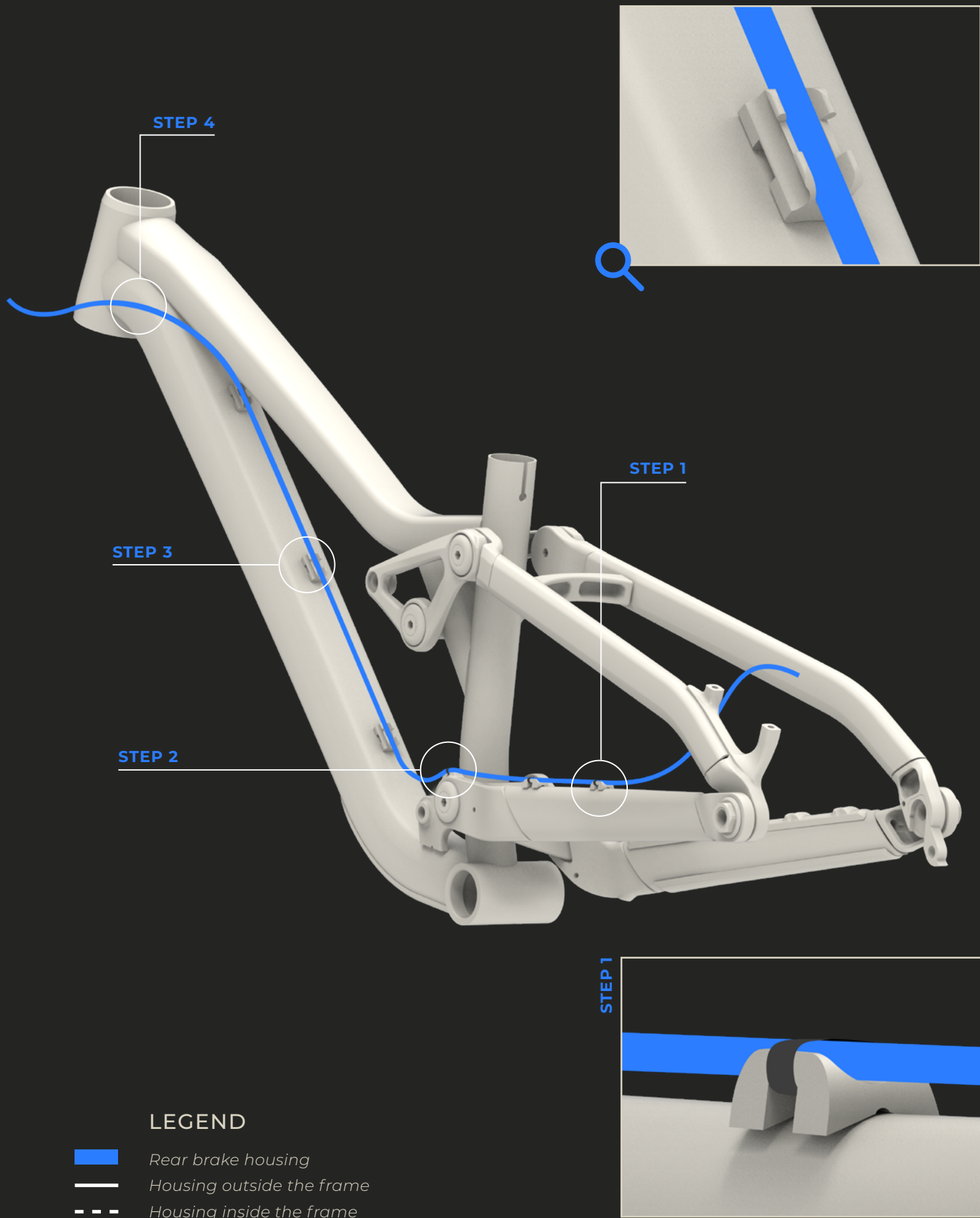

CABLE ROUTING



REAR BRAKE HOUSING

STEP 1 | Attach the housing to the provided supports on the top left side of the base.

STEP 2 | Pass the housing through the provided support located on the pivot on the left side of the base.

STEP 3 | Pass the housing through the supports provided along the center of the diagonal.

STEP 4 | Align the housing on the left side of the bike.

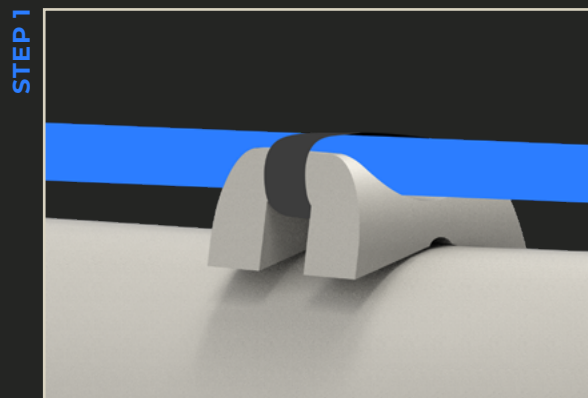

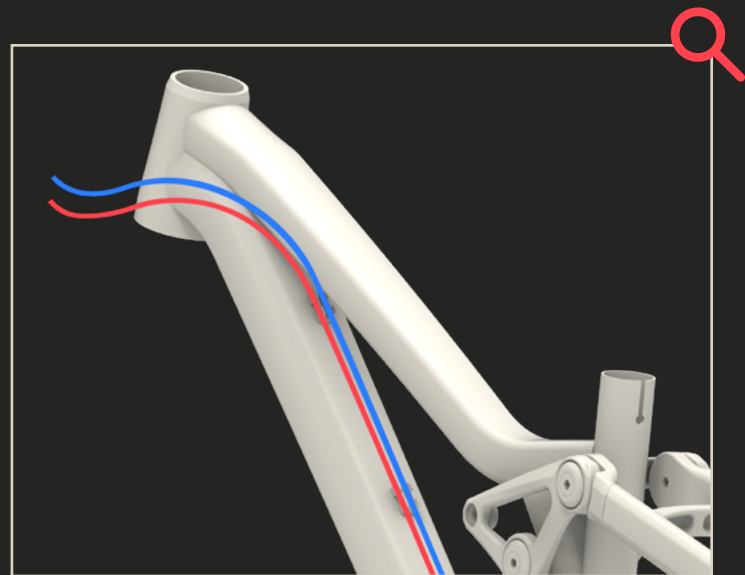

STEP 5

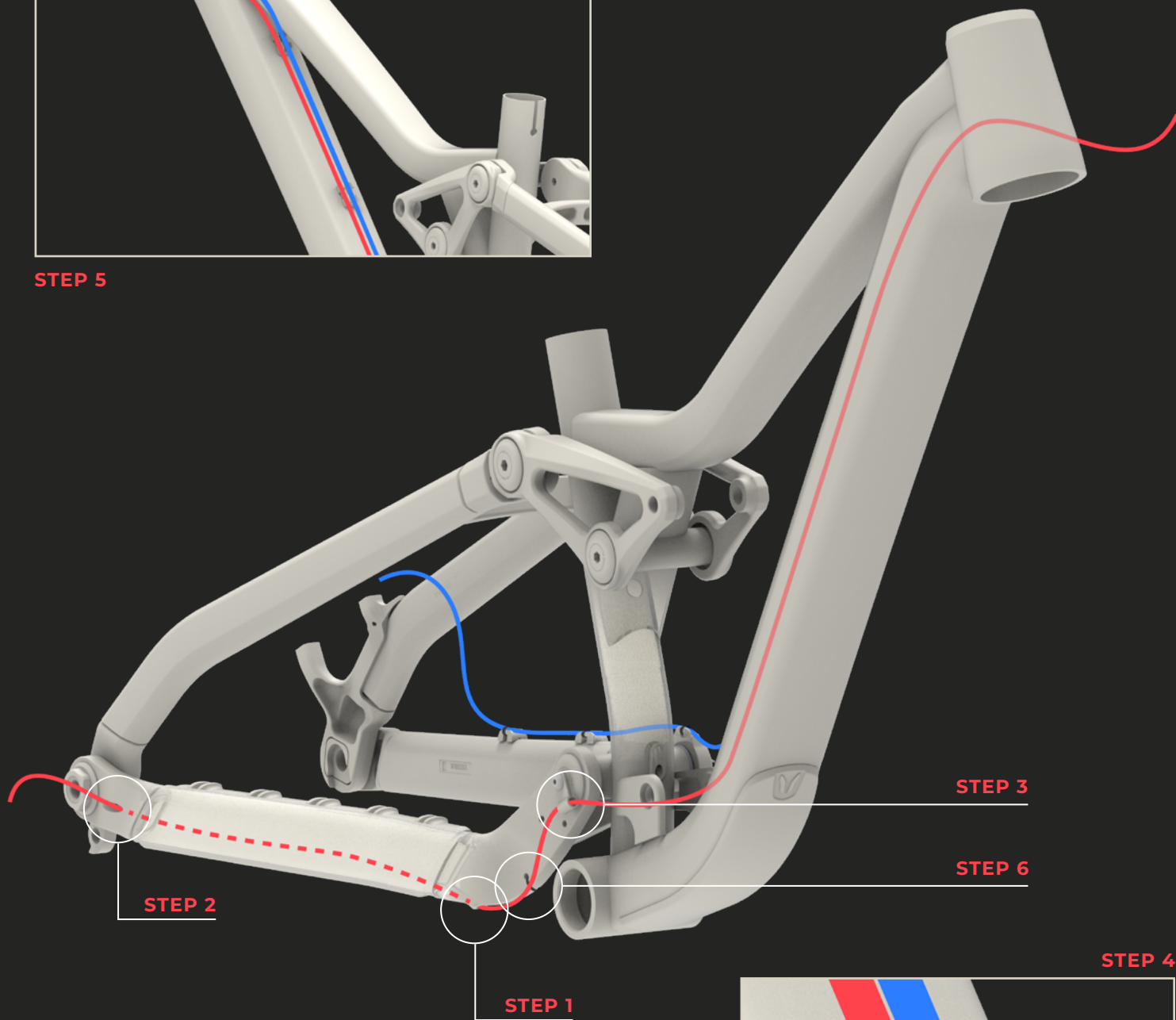

- LEGEND**
- Speed housing
 - Housing outside the frame
 - Housing inside the frame

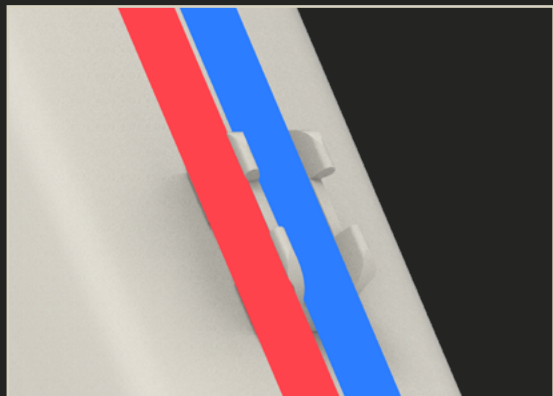

STEP 4



CABLE ROUTING



SPEED HOUSING

- STEP 1** | Thread the speed housing through the base from the front opening of the base.
- STEP 2** | Pull the housing out through the rear opening of the base using a hook if necessary.
- STEP 3** | Pass the housing through the bracket provided for this purpose located at the pivot on the right side of the base.
- STEP 4** | Pass the housing on the left side of the cable guides located on the diagonal.
- STEP 5** | Align the rear derailleur housing on the left side of the bike.
- STEP 6** | Secure the housing to the base using a small zip tie.

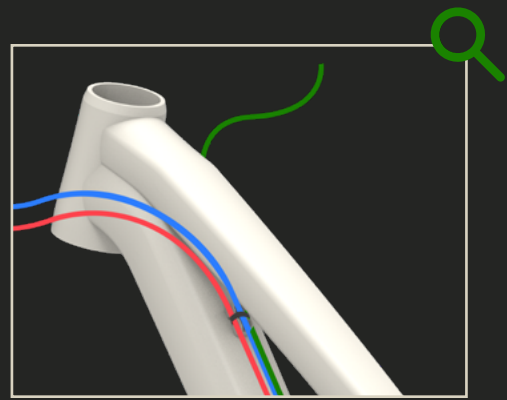

STEP 2

STEP 4

STEP 1

STEP 3

LEGEND

- Seatpost housing
- Housing outside the frame
- Housing inside the frame

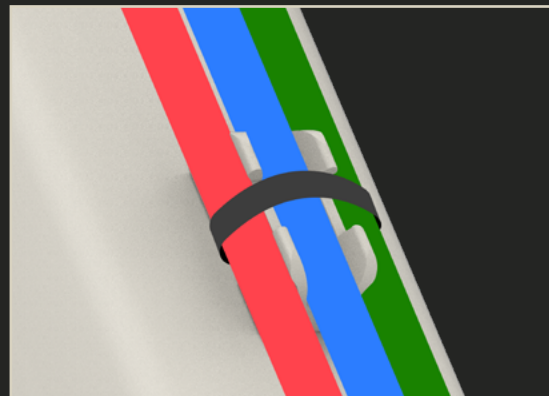

CABLE ROUTING

SEATPOST HOUSING

- STEP 1** | Pass the housing under the shock, then insert it into the cavity located at the bottom of the seat tube.
- STEP 2** | Bring the housing out through the upper opening of the seat tube.
- STEP 3** | Secure the housing on the supports provided along the right side of the downtube using zip ties.
- STEP 4** | Align the rear derailleur housing on the right side of the bike.

CABLE ROUTING OVERVIEW

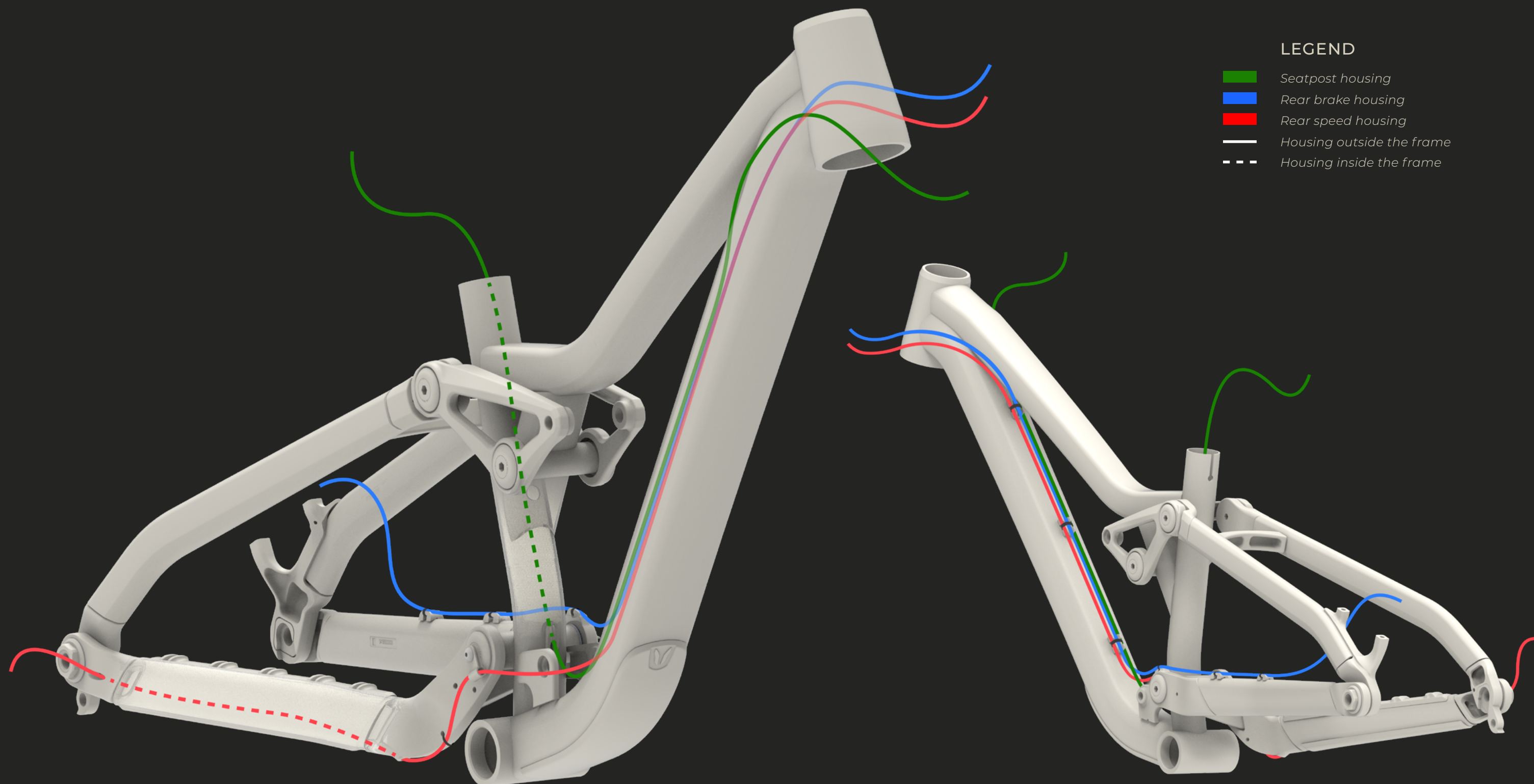

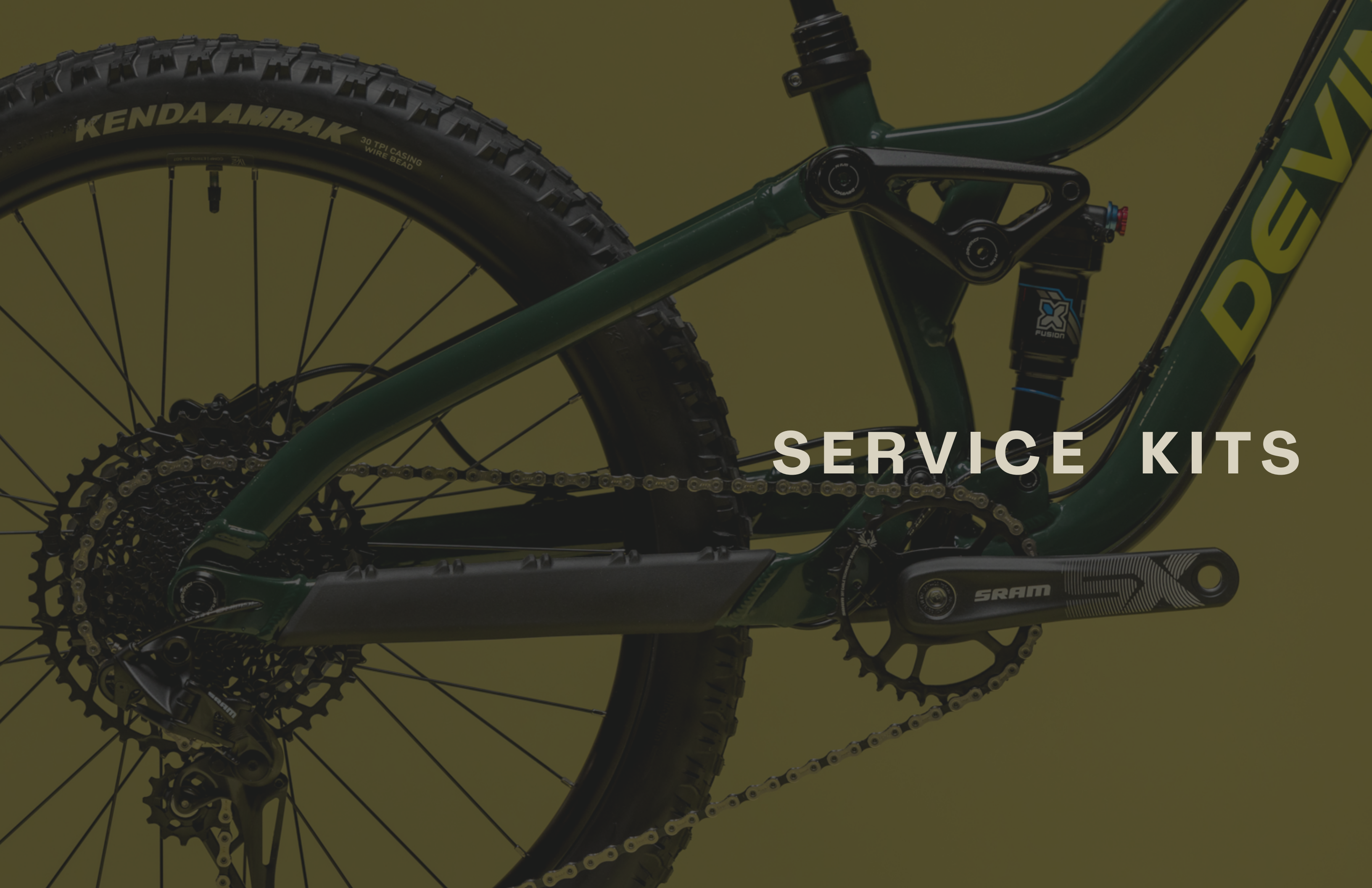

SERVICE KITS

KFC05202 EWOC FS 2024+			
ITEMS	PART #	DESCRIPTION	QTY
1	MFV21001	Socket Cap Screw M17x1.0x21mm	2
2	MFP21006	CS Pivot Shaft 80mm With M5 Thread	1
3	MFP20033	Pivot Shaft Screw 10mm With M5 Thread	2
4	MFP16016-01	Pivot Shaft 72mm	1
5	MFP11080	Spacer Pivot Chainstay	2
6	MFP11032	Dropout Pivot Left Shaft	1
7	MFP11031	Dropout Pivot Right Shaft	1
8	MFP11011-01	Pivot Nut	2

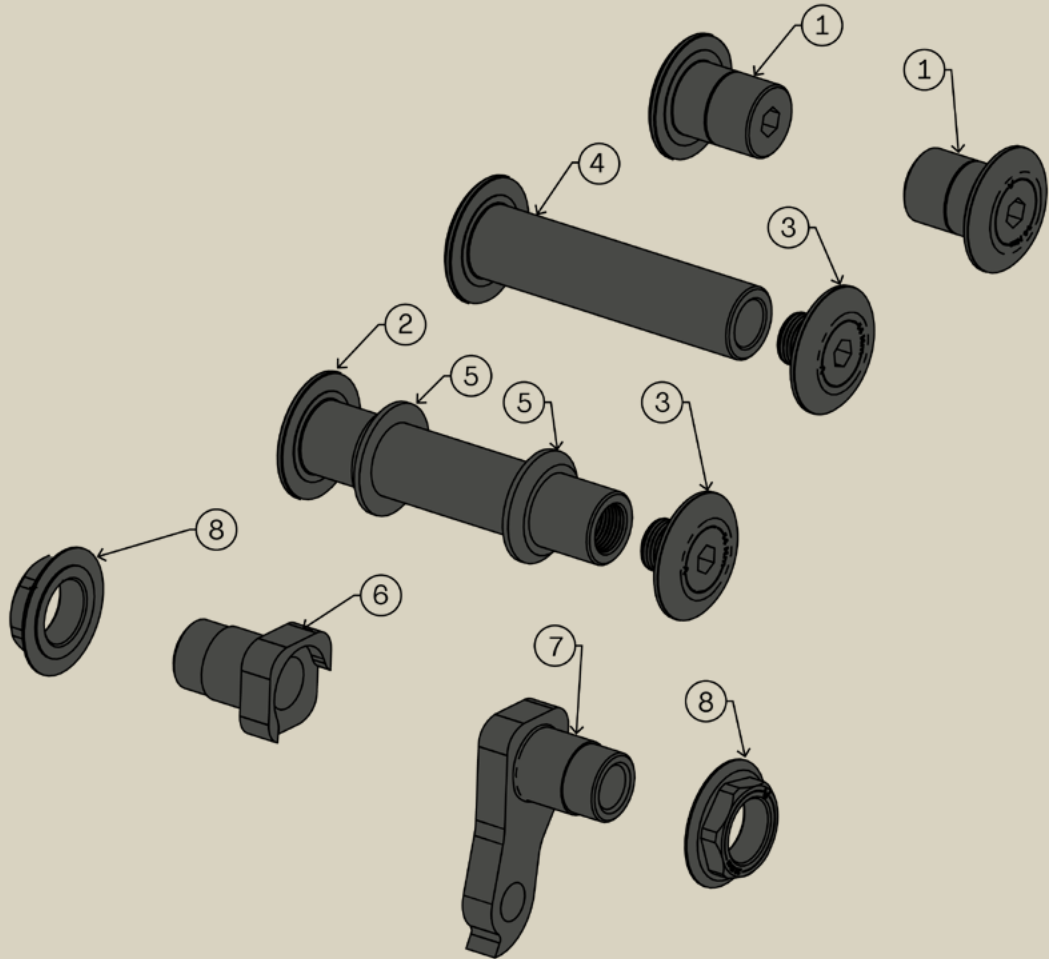

KFC05202 | **SHAFT/PIVOTS KIT (BLACK)** EWOC FS



KFC04302 EWOC FS 2024+			
ITEMS	PART #	DESCRIPTION	QTY
1	MACP20006	DT Protector For Mtdtdt18012	1
2	MACP20007	CS Protector Pcb-013/Pcb-043	1

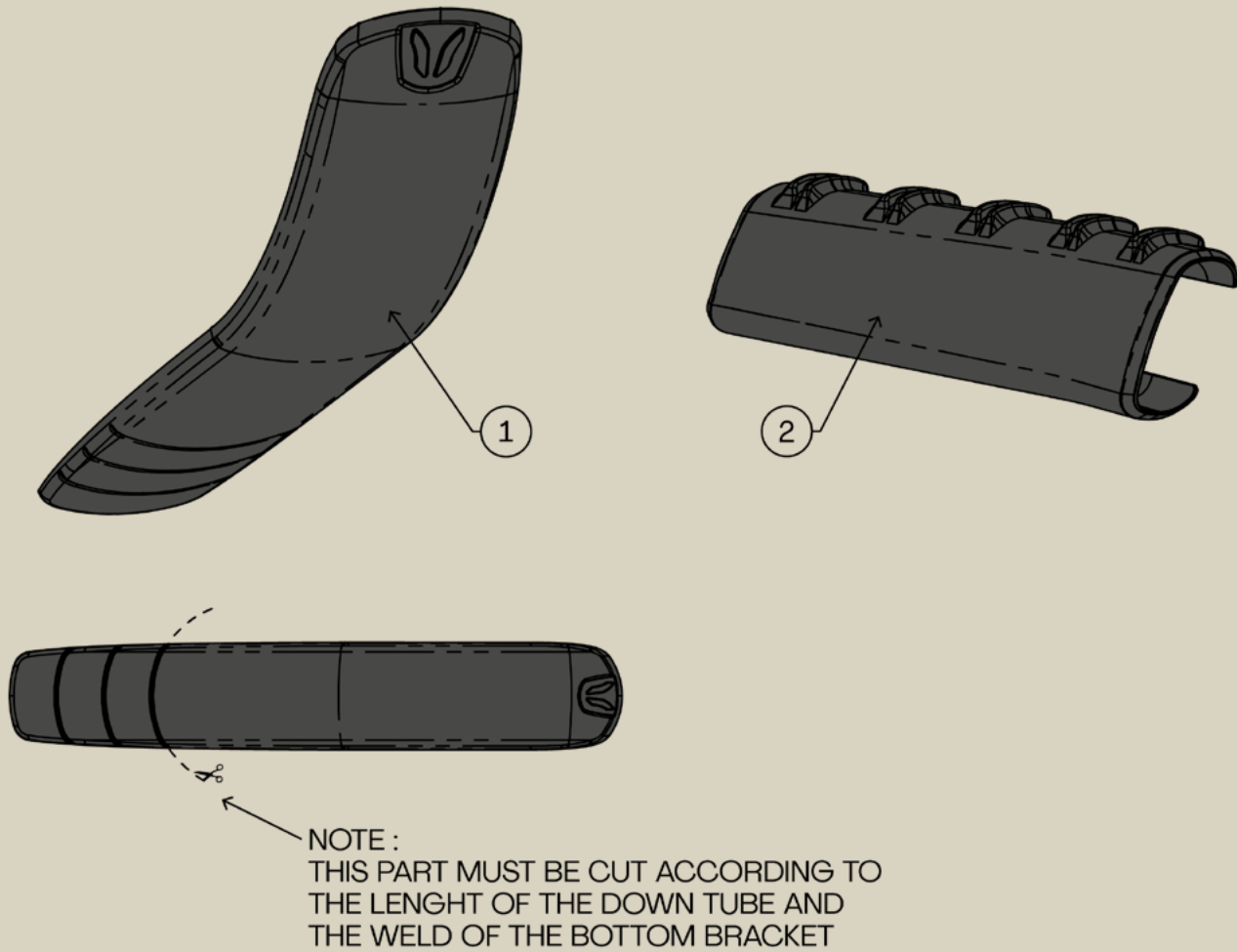

KFC04302 | **PROTECTORS KIT** EWOC FS



KFC05203 EWOC FS 2024+			
ITEMS	PART #	DESCRIPTION	QTY
1	MFB18002	Cable Holder M5 For Cable(B) Dia.5mm	1
2	MFB19008	Cable Guide 5mm	1
3	MFB17017	Plastic Cable Guide Yf-W09	1
4	MFV07004-01	Hex. Socket Button Screw M5x0.8 X 16mm	1

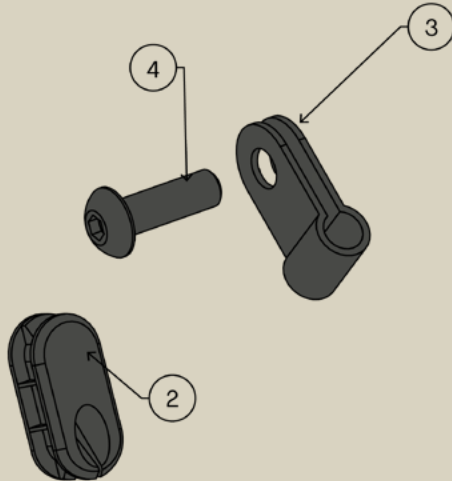

KFC05203 | CABLE GUIDES EWOC FS

KFC05201 EWOC FS 2024+			
ITEMS	PART #	DESCRIPTION	QTY
1	MFV19002-XX	Socket Cap Screw M10x1.0 X 67mm	1
2	MFV21002	Allen Cap Screw M10x1.0 X 48mm	1

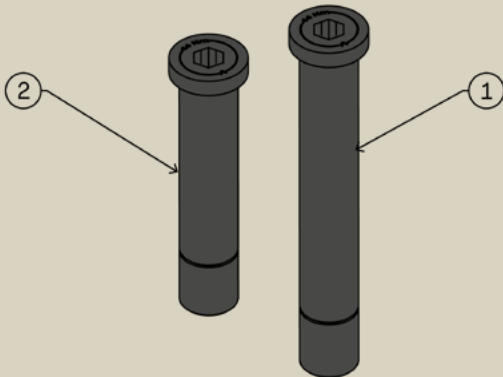

KFC05202 | SPLIT PIVOT SHOCK BOLT KIT (BLACK) EWOC FS



KFC19011 EWOC FS 2024+			
ITEMS	PART #	DESCRIPTION	QTY
1	MAQRR19002	Rear Axle TA148*12mm 182.5(200.5)	1

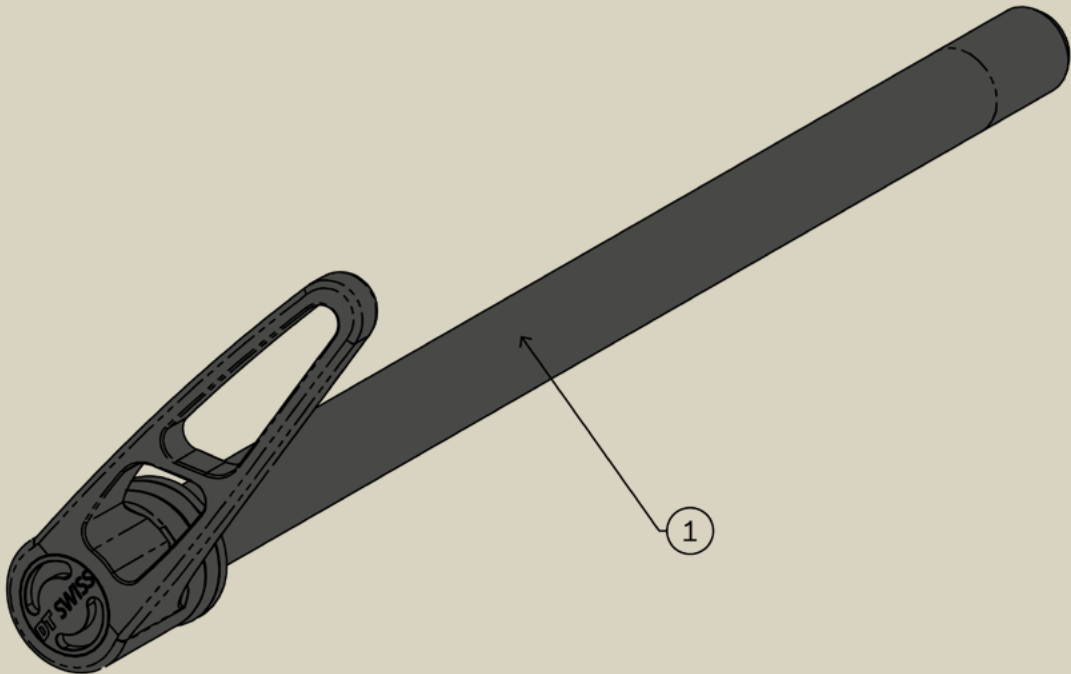

KFC19011 | REAR AXLE BOOST 148X12MM/201MM EWOC FS



KFC11024 EWOC FS 2024+			
ITEMS	PART #	DESCRIPTION	QTY
1	MFP11022	Ball Bearing 6903 17x30x7, Std Type, Double Lip	8

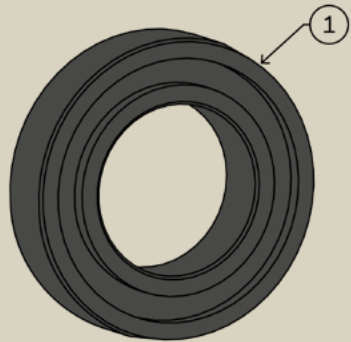

KFC11024 | BEARING SPLIT PIVOT KIT EWOC FS

KFC11051 EWOC FS 2024+			
ITEMS	PART #	DESCRIPTION	QTY
1	MFP11031	Dropout Pivot Right Shaft	1

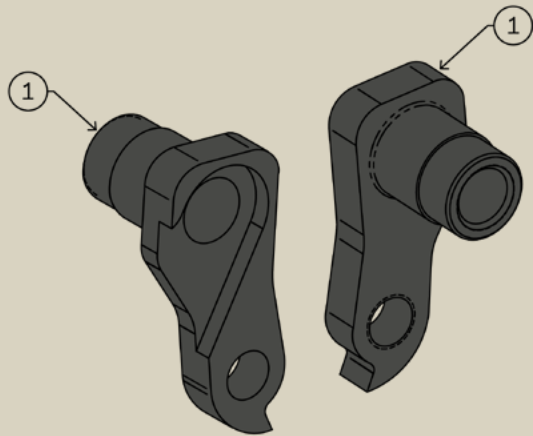

KFC11051 | DERAILLEUR HANGER SPLIT PIVOT EWOC FS



DEVINCI WARRANTY



At Devinci, durability, performance, and peace of mind are at the core of everything we build. That’s why our warranty is designed to protect your investment and support you long after your purchase.

WHAT’S COVERED

FOR THE ORIGINAL OWNER

- **Aluminum frames:** Lifetime warranty* for the bicycle’s useful life
- **Carbon fiber frames:** Lifetime warranty* for the bicycle’s useful life
- **Paint and decals:** 1-year warranty
- **Suspension pivots (bearings, bolts, axles):** 1-year warranty

*Proof of purchase is required for all warranty claims.

COMPONENTS

All components on Devinci bikes are covered by their respective manufacturer warranties. For questions, your authorized Devinci retailer is your go-to resource. <https://www.devinci.com/en/find-a-dealer/>

OUTSIDE THE WARRANTY? WE’VE GOT YOUR BACK.

CUSTOMER ASSISTANCE PROGRAM

Accidents happen. That’s why we created the [Devinci Customer Assistance Program](#).

If your situation isn’t covered under warranty—whether it’s a crash, damage, or just bad luck—we’ll help you get back on the road or trail with a **discount on replacement parts**, based on their original retail price. This program is offered **for life**, at our discretion, and is available through our customer service team or any authorized Devinci retailer.

WHAT’S NOT COVERED

Our warranty does not apply in the following cases:

- Bike not purchased from an authorized Devinci retailer
- Improper assembly or service not performed by an authorized retailer
- Accidents, misuse, or excessive/abusive riding
- Damage from high-intensity use (racing, bike parks, improper transport, etc.)
- Structural or cosmetic modifications to the frame
- Normal wear and tear or material fatigue over time
- Costs of replacing parts that are worn out or obsolete at the time of the claim

For any questions, please contact our customer service team or your nearest Devinci retailer.

DEVINCI WARRANTY POLICY

All Devinci frames are covered by a manufacturer’s warranty against defects in materials and workmanship for a specified period, as detailed below, starting from the date of purchase. Any parts replaced or repaired under this warranty are covered for the remaining duration of the original warranty period.

The bicycle owner must provide proof of purchase to make a warranty claim.

Replacement parts are subject to availability within Devinci’s inventory at the time of the claim. In some cases, the color, features, and/or model may differ from the original part.

At Devinci’s discretion, certain costs may apply when processing a warranty replacement or repair, including:

- Shipping fees
- Additional labor costs associated with the installation or repair of a part
- Costs of replacing parts that are worn out or obsolete at the time of the claim

WARRANTY DURATION

For the original purchaser:

- Aluminum frames are covered for the lifetime of the bicycle’s useful life.
- Carbon fiber frames are covered for the lifetime of the bicycle’s useful life.
- Paint and decals are covered for one (1) year from the original date of purchase.
- Suspension frame pivots (including bearings, bolts, and axles) are covered for one (1) year from the original date of purchase.
- The components assembled on Devinci bicycles are exclusively covered by the warranties provided by their respective manufacturers, with Devinci assuming no responsibility. Please contact your authorized Devinci dealer for more details on applicable warranties.

CUSTOMER ASSISTANCE PROGRAM

For those unexpected moments when your situation is not covered under our warranty policy, Devinci’s Customer Assistance Program is here to help. Whether it’s a crash, accidental damage, or simple bad luck, this program is designed to get you back on the road or trails as quickly as possible by offering a discount on replacement parts based on their original retail price.

This program is separate from Devinci’s manufacturer warranty and is managed at Devinci’s sole discretion. It is accessible through our customer service department or any authorized Devinci retailer.

WARRANTY EXCLUSIONS

At Devinci’s discretion, the warranty may be void under the following circumstances:

- The bicycle was not purchased from an authorized Devinci retailer.
- The bicycle was not fully assembled by an authorized Devinci retailer.
- Repairs were not performed by an authorized Devinci retailer.
- The instructions in the user manual and/or technical manual were not followed.
- Recommended periodic inspections and maintenance outlined in the user manual and/or technical manual were not performed.
- Non-compatible parts were installed. Compatible parts include original components or those specified as compatible in the user manual and/or technical manual.
- Paint damage caused by the application or removal of an adhesive frame protector.

DEVINCI WARRANTY

- Damage resulted from accidental or unforeseen events, such as:
 - Accidents, impacts, or falls
 - Misuse, abnormal or excessive use, or negligence
 - Intensive use beyond the scope of normal recreational cycling
 - Improper or repeated use of ski lifts, vehicle racks, or other transportation methods
 - Use in competition or in environments/activities beyond the intended design of the bicycle
- Additional damage caused by continued use of the bicycle after an initial defect, if a warranty claim was not filed or was denied.
- The frame and/or components were altered (e.g., polishing, structural or mechanical modifications, stripping, sanding, shot peening, etc.).
- The frame size or model is inappropriate for the rider.
- Damage caused by normal wear and tear, including material fatigue over time.

LIMITATION OF LIABILITY

This warranty represents the complete and final warranty coverage for Devinci frames. Devinci does not authorize any individual, including authorized dealers, to offer any additional warranty beyond what is explicitly stated herein. Any other obligations, representations, or illustrations made by any party are not binding on Devinci and are excluded from this warranty.

Subject to applicable laws in Quebec and Canada, Devinci assumes no liability for material, bodily, or moral damages suffered by the user, purchaser, or any other party due to the use of a Devinci frame or component, except in cases of negligence or intentional misconduct by Devinci, as determined by a competent court.

Unless otherwise prohibited by applicable law, Devinci disclaims all other warranties, express or implied, including but not limited to implied warranties of merchantability or fitness for a particular purpose. Devinci's liability will not exceed the actual purchase price of the bicycle, nor will it cover any special, incidental, or consequential damages related to the bicycle.

By claiming warranty rights, the purchaser agrees that any legal proceedings shall be conducted in the judicial district of Chicoutimi, Province of Quebec, Canada.



1987



WE MAKE RIDERS

HEAD OFFICE

1555 Main
Chicoutimi (Quebec) Canada
G7K1G8

www.devinci.com