

WE MAKE RIDERS

CHICOUTIMI, QUÉBEC



ELECTRIC
SYSTEM



TECHNICAL MANUAL

E-TROY 2023+

DEVINCI



PLEASE READ BEFORE USING YOUR BIKE

Even if you have already piloted a bike for years, it is important to be aware of the information contained in the User's Manual and the Specific Manual PAB (Power-Assisted Bike). Read them carefully before riding your E-Troy :

- These documents contain important information.
- Understand the use, layout and maintenance of each electrical components of your new PAB.

Your safety and those of other is paramount:

- Never ride the bike without its battery; the battery must be on the bike when you head out, otherwise there will be no lights on the bike.
- Never ride the bike without a saddle; failure to comply with this rule could lead to accidents.
- Inspect your bike to make sure there are no loose screws or components or damages. In the event of a defect, visit your authorized Devinci retailer for a repair.
- A PAB is faster than a normal bike, risks of accident with other users on the road may occur.
- Ride under the conditions mentioned in the Owner's Manual.
- For PAB's that have a rear rack: the limit is 20 kg.

The electrical system requires careful handling:

- Do not clean the bike with a high-pressure jet. The system is sensitive to moisture. High-pressure water may seep into the connectors or other parts of the electrical system.
- Handle the battery carefully and pay attention to electric shocks. Failure to comply with this instruction could lead to abnormal heating or severe damage. In very rare cases, the consequences of an electrical shock could lead to a fire. In case of doubt, have the battery inspected by an authorized Devinci retailer.

Perform maintenance of the battery as mentioned in the Technical Manual.



NOTE → Failure to follow the instructions below may damage the battery and require you to purchase a new battery kit.

- Charge the bike with the Bosch charger only;
- When the battery is not used for a long time, recharge to 100% (from 4 to 5 LEDs ont the charge indicator);
- Check the battery charge status regularly when not in use, recharge it to 100% if the load is less than 20% (1 indicatior light on the charge gauge). Check the load every month and have it fully charged every 6 months;
- It is not recommended to keep the battery connected to the charger for a long period;
- If the battery remains uncharged for a long time, it can lose a significant part of its effectiveness;
- Store the battery in a well-ventilated and dry place. Pay attention to moisture;
- In case of poor conditions, remove the battery from the bike and store it in a dry place until next use;
- The battery can be stored at temperatures between -10°C (14°F) and 40°C (104°F). For long service life, store it at a temperature close to 20° C (68°F);
- Monitor the storage temperature and try to avoid discrepancies. For example, do not leave the battery in your car during summer or leave the battery outdoors during a storm in winter;
- It is recommended to store a battery which is not connected to the bike.

Follow the transport instructions for your PAB:

- Comply with local laws regarding transportation on the PAB;
- A PAB is heavier than a normal bike, so you must be careful when transporting it. Check that the maximum load of the rack, roof or bike rack used is respected. Refer to the support manual used;
- The Li-Ion battery of your PAB, due to its size, is considered a "Class 9 dangerous good" during transport. Applicable regulations could limit transport of a separate Li-Ion battery (when the battery is not on the bike) in some places. This regulation applies to several airlines and a number of road transport companies. On the other hand, if you are planning to move around with a full PAB (when the battery is on the bike), regulations are less strict. In case you use these transport methods, check the regulations that apply to your PAB with your transport company before booking.

Visit your authorized Devinci retailer for regular maintenance of your new PAB:

- Only your retailer has the know-how and the proper equipment to maintain your PAB.
- If you have any question about your PAB, please ask for assistance from your retailer.



ABOUT OUR MANUALS

Our user manuals meet ISO 4210-10TS, EN 15194 et EN 14766 standards.

Like many sports, cycling involves risk of injury and accidents, so you must be fully aware of these risks. Neither the manufacturer, the retailer, nor the person who sold you the bike, nor the people who maintain the trails are responsible for these risks. As you are solely responsible, it is, therefore, essential that you read and fully understand all the parts contained in this manual.

To enjoy maximum safety and enjoyment right from the get go, it is important that you are familiar with your new bike, its handling and its possibilities. It is your duty to maintain your bike well and reduce the risk of injury. Biking can be a dangerous activity, even under the best conditions. These are risks associated with using a bicycle that cannot be predicted or avoided. These are the sole responsibility of the cyclist.

YOUR AUTHORIZED DEVINCI RETAILER

Your authorized Devinci retailer is at your service to guide your choices of bike and accessories which are best suited to the style of biking you wish to perform. This will help you maintain your equipment in good condition so that you can take full advantage of your investment. The staff at your authorized Devinci retailer have the training, experience and tools to carry out the repairs and provide you with reliable advice.

However, your authorized Devinci retailer cannot make decisions for you, and cannot be held responsible for your lack of knowledge, experience, qualification or common sense. However, it will take the necessary time to explain the operation of a component or to help you choose an accessory that meets your specific needs.

For further information, please see the Devinci's User Manual available on www.devinci.com and the Bosch user manual available on <https://www.bosch-ebike.com/en/help-center/manuals>, or you can ask your authorized Devinci retailer. He will take the time to answer any questions you may have and will advise you with great pleasure.

TABLE OF CONTENTS

FRAME: TECHNICAL SPECIFICATIONS

8

CABLE ROUTING

12

SERVICE KIT

28

DEVINCI'S RIDE IN PEACE WARRANTY

36



F R A M E

TECHNICAL SPECIFICATIONS

STEERING COLUMN DIMENSIONS		
1. UPPER (S.H.I.S)	ZS44	1-1/8" Zerostack
2. LOWER (S.H.I.S)	ZS56	1.5" Zerostack
CRANKSET		
3. STANDARD	Mid-Drive Motor	
ELECTRIC ASSIST BOSCH		
4. DRIVE UNIT COMPATIBLE	Bosch CX BES3	
5. BATTERY MOUNT COMPATIBLE	Bosch BES3	
6. BATTERIES COMPATIBLE	Bosch BES3 625	
7. SPEED SENSOR TYPE	Slim	
8. DRIVE UNIT COVER	MACV24007	
SEAT TUBE AND SEAT CLAMP		
9. SEAT POST OUTSIDE DIAMETER (OD)	31.6 mm	
10. SEAT TUBE OUTSIDE DIAMETER (OD)	34.9 mm	
11. DROPPER POST COMPATIBLE	Oui Entièrement interne	
BRAKES		
12. BRAKE MOUNT (FRAME)	Montage sur support 200 mm direct	
13. MAX ROTOR SIZE COMPATIBLE (FRAME)	220 mm	
ACCESSOIRES		
14. PROTECTORS	OUI	
COMPATIBILITY INFO (BASED ON SIZE MEDIUM)		
E-TROY FORK 160 MM TRAVEL 150MM		
15. FRONT SUSPENSION TRAVEL & SAG	160 mm	30%
16. FORK AXLE-TO-CROWN & OFFSET	571	44
17. FRONT & REAR WHEEL GEOMETRY	750	720
18. FRONT & REAR WHEEL MAX ETRTO	66-622	66-584

*DISCLAIMER: We are testing many different tires to establish a clearance number that cover a wide spectrum of tires with appropriate frame clearance. However, it is impossible for us to test all tires and rim combination available on the market, so be mindful that some combinations may result in slight rubbing if higher than 66mm in actual width.

SIZES AVAILABLE
S | M | L | XL





C A B L E R O U T I N G

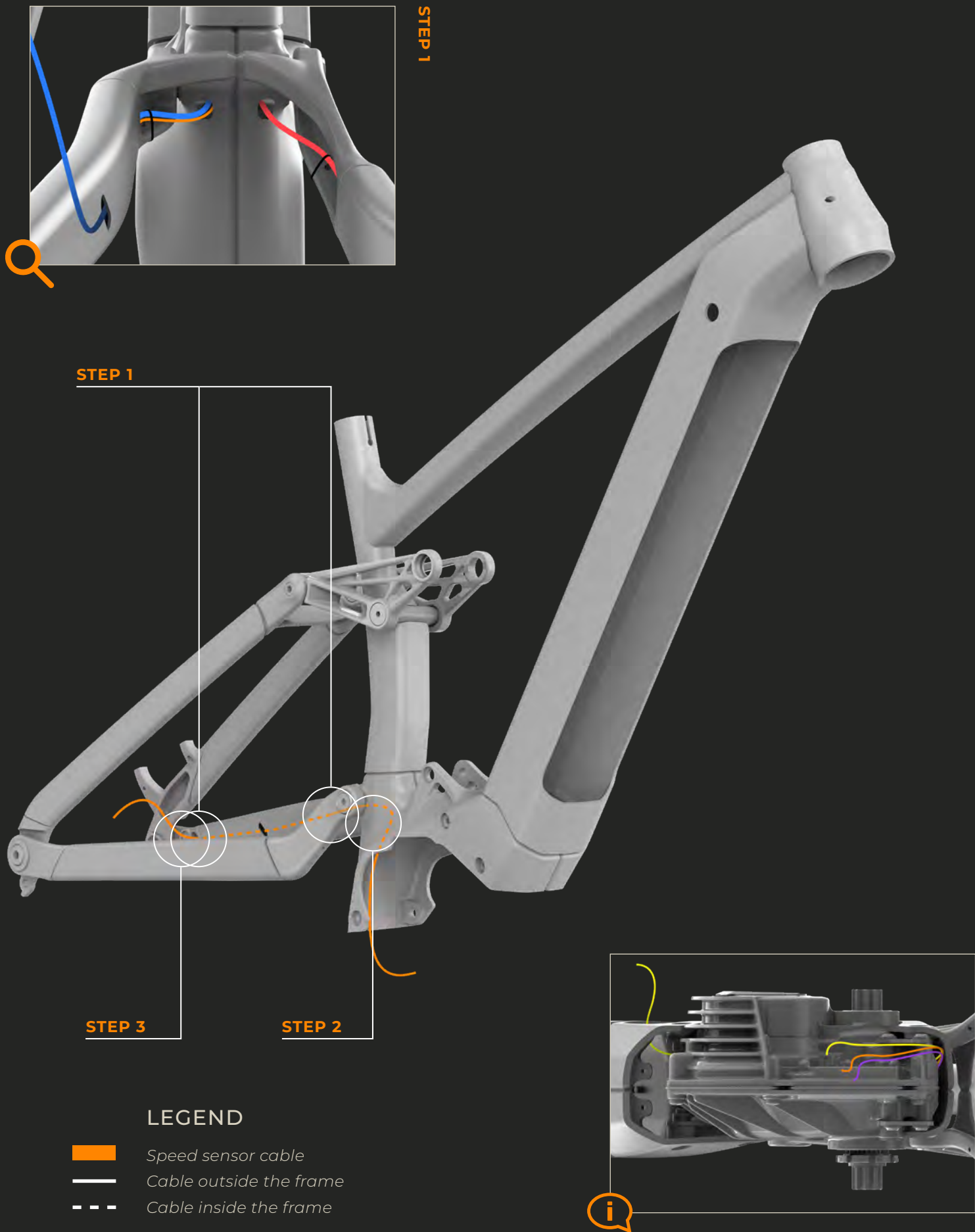

CABLE ROUTING

SPEED SENSOR CABLE

- STEP 1** | Insert the speed sensor cable into the cavity located on the left inner side of the base, at the back of the bike. Pass the cable through the base until it regresses through the cavity at the front.
- STEP 2** | Insert the cable into the motor shell through the left cavity located at the bottom of the seat tube.
- STEP 3** | Fixez le câble à l'orée de la cavité d'entrée à l'aide du support et de la vis prévus à cet effet.



Make sure that the cables intended to be connected to the motor do not interfere with its insertion into the shell by storing them against the upper wall.

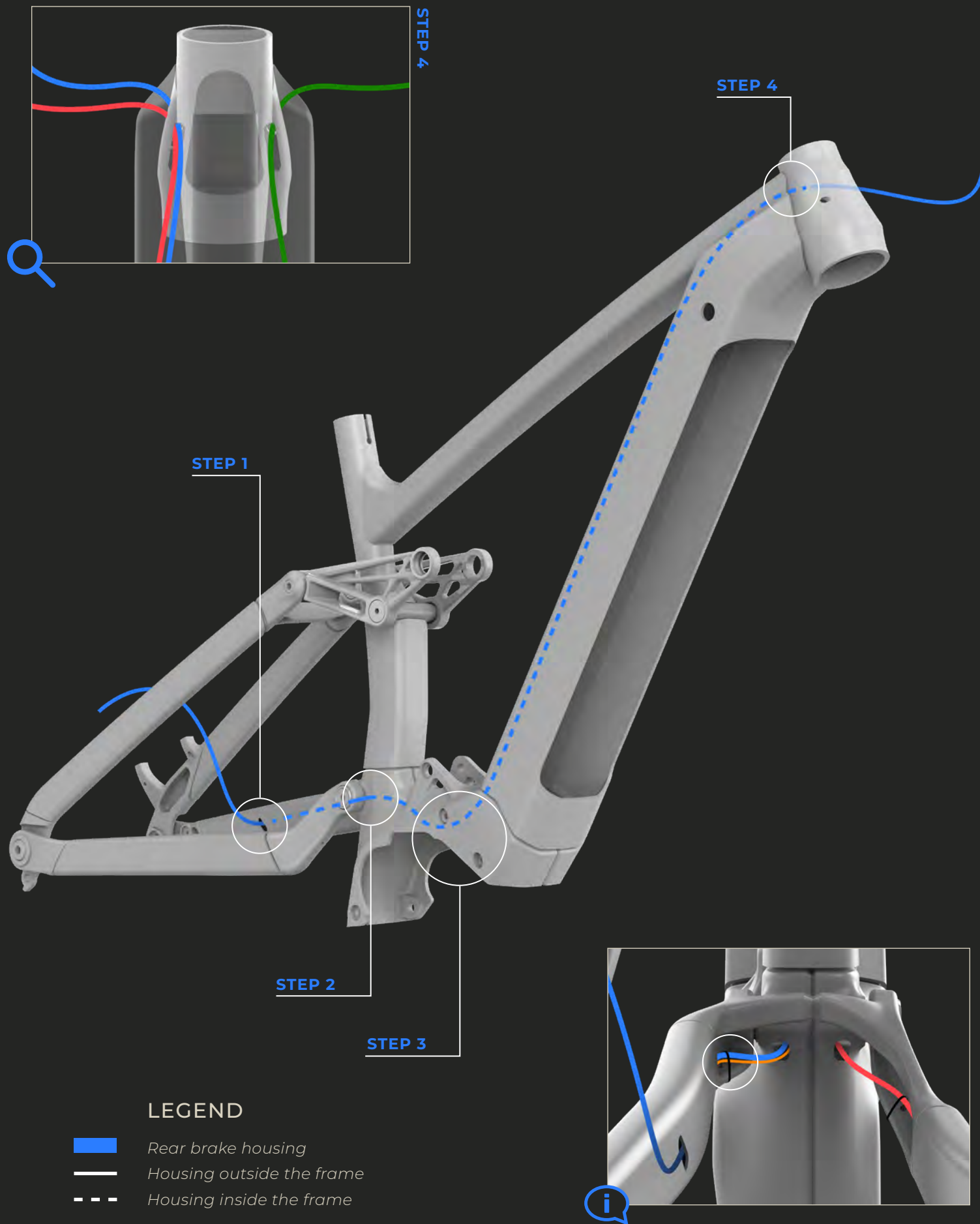

CABLE ROUTING

REAR BRAKE HOUSING

- STEP 1** | Make sure the stopper is in place on the inner center cavity of the base, then insert the rear brake housing through the stopper and feed it through the chainstay. Pull it out from the cavity in the located at the front of the chainstay.
- STEP 2** | Insert the rear brake housing into the motor shell through the left cavity located at the bottom of the seat tube.
- STEP 3** | Slide the rear brake housing through the left side of the down tube up to the steering column.
- STEP 4** | Insert the rear brake housing into the left inner oval cavity of the steering column, then pull the housing out through the upper left stop of the steering column.



Fix the rear brake housing and the speed sensor cable to the base in the place provided for this purpose using small zip ties.

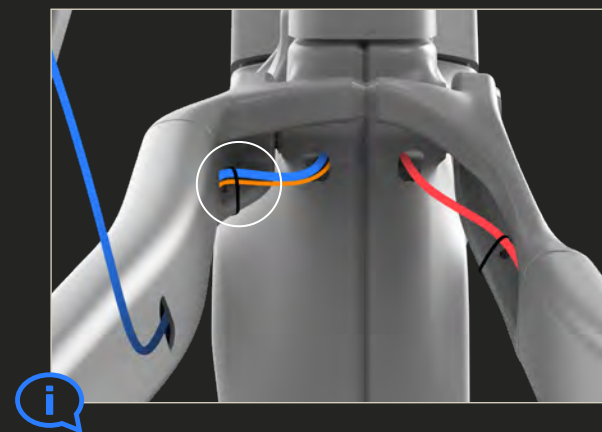

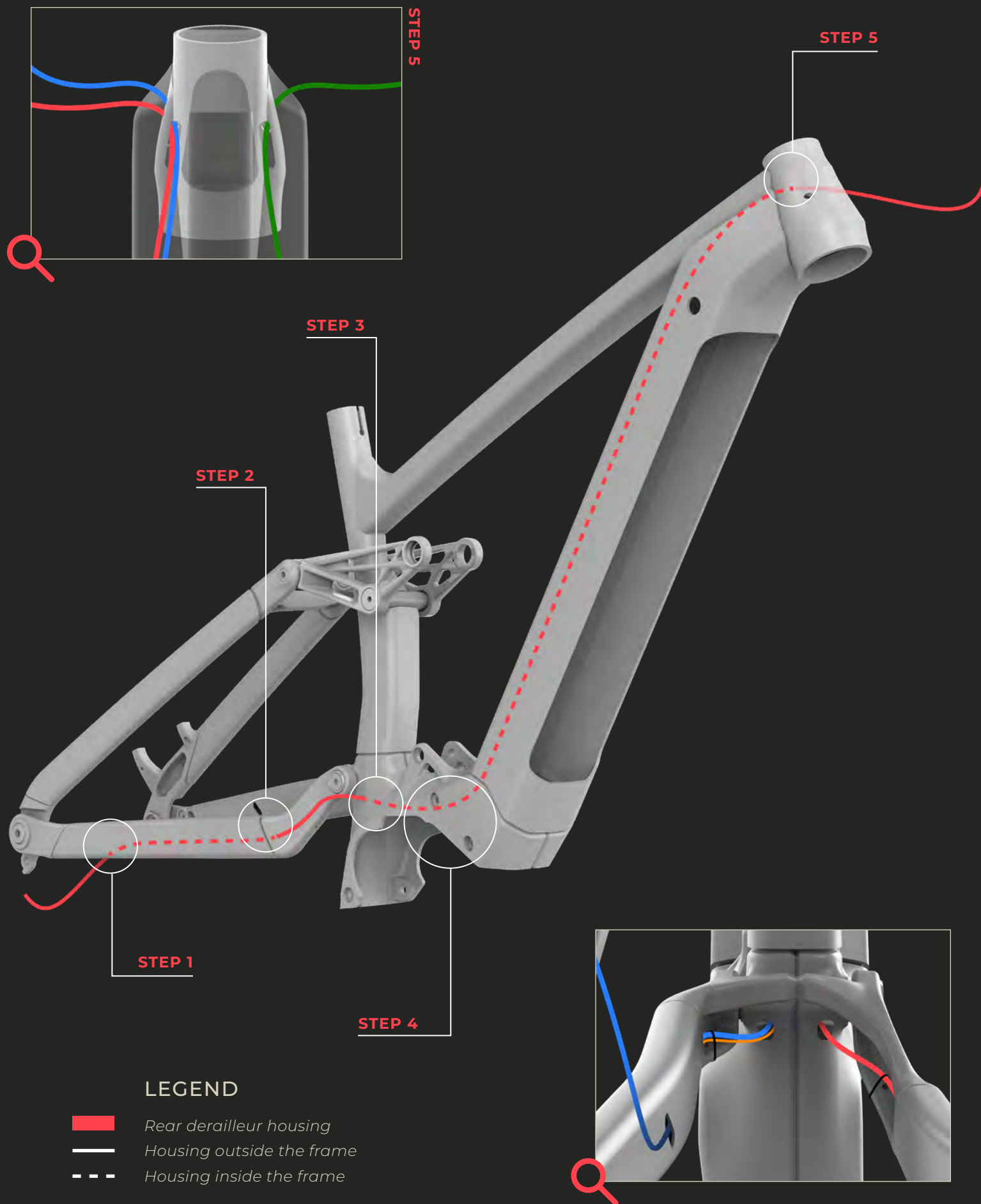

PASSAGE DE GAINES

REAR DERAILLEUR HOUSING



Tip → Slightly bend the tip of the housing to facilitate its insertion into the base.

STEP 1 | Make sure the stopper is in place on the cavity located under the right side of the bas, then insert the rear speed housing through the stopper.

STEP 2 | Thread the housing through the base and pull it out through the cavity at the front.

STEP 3 | Insert the housing into the motor shell through the cavity located in the lower right side of the seat tube.

STEP 4 | Slide the rear derailleur housing through the left side of the down tube up to the steering column.

→ For the E-Troy Led Controller model, slide an anti-impact foam on the housing down to the down tube before inserting the housing into the steering column.



Make sure that the housing and the cables inserted previously in the down tube do not cross each other.

STEP 5 | Insert the rear speed housing into the left inner oval cavity of the steering column, then pull the housing out through the lower left stop.



Fix the rear speed housing to the base in the place provided for this purpose using small zip ties.

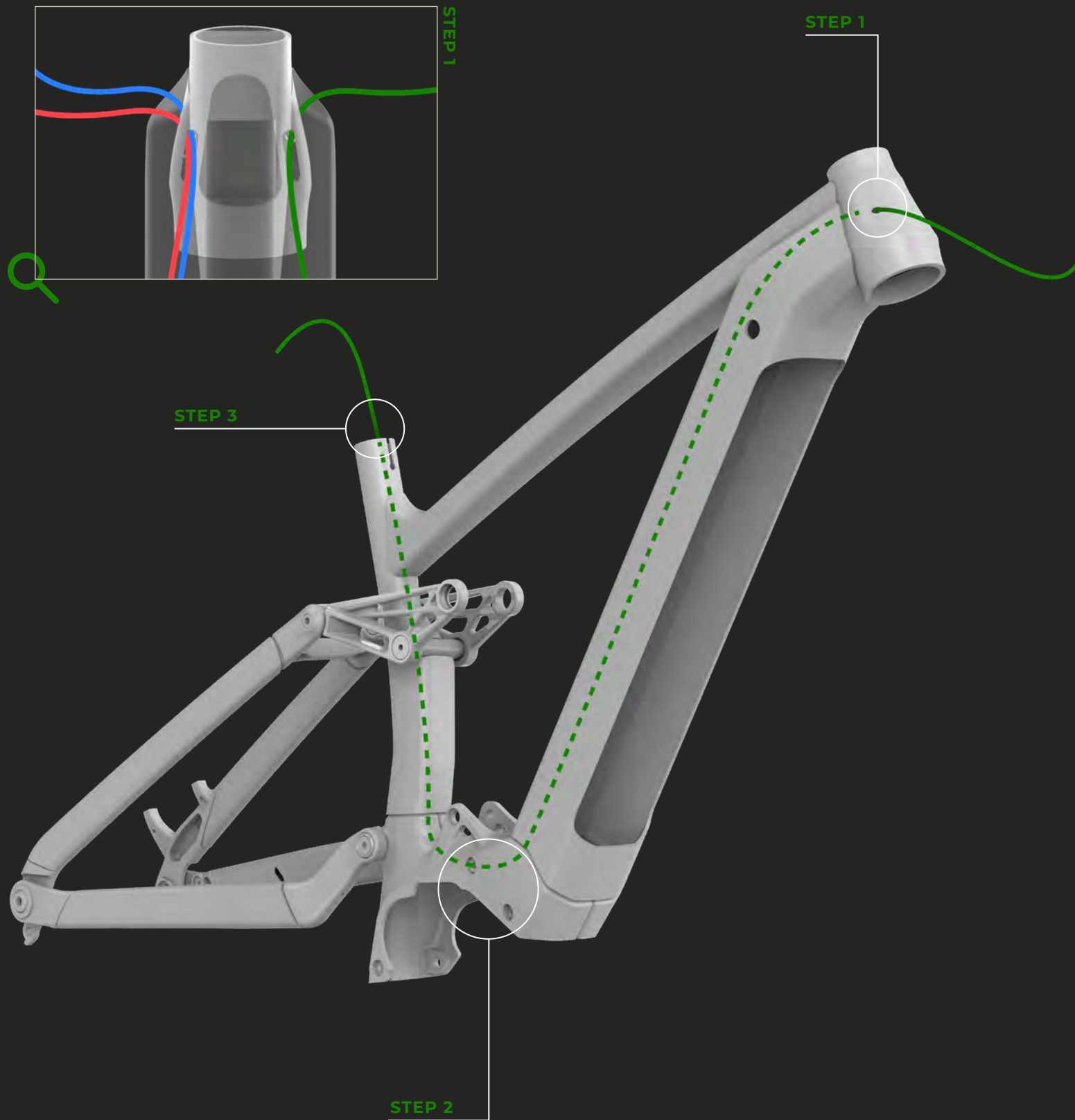

CABLE ROUTING

SEAT POST HOUSING

STEP 1 | Insert the seat post housing into the stopper located on the right side of the steering column. Insert the housing in the down tube through the oval opening located on the inside right side of the steering column.

STEP 2 | Slide the seat post housing to the right of the down tube down to the motor shell.

STEP 3 | Insert the seat post housing up to the upper end of the seat tube.

i Tighten the seat post housing as much as possible so that it takes up as little space as possible in the motor shell and that it does not interfere with the insertion of the motor later.

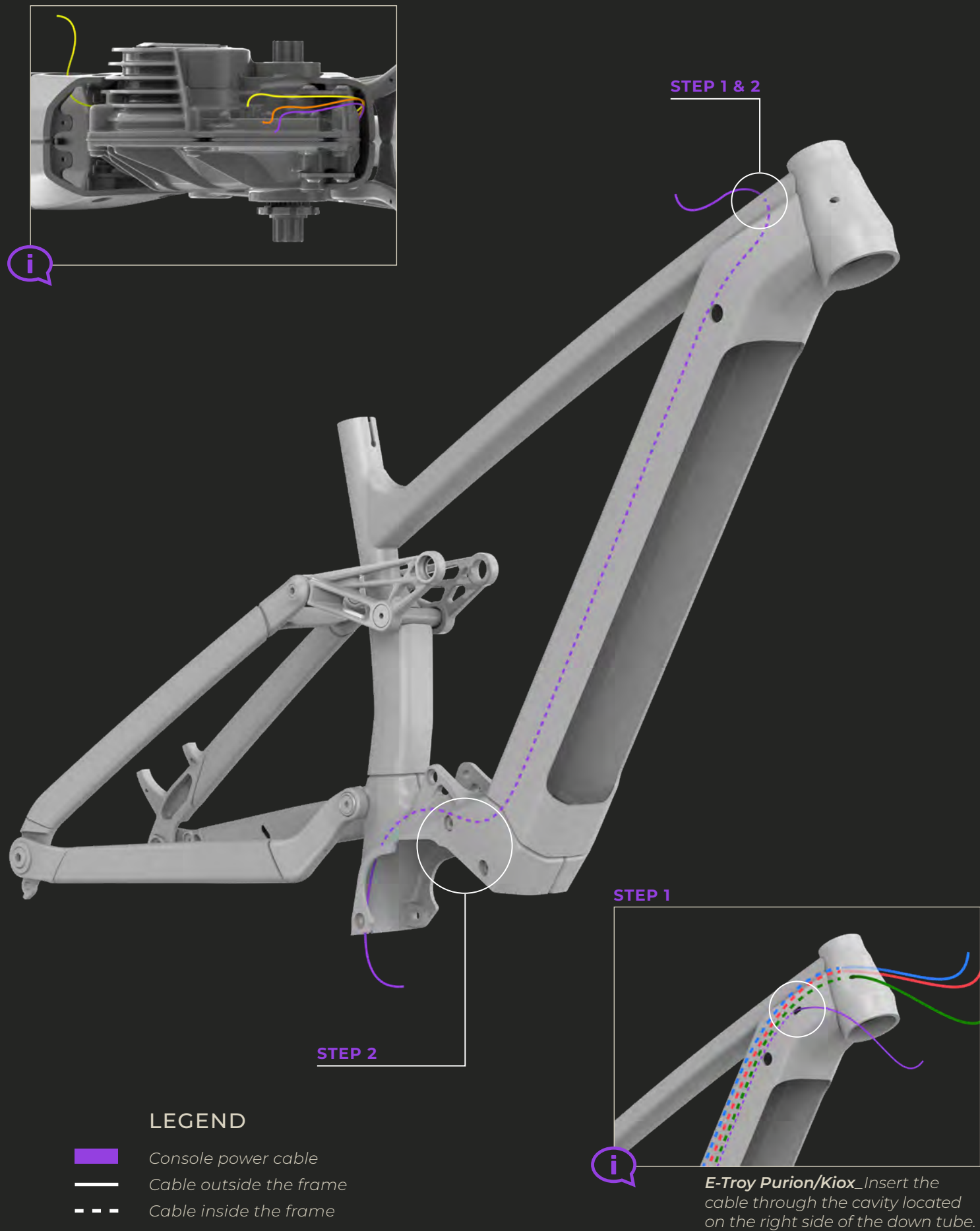

CABLE ROUTING

CONSOLE POWER CABLE

ÉTAPE 1 | *E-Troy Led controller* → Insert the cable through the cavity located on the top of the top tube.
E-Troy Purion/Kiox → Insert the cable through the cavity located at the top of the right side of the down tube.

ÉTAPE 2 | *E-Troy Led controller* → Slide the electric cable from the right side of the down tube up to the motor shell.
E-Troy Purion/Kiox → Slide the electric cable from the left side of the down tube up to the motor shell.

ÉTAPE 3 | *E-Troy Led controller* → Install the stopper on the upper part of the cable until it fits into the cavity located on the right side of the down tube.
E-Troy Purion/Kiox → Fit the console in the cavity located on the top tube.

i Make sure that the cables intended to be connected to the motor do not interfere with its insertion into the shell by storing them against the upper wall.

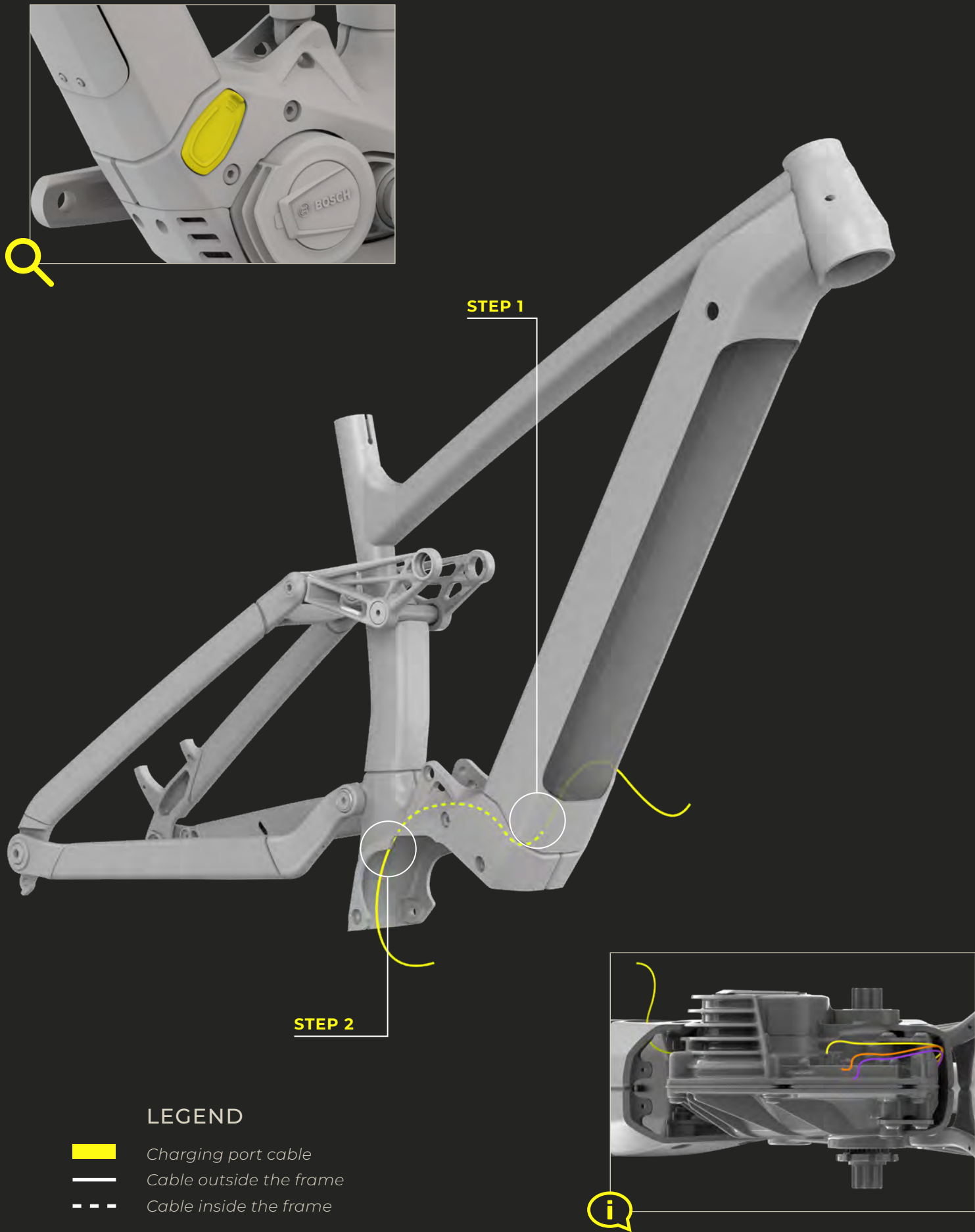

LEGEND

- Charging port cable
- Cable outside the frame
- Cable inside the frame

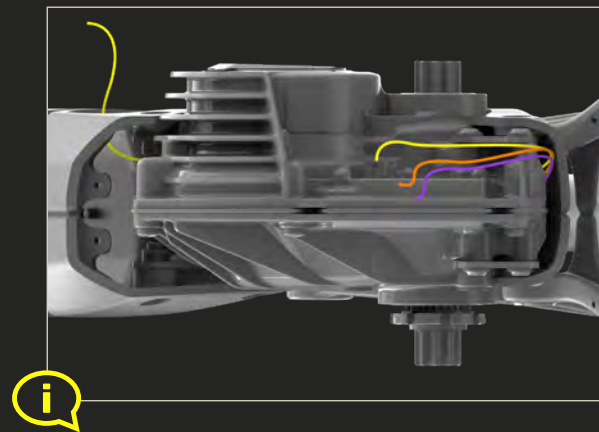

CABLE ROUTING

CHARGING PORT CABLE

- STEP 1** | Position the charging port cable connector in its base located at the bottom of the down tube. Secure it using the screws provided.
- STEP 2** | Route the rest of the charging port cable up to the motor shell.

i Make sure that the cables intended to be connected to the motor do not interfere with its insertion into the shell by storing them against the upper wall.

CABLE ROUTING OVERVIEW

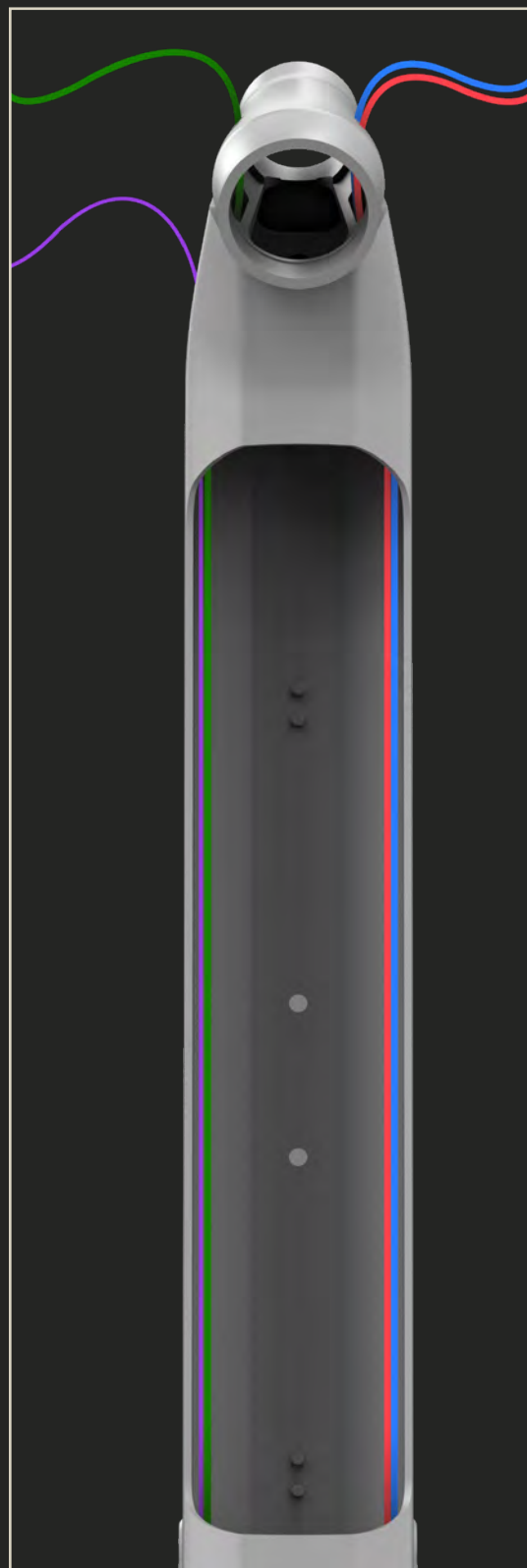

E-Troy Purion/Kiox

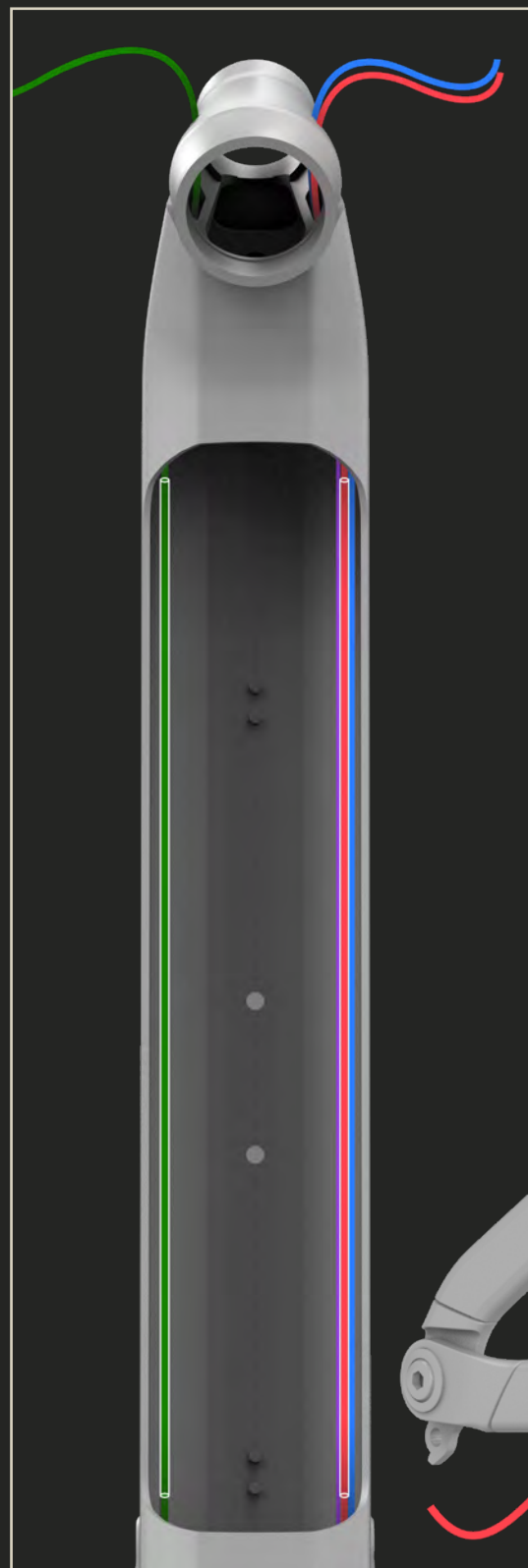

E-Troy Led Controller*

LEGEND

- Rear brake housing
- Rear derailleur housing
- Seat post housing
- Charging port cable
- Console power cable
- Speed sensor cable
- Cable/housing outside the frame
- - - Cable/housing inside the frame
- Anti-impact foam*

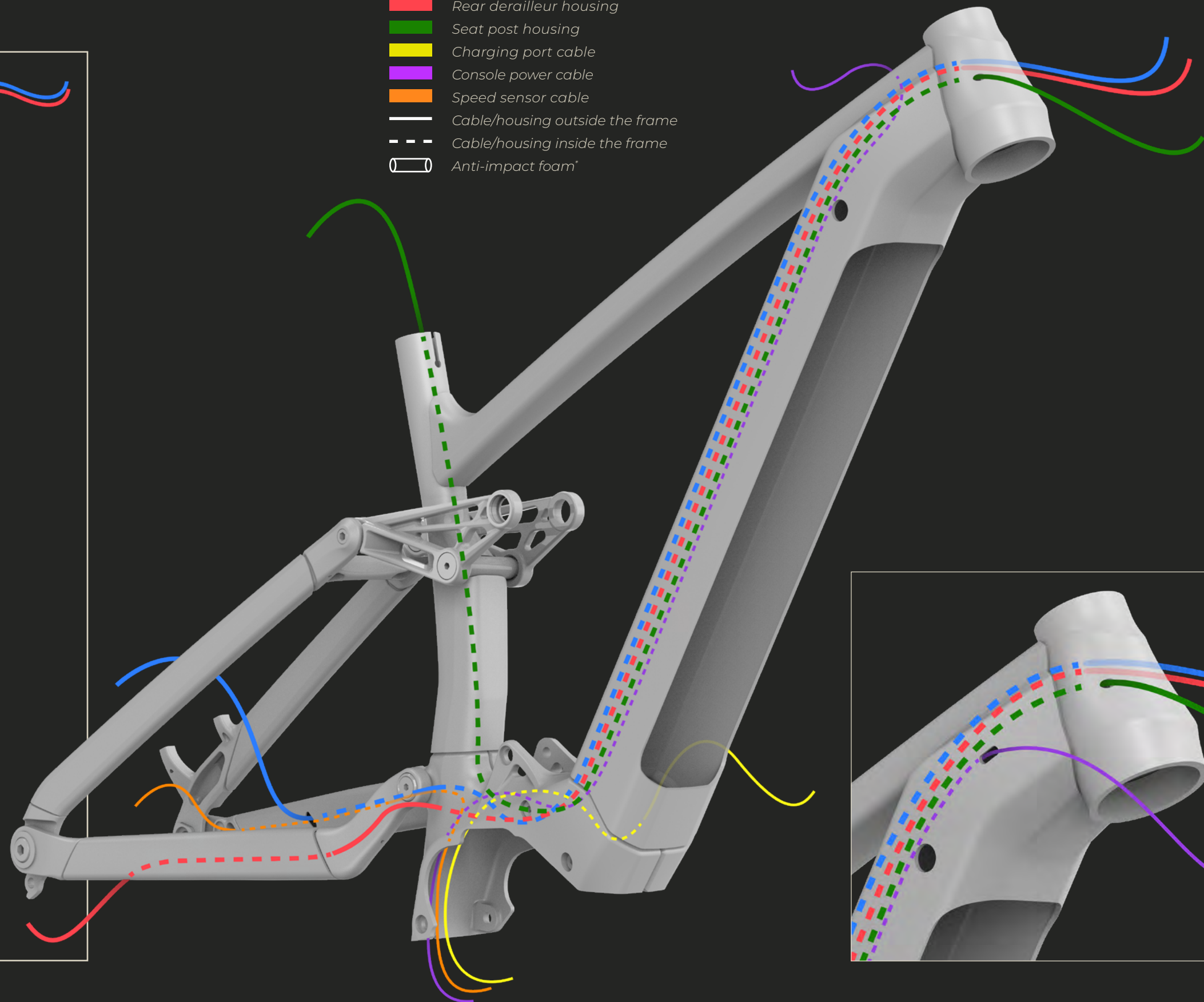



SERVICE KIT

KFC08902 E-TROY BOSCH 2023+			
ITEMS	PART #	DESCRIPTION	QTY
1	MFP21016	BALL BEARING MR20307 20x30x7; STD TYPE, DOUBLE LIP	2
2	MFP24014	BEARING 6900 WITH EXTENDED INNER CAGE	2
3	MFP19001	BALL BEARING 3801 LLU MAX 12x21x8	6

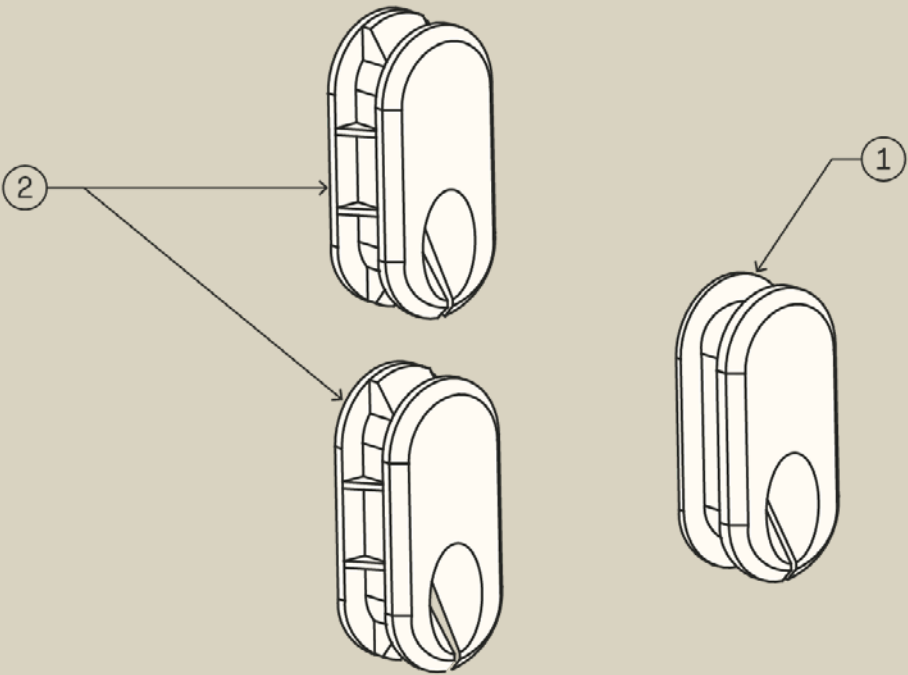
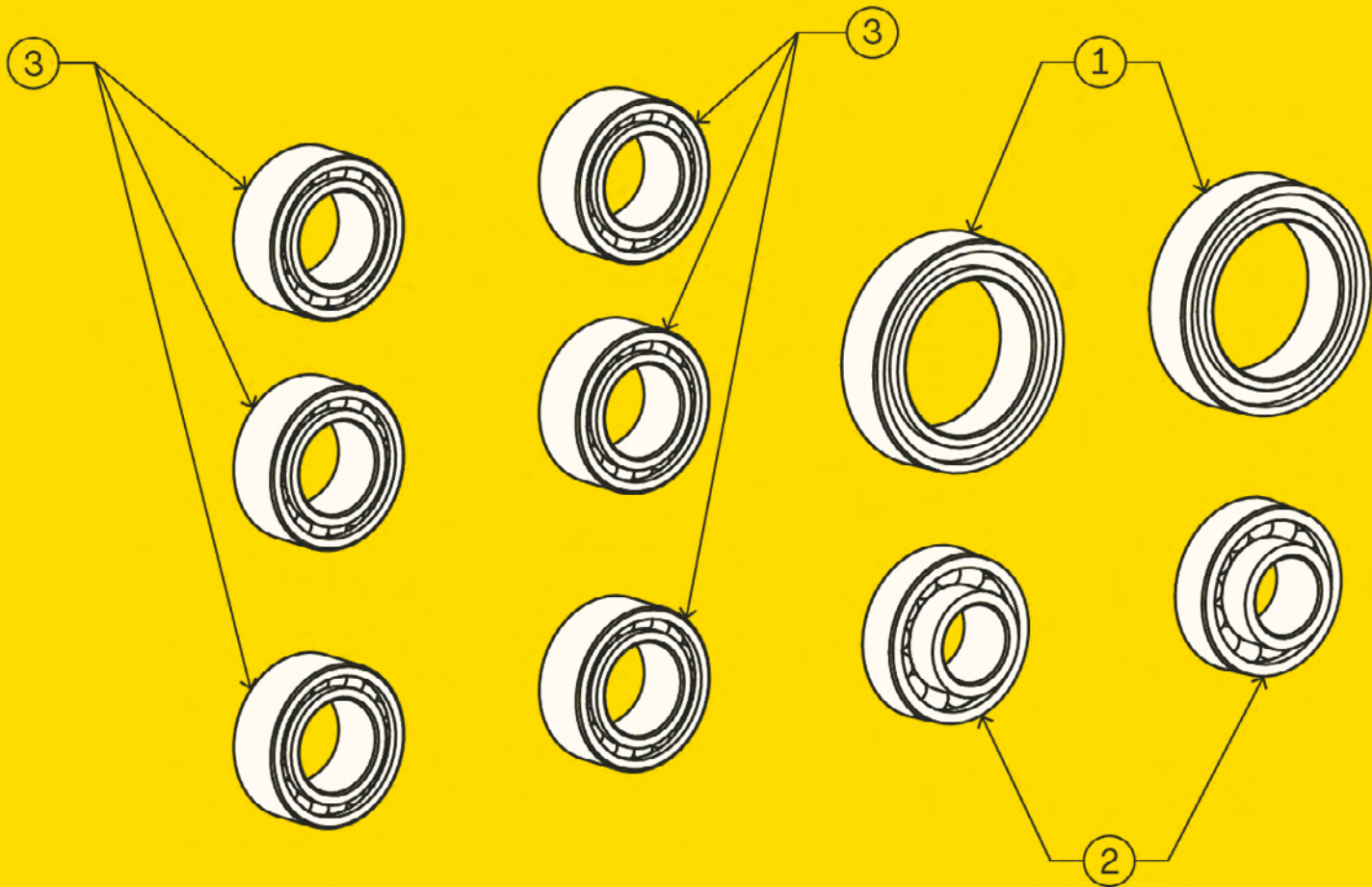

KFC08909 E-TROY BOSCH 2023+			
ITEMS	PART #	DESCRIPTION	QTY
1	MFB24001	CABLE GUIDE 5mm	1
2	MFB19008	CABLE GUIDE 5mm	2

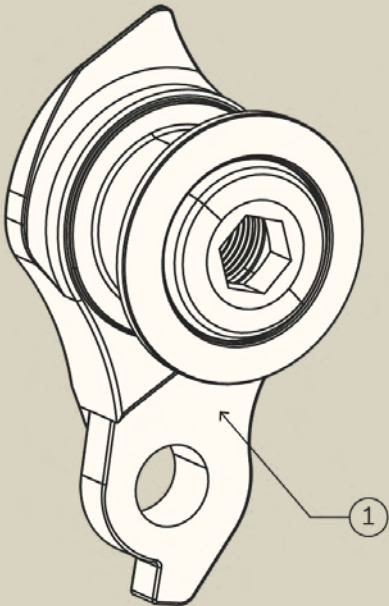

KFC05602 E-TROY BOSCH 2023+			
ITEMS	PART #	DESCRIPTION	QTY
1	KFC05602	Derailleur Hanger UDH	

KFC08903 E-TROY BOSCH 2023+			
ITEMS	PART #	DESCRIPTION	QTY
1	MFP24012	CS PIVOT SPACER E-MTB	2
2	MFV24016	PIVOT SCREW M12 x 1.0 x 21mm	2
3	MFP24010	LINKAGE PIVOT SHAFT E-MTB SL	2
4	MFV24012	SOCKET FLAT SCREW M8x1.25 X 20mm	2
5	MFV24008	PIVOT WASHER	2
6	MFP24009	PIVOT NUT FOR MR 20307 BEARING	1
7	MFP24008	DROPOUT PIVOT LEFT SHAFT 20mm	1

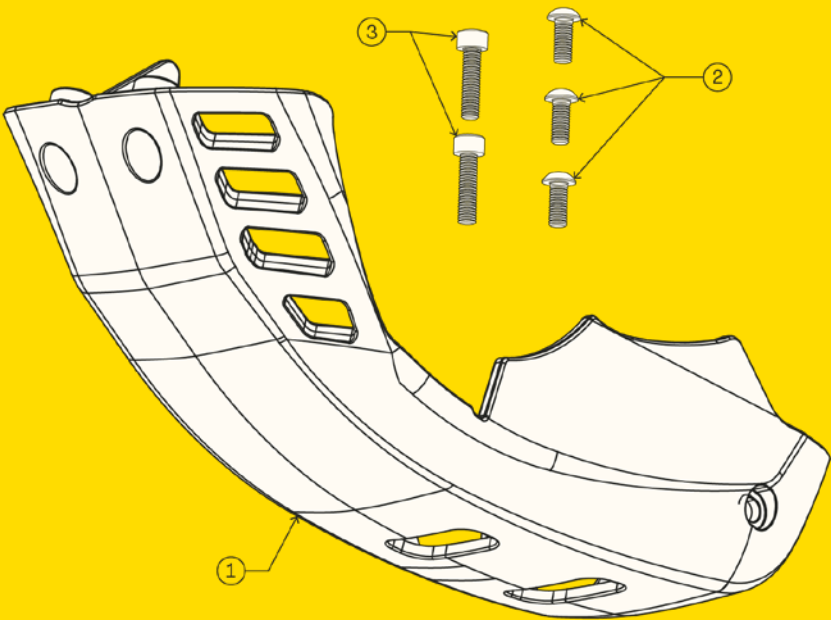
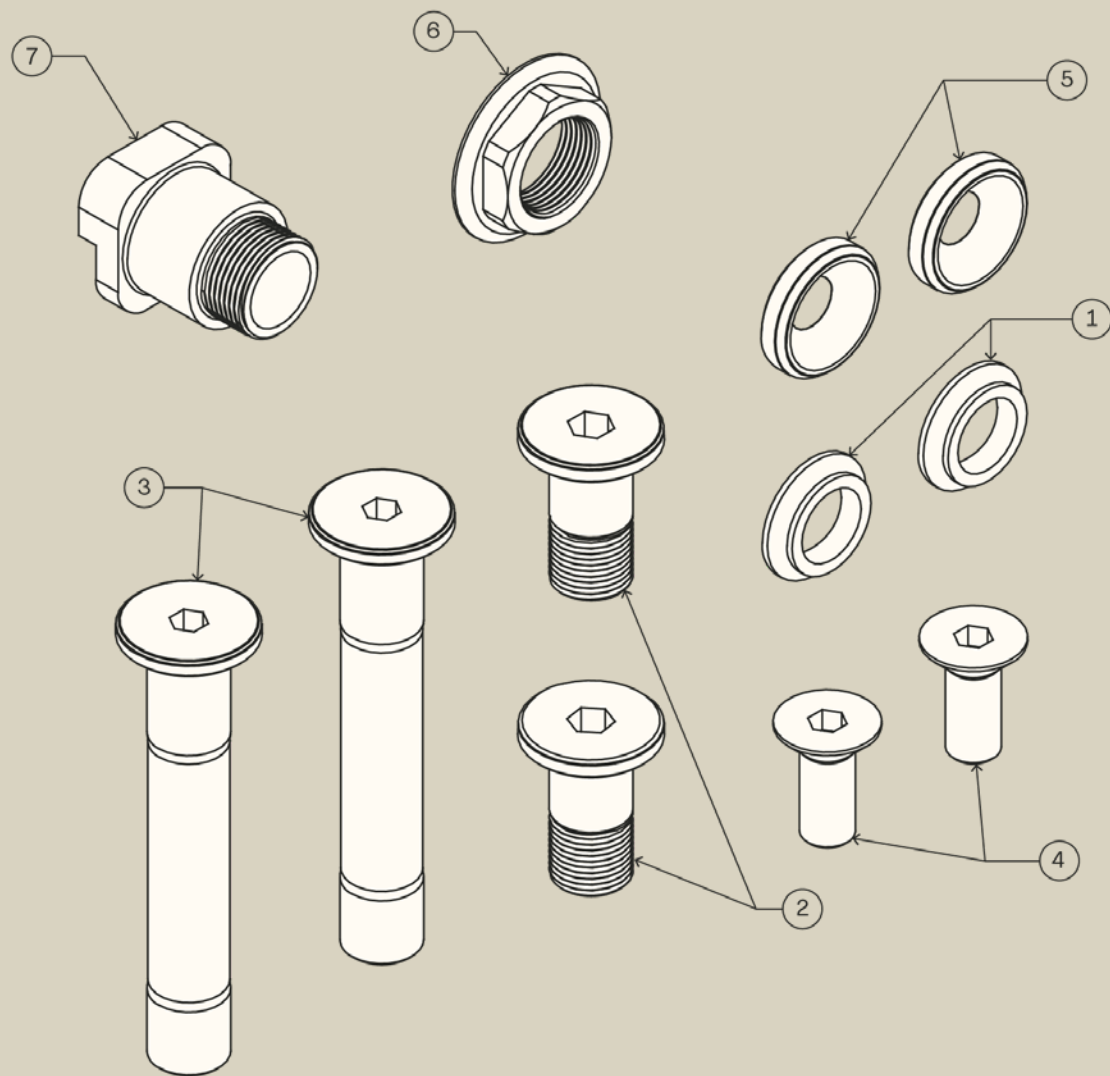

KFC08905 E-TROY BOSCH 2023+			
ITEMS	PART #	DESCRIPTION	QTY
1	MACV24007	MOTOR PROTECTION COVER BOSCH CX	1
2	MFV00165-01	SOCKET BUTTON SCREW M4x0.7 X 10mm	3
3	B18.3.1M - 4 x 0.7 x 16 Hex SHCS - 16SHX	Socket cap screw M4X0.7X16mm	2

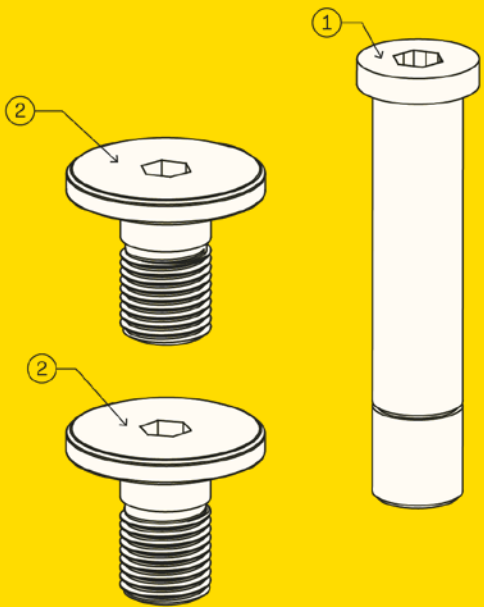

KFC08901 E-TROY BOSCH 2023+			
ITEMS	PART #	DESCRIPTION	QTY
1	MFV21002	SOCKET CAP SCREW M10 x 1.0 x 48mm	1
2	MFV24009 (Default)	UPPER SHOCK SCREW E-MTB SL	2

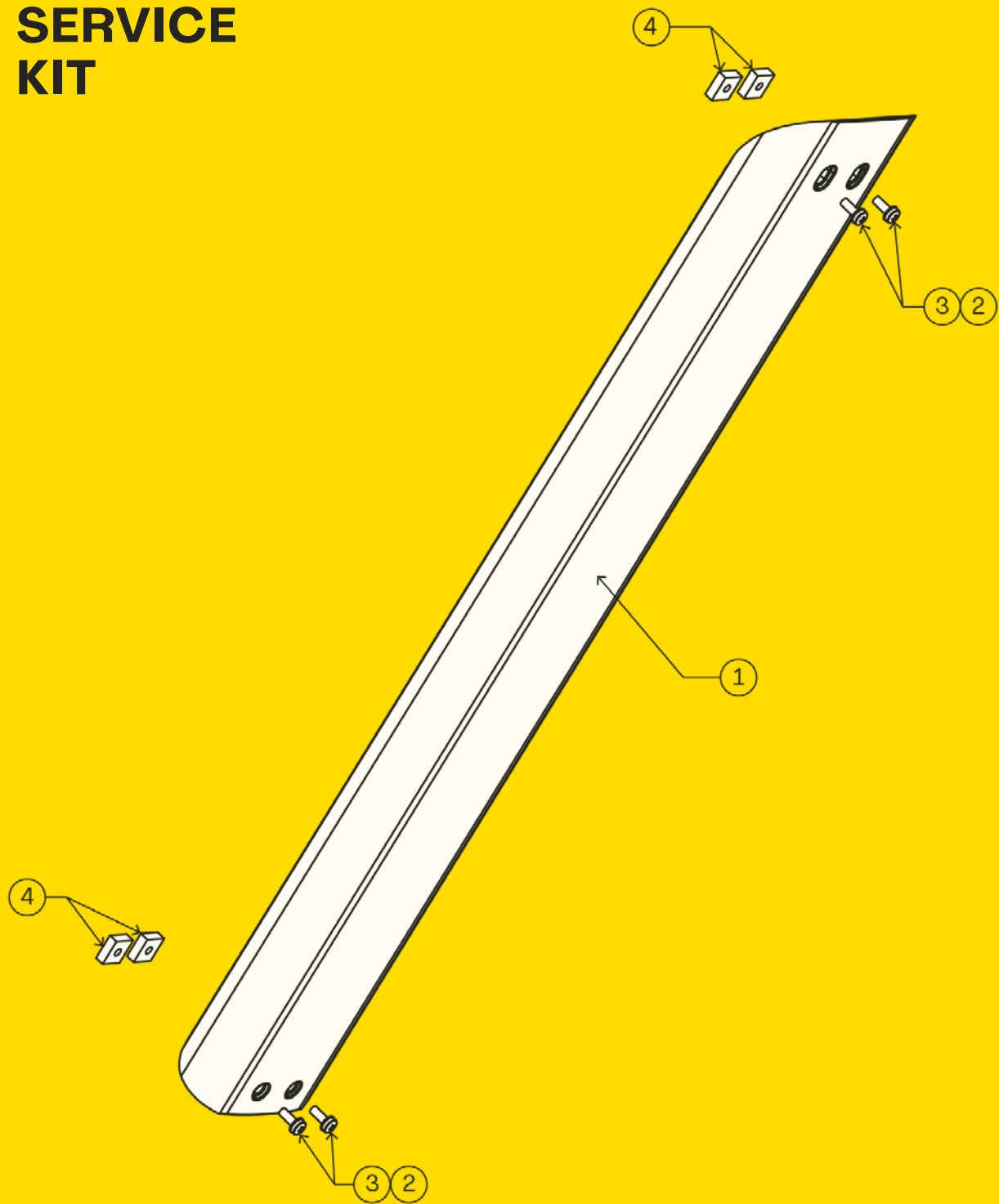

KFC08907 E-TROY BOSCH 2023+			
ITEMS	PART #	DESCRIPTION	QTY
1	MACV24008	BATTERY COVER BOSCH 625	1
2	MFV23010	FLAT WASHER M3, ID3.2mm, OD6mm, SS	4
3	MFV24048	PAN HEAD PHILLIPS SCREW M3x0.5 X 8mm	4
4	MFV24049	THIN SQUARE NUT M3	4

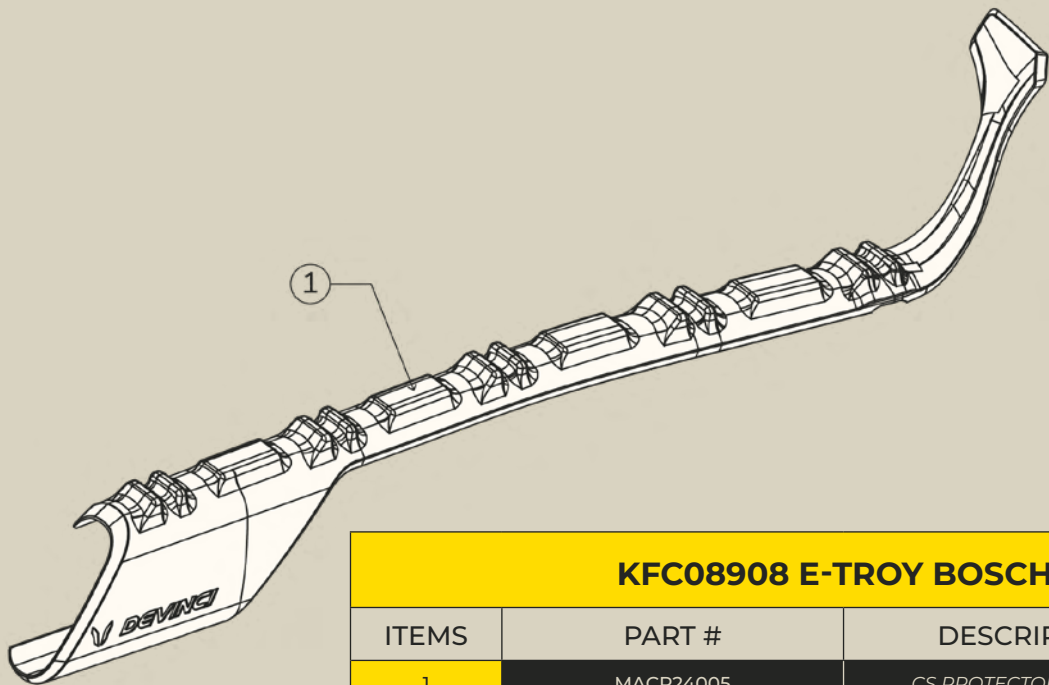

KFC08908 E-TROY BOSCH 2023+			
ITEMS	PART #	DESCRIPTION	QTY
1	MACP24005	CS PROTECTOR 072-9800	1

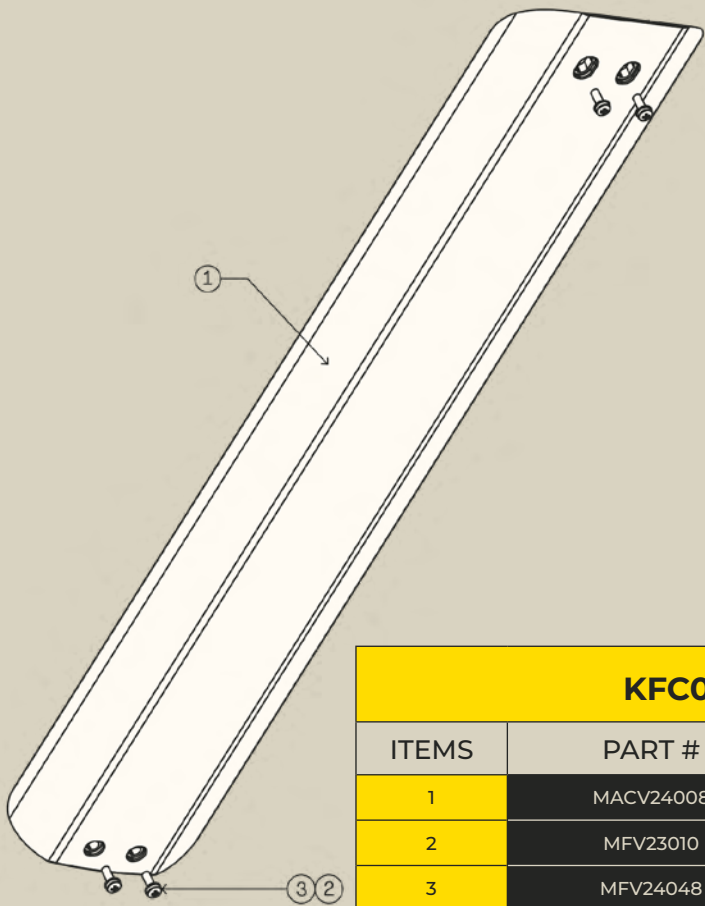

KFC08906 E-TROY BOSCH 2023+			
ITEMS	PART #	DESCRIPTION	QTY
1	MACV24008	BATTERY COVER BOSCH 625	1
2	MFV23010	FLAT WASHER M3, ID3.2mm, OD6mm, SS	4
3	MFV24048	PAN HEAD PHILLIPS SCREW M3x0.5 X 8mm	4

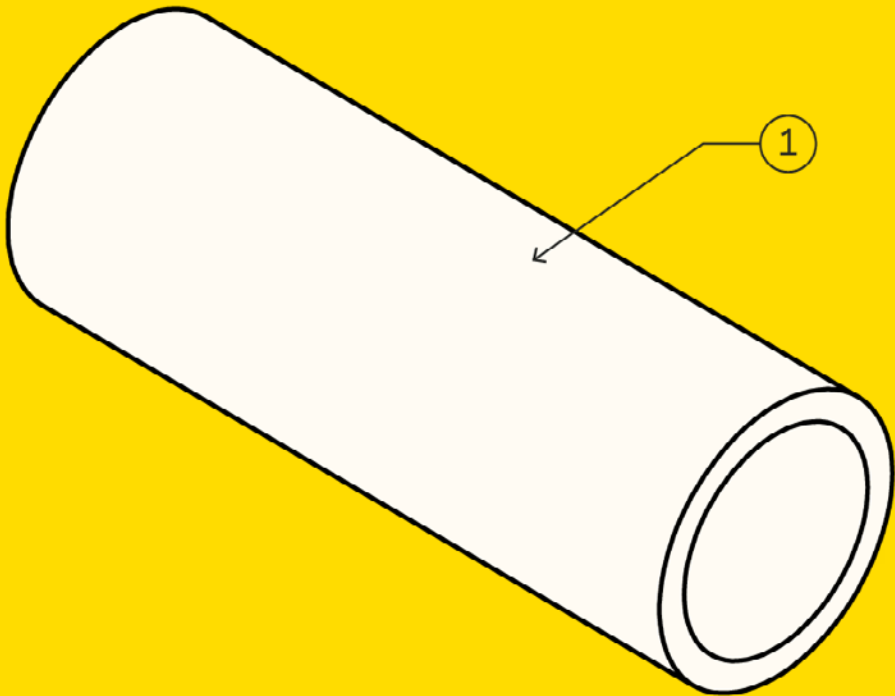

KFC09602 E-TROY BOSCH 2023+			
ITEMS	PART #	DESCRIPTION	QTY
1	MASU25099	SHOCK HARDWARE AJUSTABLE	1

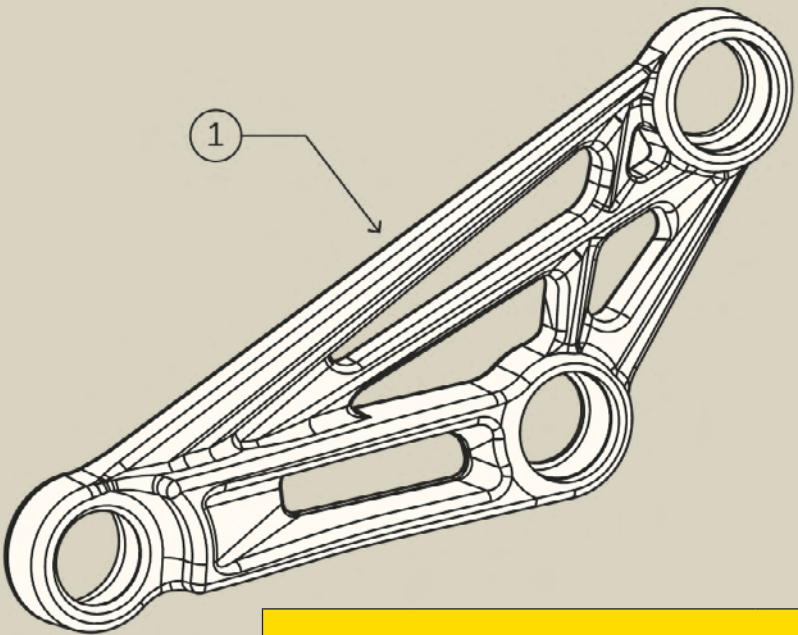

KFC08911 E-TROY BOSCH 2023+			
ITEMS	PART #	DESCRIPTION	QTY
1	MFL24003	089-096 RIGHT LINKAGE	1

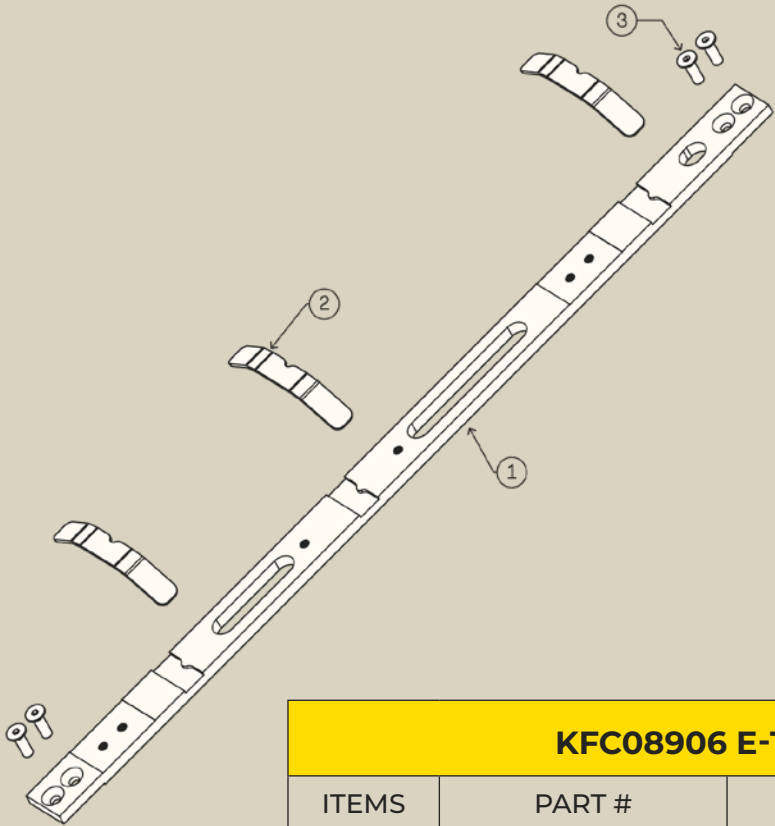

KFC08906 E-TROY BOSCH 2023+			
ITEMS	PART #	DESCRIPTION	QTY
1	MACV24008	BATTERY COVER BOSCH 625	1
2	MFV23010	FLAT WASHER M3, ID3.2mm,OD6mm, SS	4
3	MFV24048	PAN HEAD PHILLIPS SCREW M3x0.5 X 8mm	4



WARRANTY

WARRANTY PERIOD FROM DEVINCI CYCLES INC

The frames of cycles devinci inc. are guaranteed against all manufacturing defects, for the periods specified below, as of the date of the initial purchase. During these specific periods, devinci will replace or repair without charge, and at its discretion, the devinci frames that display a manufacturing defect. The parts replaced or repaired in accordance with this warranty, will be covered for a period equal to the remaining portion of the warranty of the original equipment. Replacement parts are subject to availability. In certain cases, color and/or model may differ from the original parts.

BICYCLE FRAMES & WARRANTY PERIOD

Since 2006, all the frames bike model, including all mountain, freeride, downhill frames and dirt jump are guaranteed for life. Paint and decals for all models of frame:

- 1 year the pivots* for double suspension frames;
 - 1 year the components assembled on devinci frames are guaranteed by their respective manufacturers.
- Please contact your authorized devinci retailer. For more information regarding the applicable warranties.

*The pivots include the bearings, bolts and axles holding together the elements of the suspension of the rear triangle.

WARRANTY EXCLUSIONS

Each devinci bicycle was conceived for a specific use. The operational life of a bicycle varies according to its construction, maintenance and the care provided. Intensive use or use with a heavy load, use during competitions or for activities other than those for which the bicycle was conceived, greatly diminish its operational life. Any of these conditions may lead to random failure. Abusive use will therefore cancel the warranty.

EXCHANGE POLICY IN CASE OF ACCIDENT

Devinci is aware that the purchase of a high performance bicycle is done with the heart. This is why our customer service applies an exchange policy at a low price to accommodate claims that would have been refused for one of the reasons mentioned in the section “warranty exclusions”. This policy applies only to the initial buyer. Please contact your devinci retailer for more information.

Limitation of liability: this is an integral warranty, complete and final, for devinci frames. Devinci does not give authorization to any other person, including the authorized devinci retailers, to assume or grant, expressly or implicitly, any or all addition(s) or extension(s) to the warranty specified herein. Any other obligation or responsibility expressed by any other person(s) and any demonstration or illustration of devinci frames is in no way linked to devinci and is furthermore excluded from this warranty.

Devinci assumes no liability in case of any property damage, moral or bodily injury to the user, the buyer or any other person(s), resulting from the use of a devinci frame or one of its components.

Except as limited or expressly forbidden by law, regarding any other condition or guarantee, express or implied, based in law, established commercial customs and usage, including, but not limited to, guarantee of merchantability or adaptation to a specific end, devinci declines any responsibility for any amount exceeding the actual purchase price of the bicycle nor for any particular, accessory or consecutive damages that may occur in connection with said bicycle.

With regard to the exercising of rights resulting from the present warranty, the buyer of a devinci frame agrees to elect domicile in the judicial district of chicoutimi, in the province of quebec, canada, as an appropriate place for the hearing of all claims or legal proceedings.



THIS WARRANTY DOES NOT COVER :

- Regular maintenance (cleaning, lubrication or inspection);
- TranOptimum S or shipping charges incurred as a result of the execution of the warranty;
- Cost of labour related to the assembly, disassembly, repair or replacement parts;
- Damages caused by normal wear and tear including damages caused by material fatigue.

THIS WARRANTY DOES NOT APPLY IF :

- The damages were caused by a fortuitous event;
- The bicycle was purchased from a retailer other than those authorized by devinci;
- The bicycle was not entirely assembled by an authorized devinci retailer;
- The bicycle was repaired by a person other than an authorized devinci retailer;
- You are not the original owner of the bicycle;
- The instructions contained in the user’s manual for all frames and the technical manual for frames with double suspension were not respected;
- The periodic inspection recommended in the user’s manual for all frames and in the technical manual for the frames with double suspension was not carried out;
- Parts not supplied by devinci with the bicycle or not indicated in the user’s manual for all frames or the technical manual for the frames with double suspension were used;
- The bike paint is damaged as a result of an adhesive frame protector installation;
- The bicycle was used for an activity other than those for which it was conceived;
- The bicycle and/or its components were subject to abusive use, negligence, abnormal and/or excessive use or was implicated in an accident;
- The frame is too small for you;
- The frame and/or its components were modified (ex: polishing, structural or mechanical modification or addition, stripping, sanding, strain hardening, shot peening);
- You continued to use your bicycle while it was damaged.



Siège social

1555 Manic
Chicoutimi (Quebec) Canada
G7K 1G8

www.devinci.com