

WE MAKE RIDERS

CHICOUTIMI, QUÉBEC



TECHNICAL MANUAL

E-TROY LITE 2024+

DEVINCI



LET YOUR INNER RIDER RIDE FREE



PLEASE READ BEFORE USING YOUR BIKE

Even if you have already piloted a bike for years, it is important to be aware of the information contained in the User's Manual and the Specific Manual PAB (Power-Assisted Bike). Read them carefully before riding your E-Troy Lite:

- These documents contain important information.
- Understand the use, layout and maintenance of each electrical components of your new PAB.

Your safety and those of other is paramount:

- Never ride the bike without its battery; the battery must be on the bike when you head out, otherwise there will be no lights on the bike.
- Never ride the bike without a saddle; failure to comply with this rule could lead to accidents.
- Inspect your bike to make sure there are no loose screws or components or damages. In the event of a defect, visit your authorized Devinci retailer for a repair.
- A PAB is faster than a normal bike, risks of accident with other users on the road may occur.
- Ride under the conditions mentioned in the Owner's Manual.
- For PAB's that have a rear rack: the limit is 20 kg.

The electrical system requires careful handling:

- Do not clean the bike with a high-pressure jet. The system is sensitive to moisture. High-pressure water may seep into the connectors or other parts of the electrical system.
- Handle the battery carefully and pay attention to electric shocks. Failure to comply with this instruction could lead to abnormal heating or severe damage. In very rare cases, the consequences of an electrical shock could lead to a fire. In case of doubt, have the battery inspected by an authorized Devinci retailer.

Perform maintenance of the battery as mentioned in the Technical Manual.



NOTE → Failure to follow the instructions below may damage the battery and require you to purchase a new battery kit.

- Charge the bike with the Bosch charger only;
- It is not recommended to keep the battery connected to the charger for a long period;
- If the battery remains uncharged for a long time, it can lose a significant part of its effectiveness;
- Store the battery in a well-ventilated and dry place. Pay attention to moisture;
- Monitor the storage temperature and try to avoid discrepancies. For example, do not leave the battery in your car during summer or leave the battery outdoors during a storm in winter.

Factors that shorten the service life of your battery:

- Heavy-duty use
- Charging your battery at cold temperatures
- Storage at over 30°C ambient temperature
- Prolonged storage in a fully charged or fully discharged state
- Parking the eBike in direct sunlight
- Regular complete "discharge" of the battery

Factors that extend the service life of your battery:

- Low load
- Storage at a temperature between 10 and 20°C
- Storage at approximately 30 – 60 % charge status
- Parking the eBike in the shade or in a cool location

For further informations, visit the [Bosch website](#).

Follow the transport instructions for your PAB:

- Comply with local laws regarding transportation on the PAB;
- A PAB is heavier than a normal bike, so you must be careful when transporting it. Check that the maximum load of the rack, roof or bike rack used is respected. Refer to the support manual used;
- The Li-Ion battery of your PAB, due to its size, is considered a "Class 9 dangerous good" during transport. Applicable regulations could limit transport of a separate Li-Ion battery (when the battery is not on the bike) in some places. This regulation applies to several airlines and a number of road transport companies. On the other hand, if you are planning to move around with a full PAB (when the battery is on the bike), regulations are less strict. In case you use these transport methods, check the regulations that apply to your PAB with your transport company before booking.

Visit your authorized Devinci retailer for regular maintenance of your new PAB:

- Only your retailer has the know-how and the proper equipment to maintain your PAB.
- If you have any question about your PAB, please ask for assistance from your retailer.



ABOUT OUR MANUALS

Our user manuals meet ISO 4210-10TS, EN 15194 et EN 14766 standards.

Like many sports, cycling involves risk of injury and accidents, so you must be fully aware of these risks. Neither the manufacturer, the retailer, nor the person who sold you the bike, nor the people who maintain the trails are responsible for these risks. As you are solely responsible, it is, therefore, essential that you read and fully understand all the parts contained in this manual.

To enjoy maximum safety and enjoyment right from the get go, it is important that you are familiar with your new bike, its handling and its possibilities. It is your duty to maintain your bike well and reduce the risk of injury. Biking can be a dangerous activity, even under the best conditions. These are risks associated with using a bicycle that cannot be predicted or avoided. These are the sole responsibility of the cyclist.

YOUR AUTHORIZED DEVINCI RETAILER

Your authorized Devinci retailer is at your service to guide your choices of bike and accessories which are best suited to the style of biking you wish to perform. This will help you maintain your equipment in good condition so that you can take full advantage of your investment. The staff at your authorized Devinci retailer have the training, experience and tools to carry out the repairs and provide you with reliable advice.

However, your authorized Devinci retailer cannot make decisions for you, and cannot be held responsible for your lack of knowledge, experience, qualification or common sense. However, it will take the necessary time to explain the operation of a component or to help you choose an accessory that meets your specific needs.

For further information, please see the Devinci's User Manual available on www.devinci.com and the Bosch manuals available on <https://www.bosch-ebike.com/en/help-center>, or you can ask your authorized Devinci retailer. He will take the time to answer any questions you may have and will advise you with great pleasure.

TABLE OF CONTENTS

FRAME: TECHNICAL SPECIFICATIONS 8

CABLE ROUTING 12

SERVICE KIT 28

DEVINCI'S RIDE IN PEACE WARRANTY 38



F R A M E

TECHNICAL SPECIFICATIONS

***DISCLAIMER:** We are testing many different tires to establish a clearance number that cover a wide spectrum of tires with appropriate frame clearance. However, it is impossible for us to test all tires and rim combination available on the market, so be mindful that some combinations may result in slight rubbing if higher than 66mm in actual width.

STEERING COLUMN DIMENSIONS		
1. UPPER (S.H.I.S)	ZS44	1-1/8" Zerostack
2. LOWER (S.H.I.S)	ZS56	1.5" Zerostack
CRANKSET		
3. STANDARD	Mid-Drive Motor	
4. CRANK	ISIS	
5. MINIMUM Q-FACTOR	177 mm	
ELECTRIC ASSIST BOSCH		
6. DRIVE UNIT COMPATIBLE	Bosch Performance Line SX	
7. BATTERY MOUNT COMPATIBLE	Direct Mount Bosch PowerMore KFC072001 150mm cable	
8. BATTERIES COMPATIBLE	Compact PowerTube 400 (CPT 400) Horizontal with screw on plate	
9. SPEED SENSOR TYPE	Rotor Magnet Bosch Valve Magnet Compatible	
MECHANICAL DRIVETRAIN		
10. REAR HUB SPACING O.L.D. (OVER LOCKNUT DIMENSION)	TA 12x148 Boost	
11. MAXIMUM & MINIMUM CHAINRING	38T	32T
12. SMALLEST COG COMPATIBLE	12s 9T	
13. BIGGEST COG COMPATIBLE	12s 52T	
14. MAXIMUM & MINIMUM RECOMMENDED CHAINLINE	55mm	55mm
SEAT TUBE AND SEAT CLAMP		
15. SEAT TUBE INSIDE DIAMETER	31.6 mm	
16. SEAT TUBE OUTSIDE DIAMETER	34.9 mm	
17. DROPPER POST COMPATIBLE	Yes Full Internal	
BRAKES		
18. BRAKE MOUNT (FRAME)	Post Mount 200mm direct	
19. MAX ROTOR SIZE COMPATIBLE (FRAME)	220 mm	
ACCESSORIES		
20. WATER BOTTLE (FRAME)	YES	
21. PROTECTORS	DOWNTUBE & CHAINSTAY	
COMPATIBILITY INFO (BASED ON SIZE MEDIUM)		
E-TROY FORK 160 MM TRAVEL 150MM		
15. FRONT SUSPENSION (TRAVEL & SAG)	160 mm	20-25%
16. FORK (AXLE-TO-CROWN & DÉPORT)	571	44
17. FRONT & REAR WHEEL GEOMETRY	750	720
18. FRONT & REAR MAX ETRTO	66-622	66-584
17. REAR SUSPENSION (DIMENSIONS & SAG)	185 x 55 mm	30%
18. SHOCK PIGGYBACK COMPATIBILITY	Yes	
19. SPRING TYPE COMPATIBILITY	Air & Coil	
20. UPPER/FRONT SHOCK HARDWARE DIMENSIONS	Trunnion	
21. LOWER/REAR SHOCK HARDWARE DIMENSIONS	35 x 10 mm	

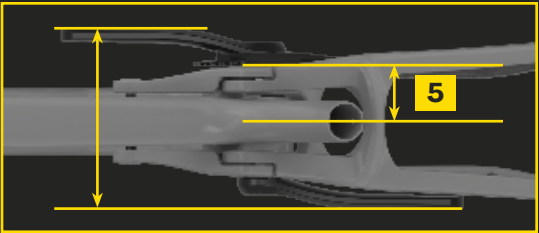

SIZES AVAILABLE
S | M | L | XL

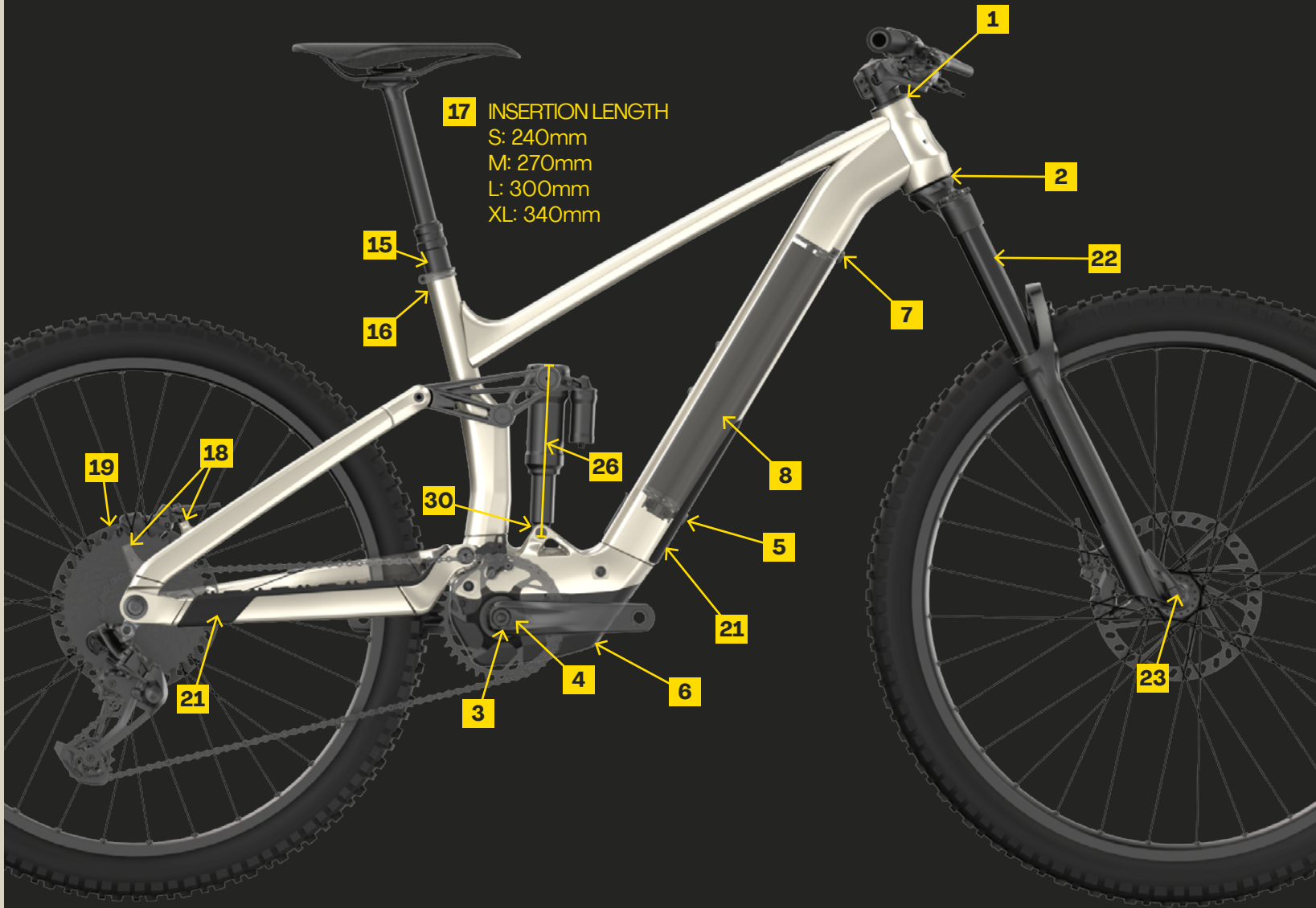

THE LOWER POSITION OF THE INSERTS IS RESERVED FOR THE WATER BOTTLE HOLDER, WHILE THE UPPER POSITION IS EXCLUSIVE TO THE BOSCH POWERMORE BATTERY EXTENSION. THE POWERMORE BATTERY IS NOT COMPATIBLE IN THE LOWER POSITION: THIS POSITION WOULD DAMAGE THE SHOCK ABSORBER AS WELL AS THE POWERMORE. DEVINCI DISCLAIMS ANY RESPONSIBILITY FOR IMPROPER INSTALLATION THAT WOULD CAUSE DAMAGE TO THE SUSPENSION AND POWERMORE BATTERY.

NOTE : IF THE BATTERY GETS DRAINED TO 0%, THE CHARGER NEEDS TO BE CONNECTED TO THE BIKE FIRST AND THEN TO THE POWER OUTLET IN ORDER FOR COMMUNICATION TO BE ESTABLISHED AND BEGIN THE CHARGING PROCESS



CABLE ROUTING

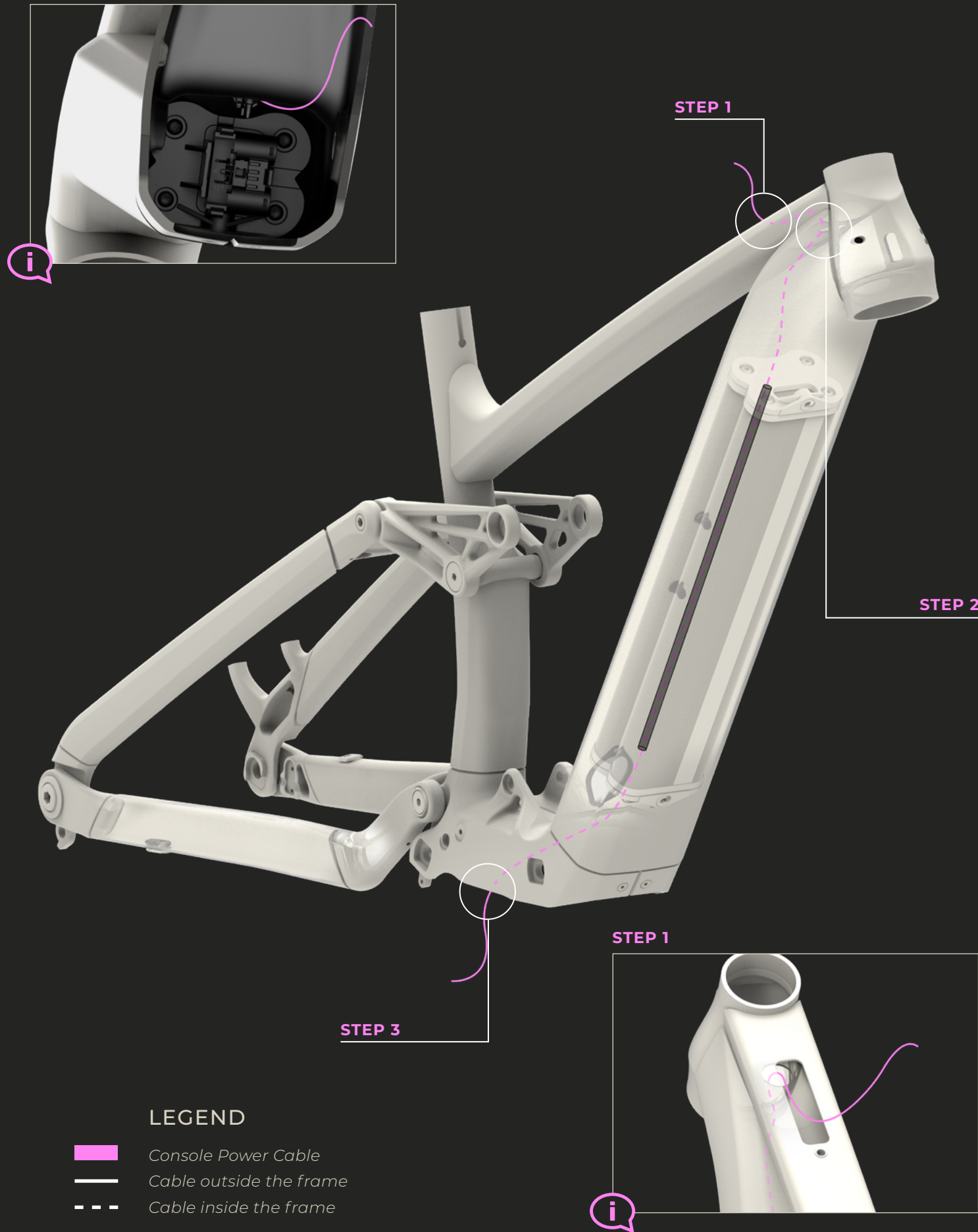

CABLE ROUTING

CONSOLE POWER CABLE

STEP 1 | Insert the electrical cable through the cavity located on the top of the top tube.

STEP 2 | Insert the console electrical cable into the downtube through the cavity located at the junction between the top tube and the downtube.

STEP 2 | Then, feed the electrical cable into the downtube until it reaches the motor shell. Slide the anti-impact foam tube onto the cable until it reaches the downtube.

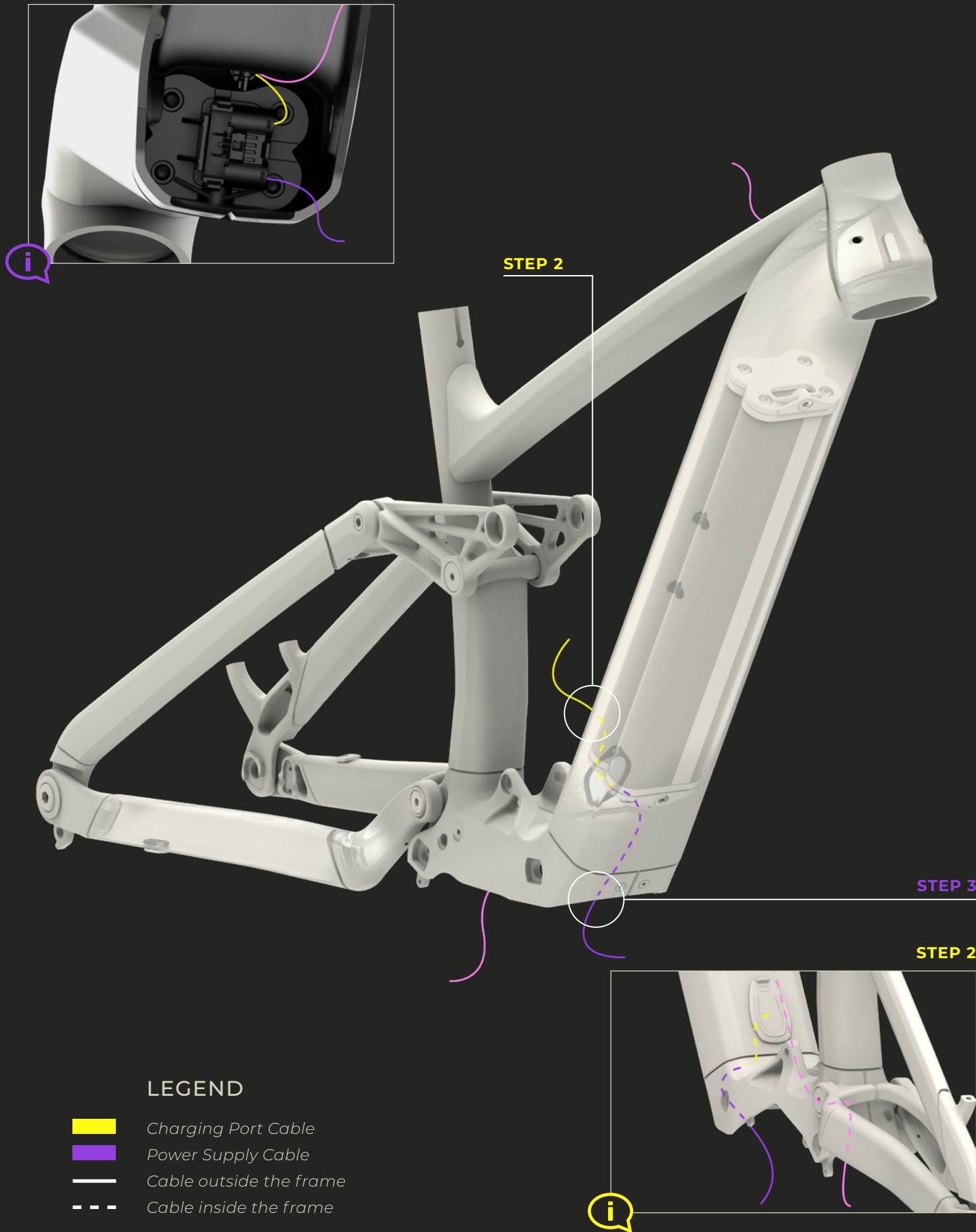

CABLE ROUTING

CHARGING PORT & POWER SUPPLY CABLES

STEP 1 | Assemble the charging port cable to the power supply cable. Slide and secure the battery into the diagonal, ensuring that **the console power cable** passes over the top of the battery, to the right of the water bottle cage rivets.

STEP 2 | Fix the charging port to the surface of the diagonal.

STEP 3 | Let the power cable hang through the motor shell.

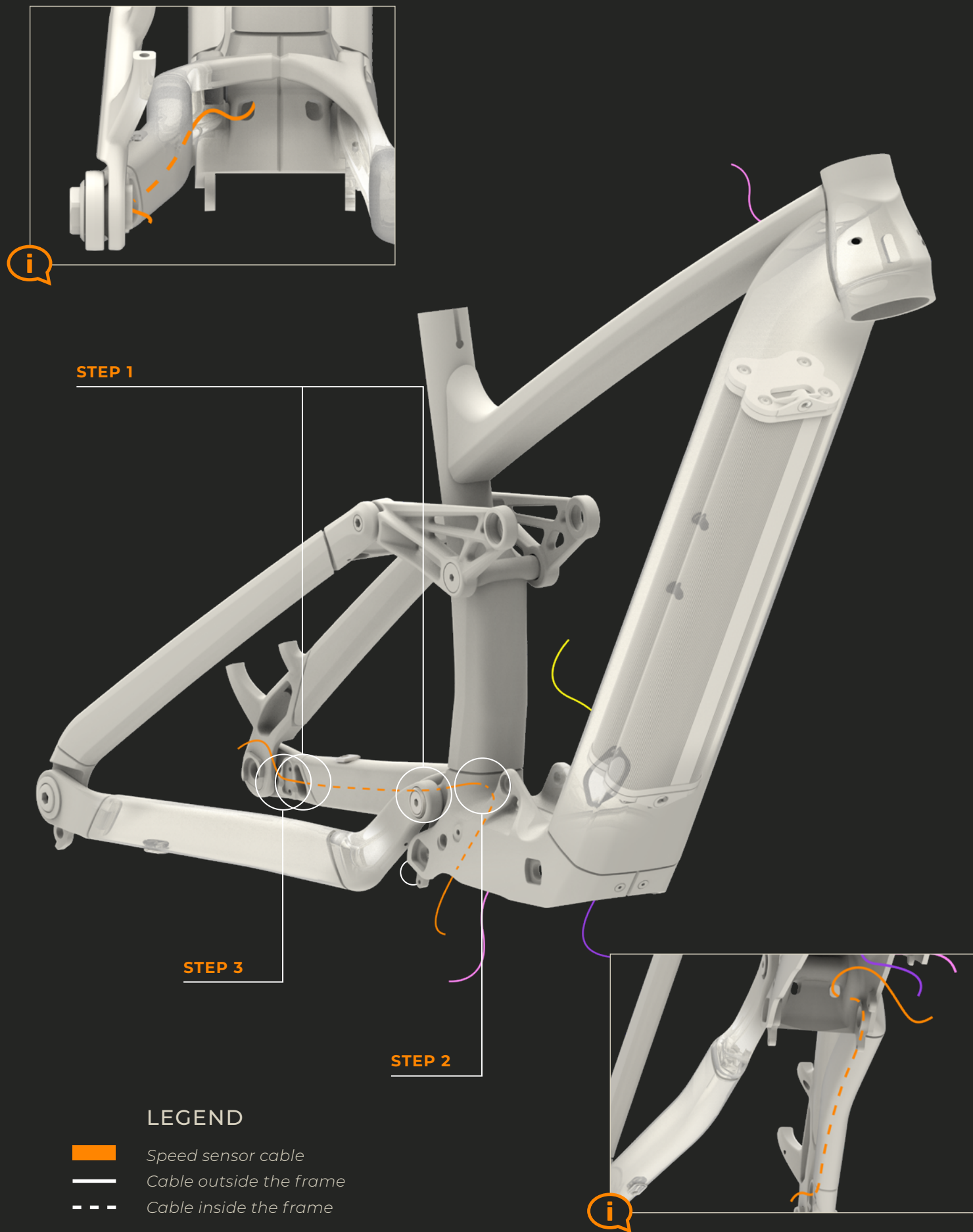

CABLE ROUTING

SPEED SENSOR CABLE

- STEP 1** | Insert the speed sensor cable into the cavity located on the inner left side of the base, at the rear of the bike. Thread the cable through the base until it comes out through the cavity at the front.
- STEP 2** | Insert the cable into the motor shell through the left cavity located at the bottom of the seat tube.
- STEP 3** | Secure the cable at the edge of the entry cavity using the bracket and screw provided for this purpose.

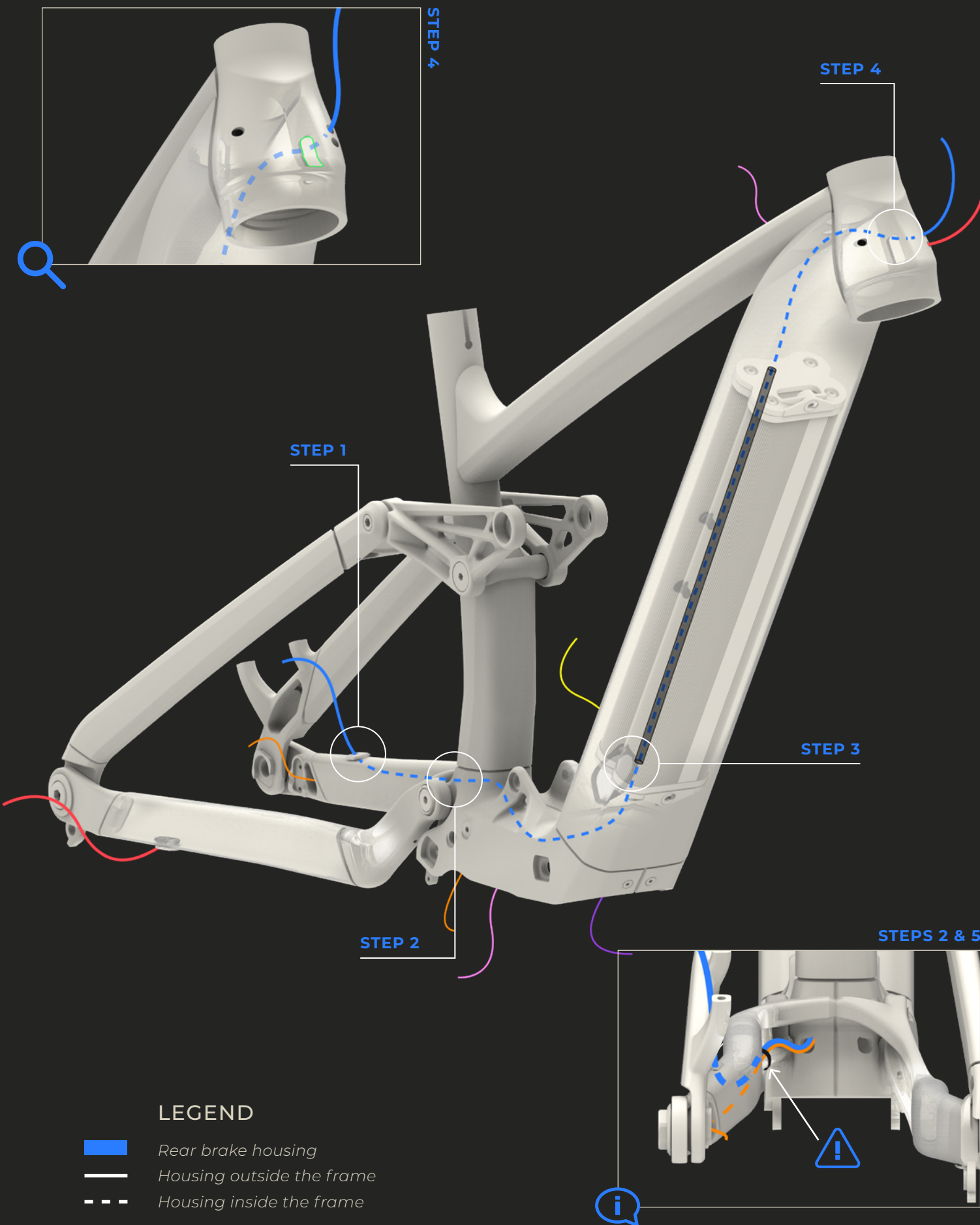

CABLE ROUTING



REAR BRAKE HOUSING



Make sure that the battery is in place in the diagonal before beginning.

STEP 1 | Make sure the rubber stopper is in place on the cavity located on the top of the base. Then, insert the rear brake housing through the stopper and feed it through to the cavity at the front of the base.

STEP 2 | Insert the rear brake housing into the motor shell through the left cavity.

STEP 3 | Slide the anti-impact foam tube onto the housing, then insert it into the center of the diagonal (above the battery, to the left of the bottle cage rivets) until reaching the head tube.

STEP 4 | Insert the rear brake cable housing into the inner left oval cavity of the head tube, then pull the housing out through the upper left stop.



Make sure that the rear brake housing is securely inserted into the inner left cavity of the head tube to prevent any rubbing against the fork steerer tube.

STEP 5 | Secure the rear brake housing and the speed sensor cable to the base using a small zip tie in the designated area.



Make sure to properly execute the last step to avoid the risk of friction between the housing and the tire.

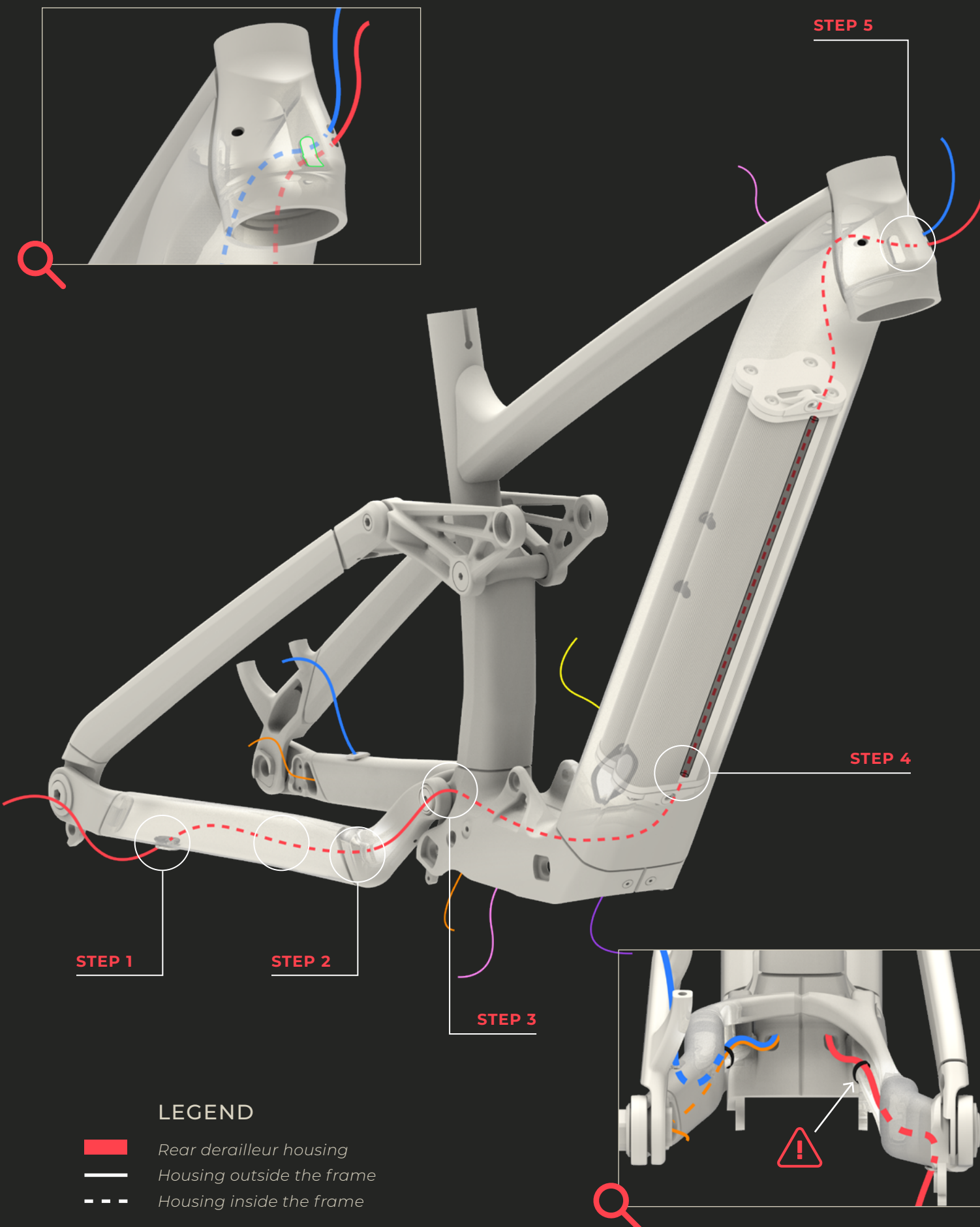

PASSAGE DE GAINES

REAR DERAILLEUR HOUSING

- i** Make sure that the battery is in place in the diagonal before startin
- i** Tip → Slightly bend the end of the housing to ease its insertion into the base before starting.
- ÉTAPE 1 |** Make sure the rubber stopper is in place on the cavity located under the right side of the base. Then, thread the rear derailleur housing through the stopper.
- ÉTAPE 2 |** Thread the housing through the base and pull it out through the cavity located at the front.
- ÉTAPE 3 |** Insert the cable into the motor shell through the cavity located on the right side.
- ÉTAPE 4 |** Slide the anti-impact foam tube over the housing, then insert it into the left side of the diagonal until it reaches the steering column.
- ÉTAPE 5 |** Insert the rear derailleur housing into the inner left oval cavity of the steering column, then pull the cable out through the lower left stopper.
- i** Make sure that the rear brake cable housing is properly inserted into the inner left cavity of the steering column to prevent friction with the fork steerer tube.
- ÉTAPE 6 |** Secure the rear derailleur housing to the base at the designated location using a small zip tie.
- i** Make sure to properly execute the last step to avoid the risk of friction between the housing and the tire.

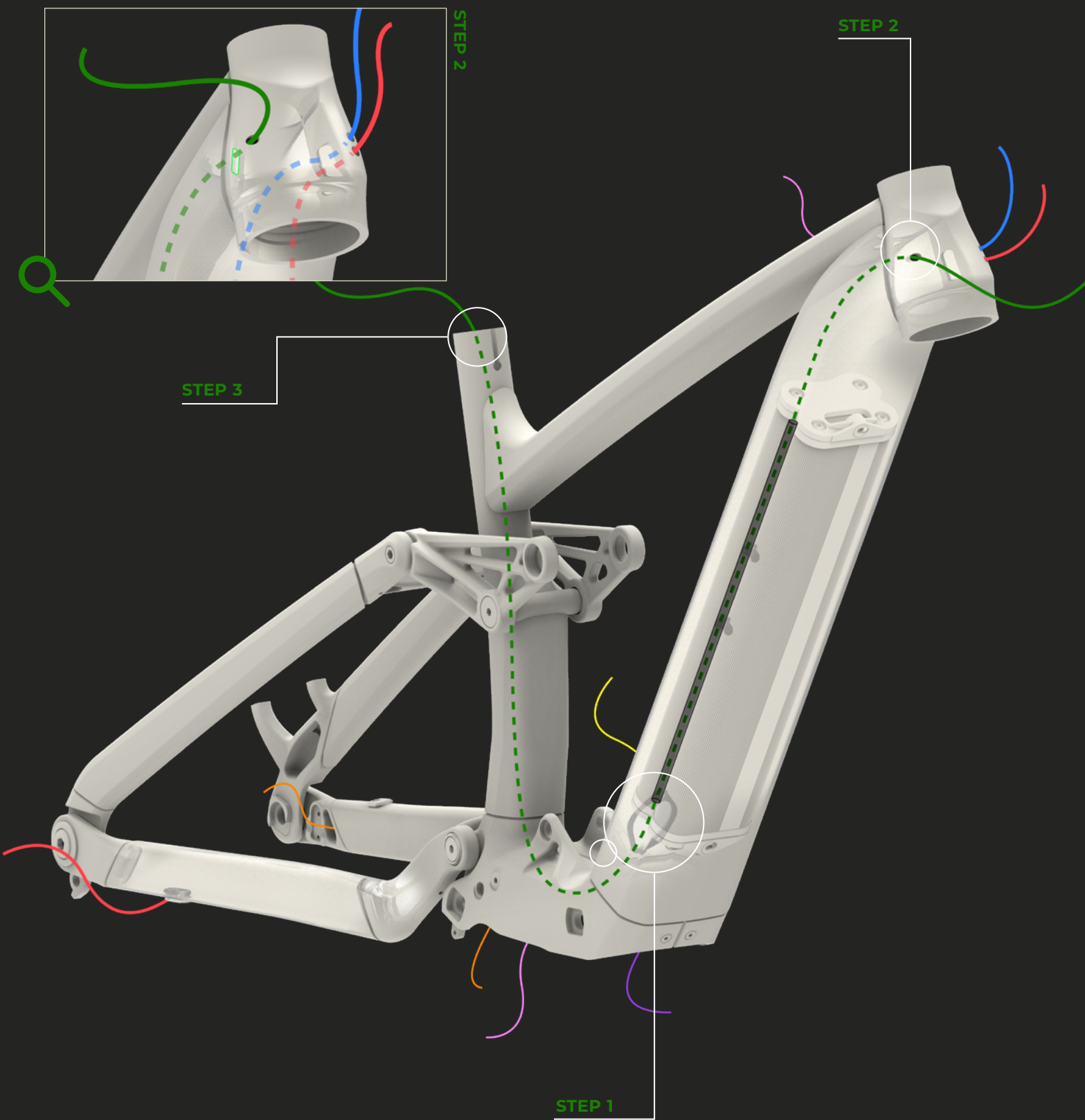

LEGEND

- █ Seat post housing
- Housing outside the frame
- - - Housing inside the frame



CABLE ROUTING











SEAT POST HOUSING

- STEP 1** | Slide the foam anti-impact tube over the seat post housing, then insert it to the right of the battery into the diagonal until reaching the head tube.
- STEP 2** | Insert the seat post housing into the inner oval cavity of the right side of the head tube, then pull the housing out through the lower right stopper.
- STEP 3** | From the motor shell, insert the seat post cable housing up to the upper end of the seat tube.



CABLE ROUTING OVERVIEW

LEGEND

-  Rear Brake Housing
-  Rear Derailleur Housing
-  Seat Post Housing
-  Charging Port Cable
-  Power Supply Cable
-  Speed Sensor Cable
-  Console Power Cable
-  Cables outside the frame
-  Cables inside the frame
-  Anti-impact foam tube

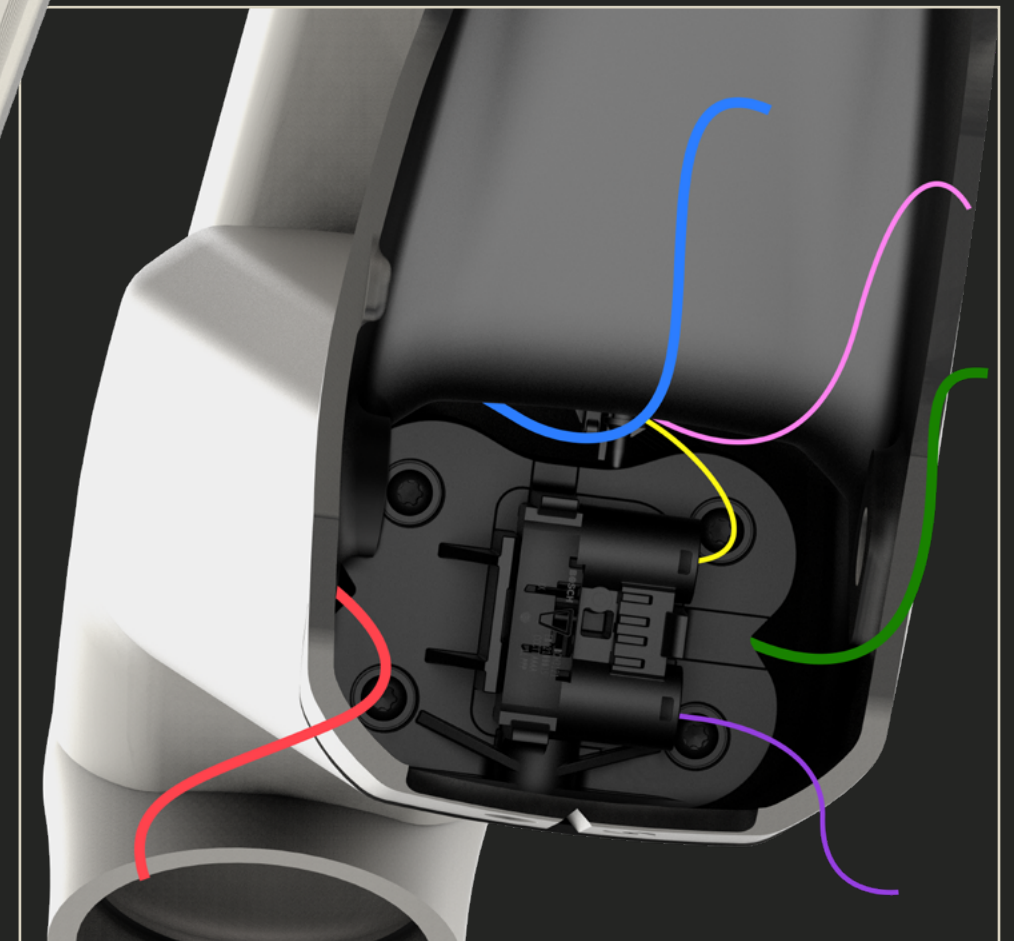
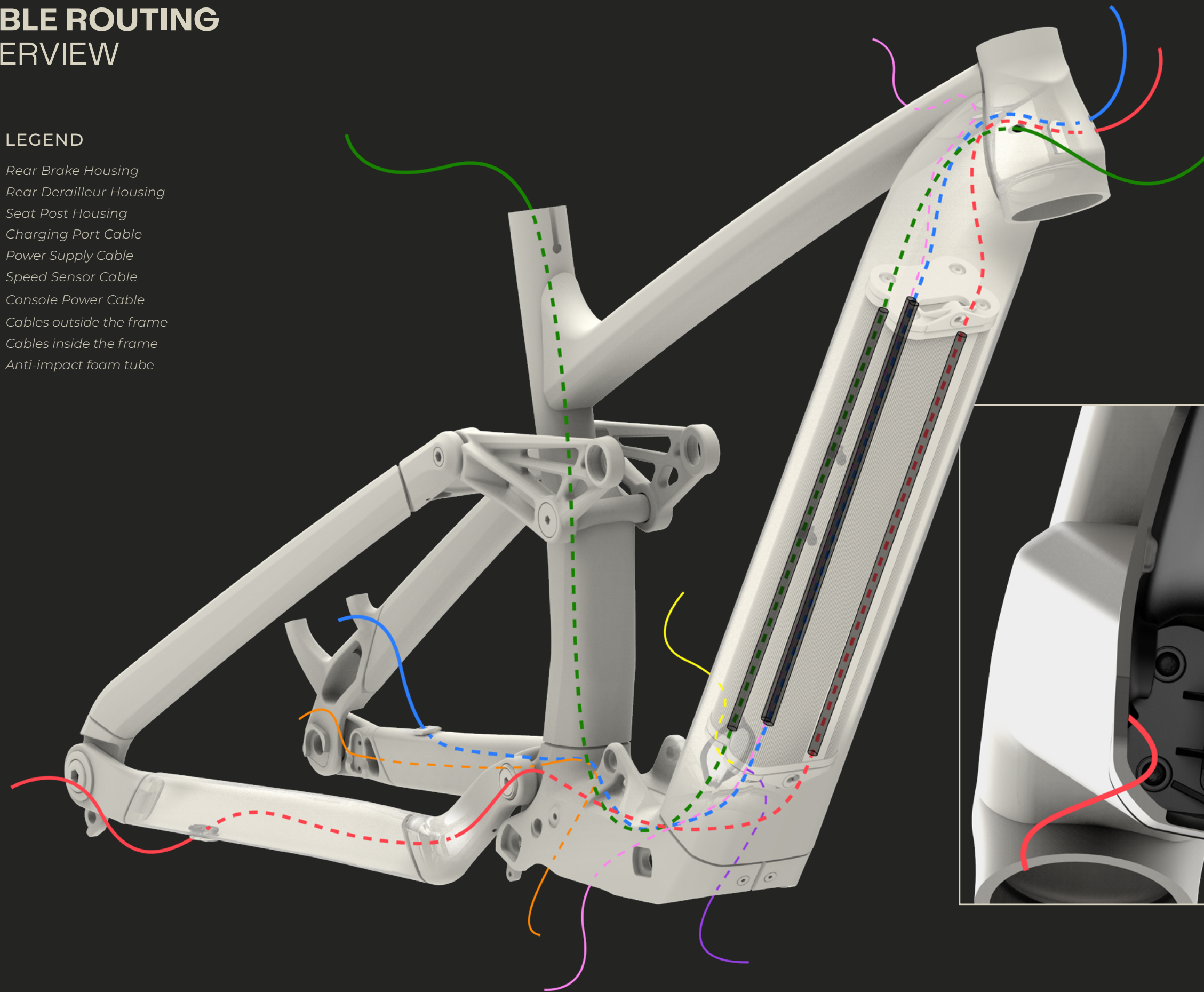



SERVICE KITS

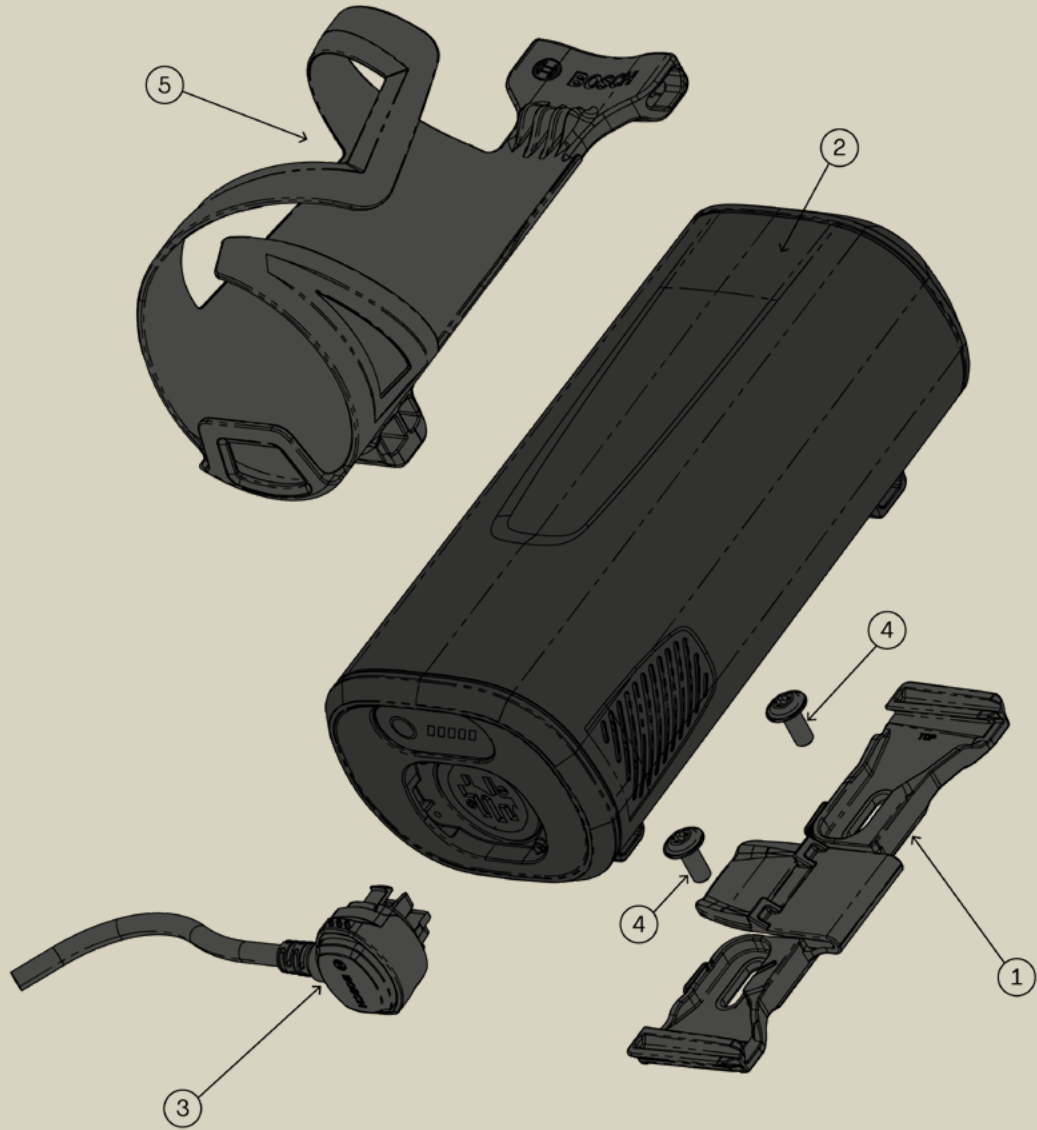

KFC07201 | KIT POWERMORE W/BOTTLE CAGE E-TROY LITE

KFC07201 KIT POWERMORE W/BOTTLE CAGE			
ITEMS	PART #	DESCRIPTION	QTY
1	MABT24030	Holder PowerMore BOSCH	1
2	MABT24031	PowerMore 250 Wh BOSCH	1
3	MABT24040	Cable PowerMore 150 mm BOSCH	1
4	MFV24060	Screw M5x12 BOSCH	2
5	MAABC24001	Bottle Cage for PowerMore Holder	1



KFC07202 PIVOT KIT			
ITEMS	PART #	DESCRIPTION	QTY
1	MFP24008	Dropout Pivot Left Shaft 20 mm	1
2	MFP21001	Hanger UDH	1
3	MFP24009	Pivot Nut for MR 20307 Bearing	1
4	MFV24016	Socket Cap Screw M12 x 1.0 x 21mm	2
5	MFV24008	Pivot Washer	2
6	MFV24012	Socket Flat Screw M8 x 1.25 x 20mm	2
7	MFP24010	Shaft 12x73	2
8	MFP24012	Pivot Spacer 12x16x4	2

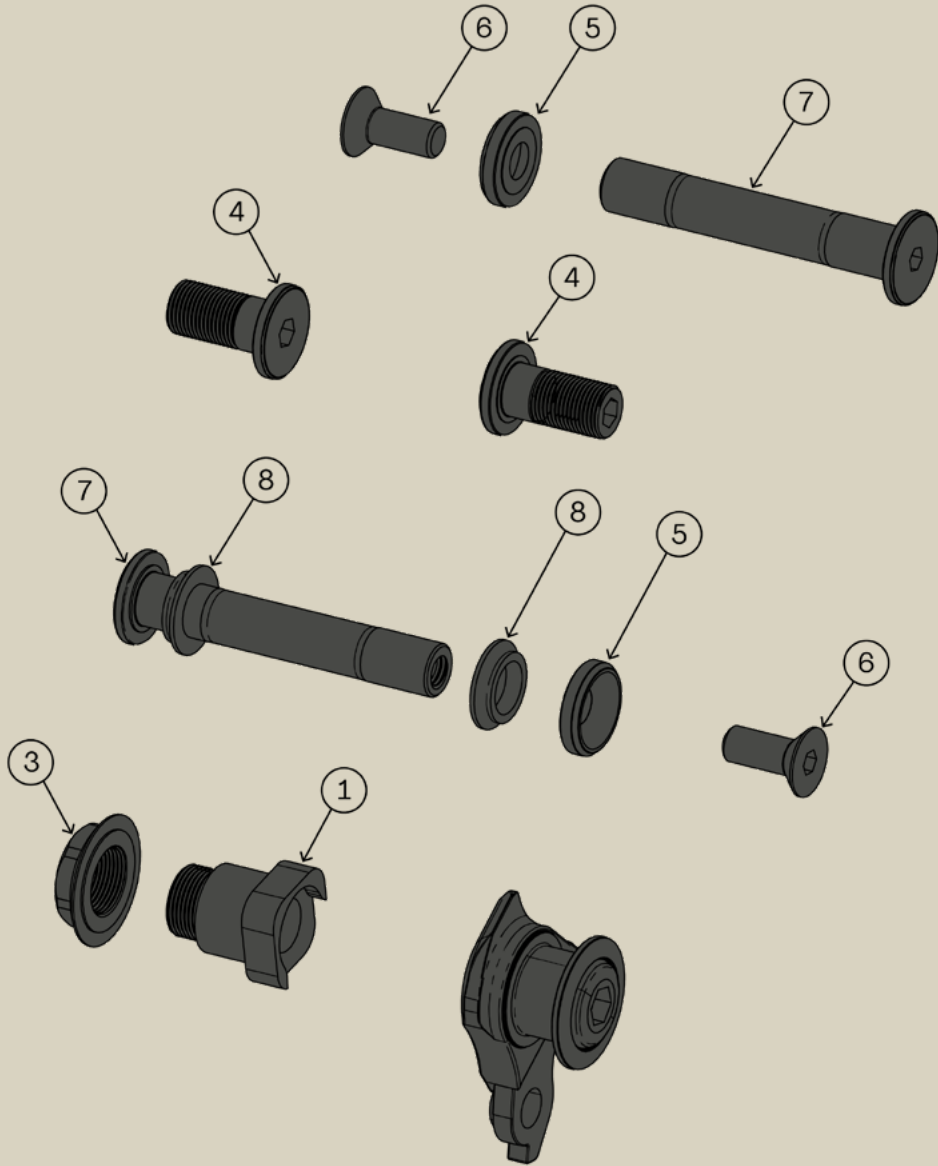

KFC07202 | PIVOT KIT E-TROY LITE

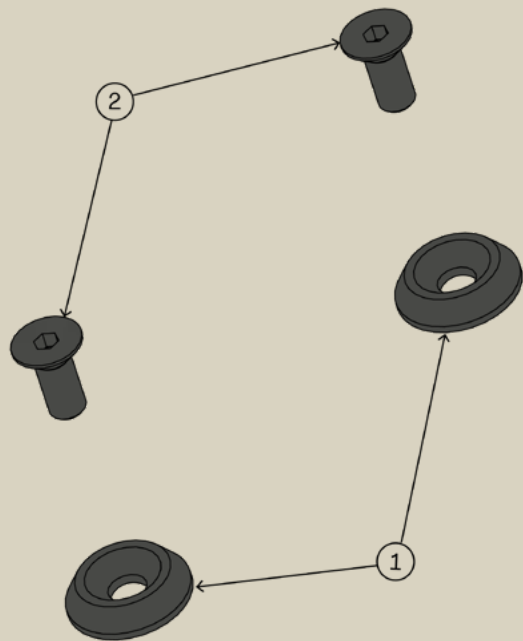

KFC07203 | **BATTERY MOUNT BOLT W/WASHER** E-TROY LITE

KFC07203			
ITEMS	PART #	DESCRIPTION	QTY
1	MABT24030	Holder PowerMore BOSCH	2
2	MABT24031	PowerMore 250 Wh BOSCH	2

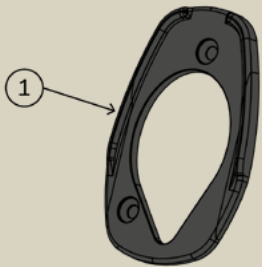

KFC07204 | **CHARGING PORT SPACER** E-TROY LITE

KFC07204 CHARGING PORT SPACER			
ITEMS	PART #	DESCRIPTION	QTY
1	MAPT25001	Plastic spacer for COBS	1



KFC07205 MOTOR COVER KIT			
ITEMS	PART #	DESCRIPTION	QTY
1	MABT24030	Holder PowerMore BOSCH	2
2	MABT24031	PowerMore 250 Wh BOSCH	2
3	MABT24040	Cable PowerMore 150 mm BOSCH	6
4	MFV24060	Screw M5x12 BOSCH	
5	MAABC24001	Bottle Cage for PowerMore Holder	

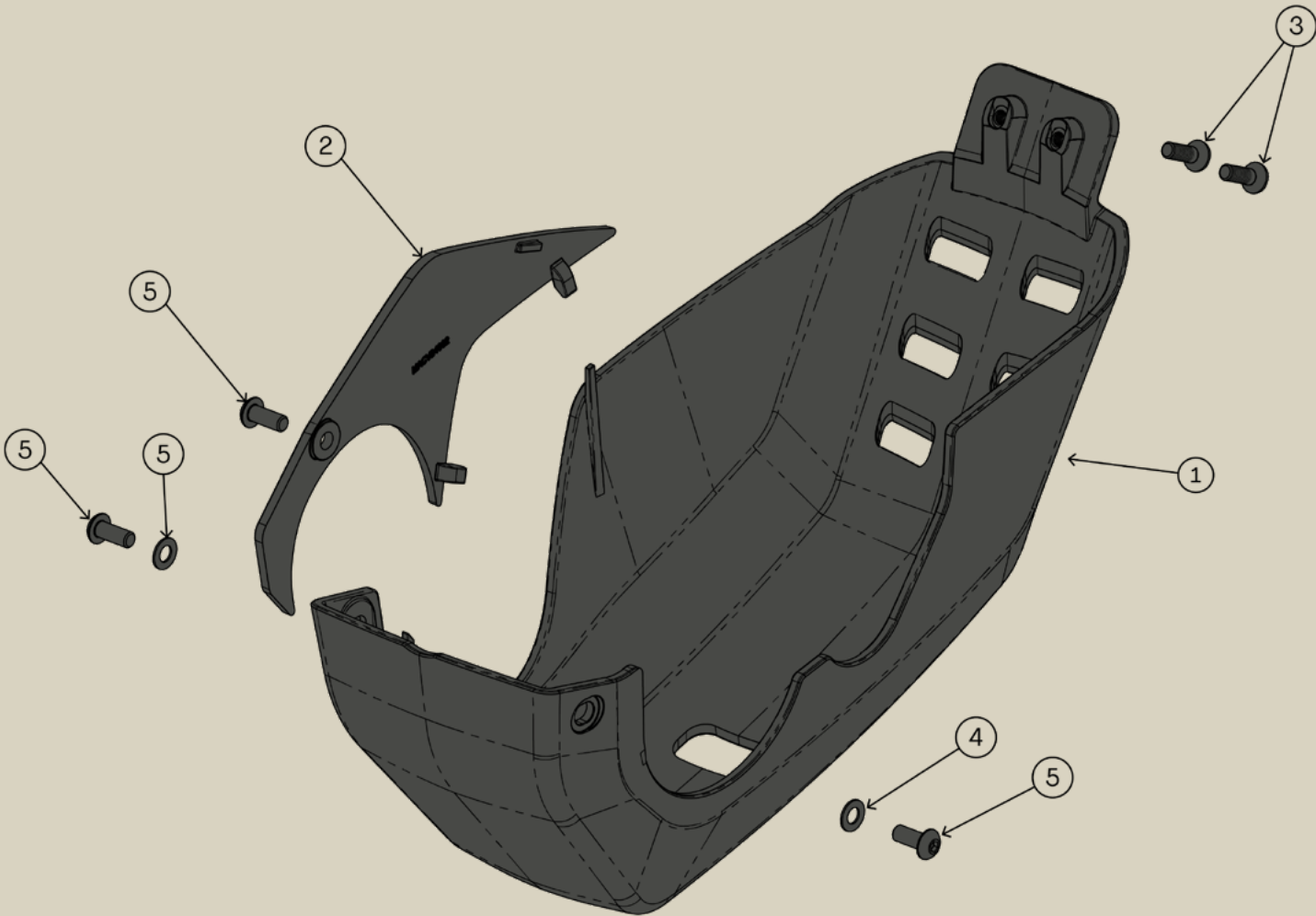

KFC07205 | **MOTOR COVER KIT** E-TROY LITE

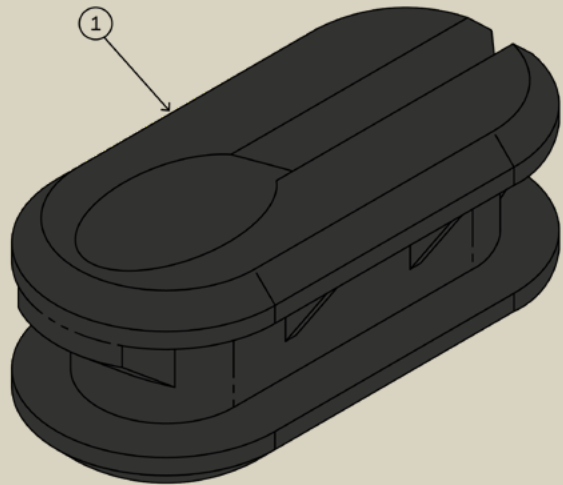

KFC07206 | CHAINSTAY CABLE GUIDE E-TROY LITE

KFC07206 CHAINSTAY CABLE GUIDE			
ITEMS	PART #	DESCRIPTION	QTY
1	MFB19008	Cable Guide 5mm	1

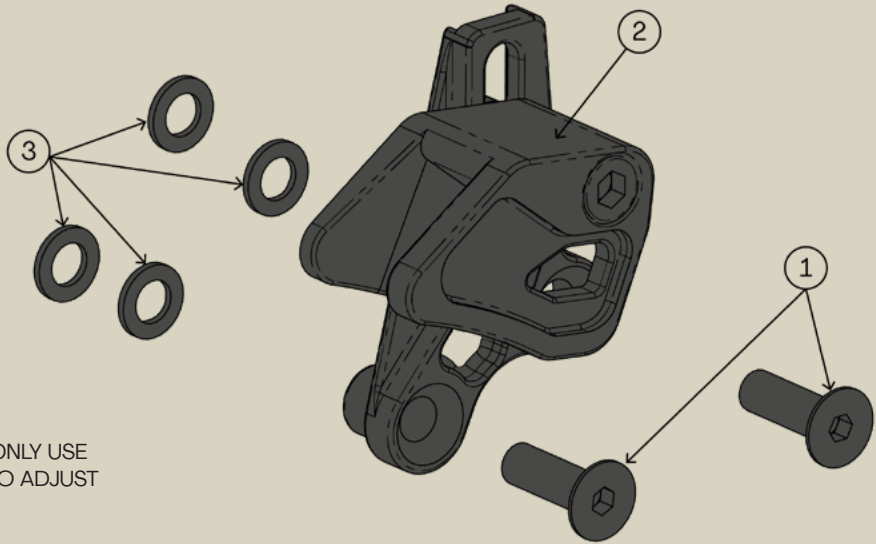

NOTE:
NOT ALL 4 WASHER ARE NECESSARY. ONLY USE THE CORRECT NUMBER OF WASHER TO ADJUST THE CHAIN GUIDE TO EACH FRAME.

KFC07207 | CHAIN GUIDE E-TROY LITE

KFC07207 CHAIN GUIDE			
ITEMS	PART #	DESCRIPTION	QTY
1	-	Flat Head HEX. Screw M5 x 16MM	2
2	MAGC24002	Chain Device CH-ES-LD DM	1
3	WASHER M5	O.D. 9.0	4



KFC08902 BEARING KIT			
ITEMS	PART #	DESCRIPTION	QTY
1	MFP21016	BALL BEARING MR20307 20x30x7; STD TYPE, DOUBLE LIP	2
2	MFP24014	BEARING 6900 WITH EXTENDED INNER CAGE	2
3	MFP19001	BALL BEARING 3801 LLU MAX 12x21x8	6

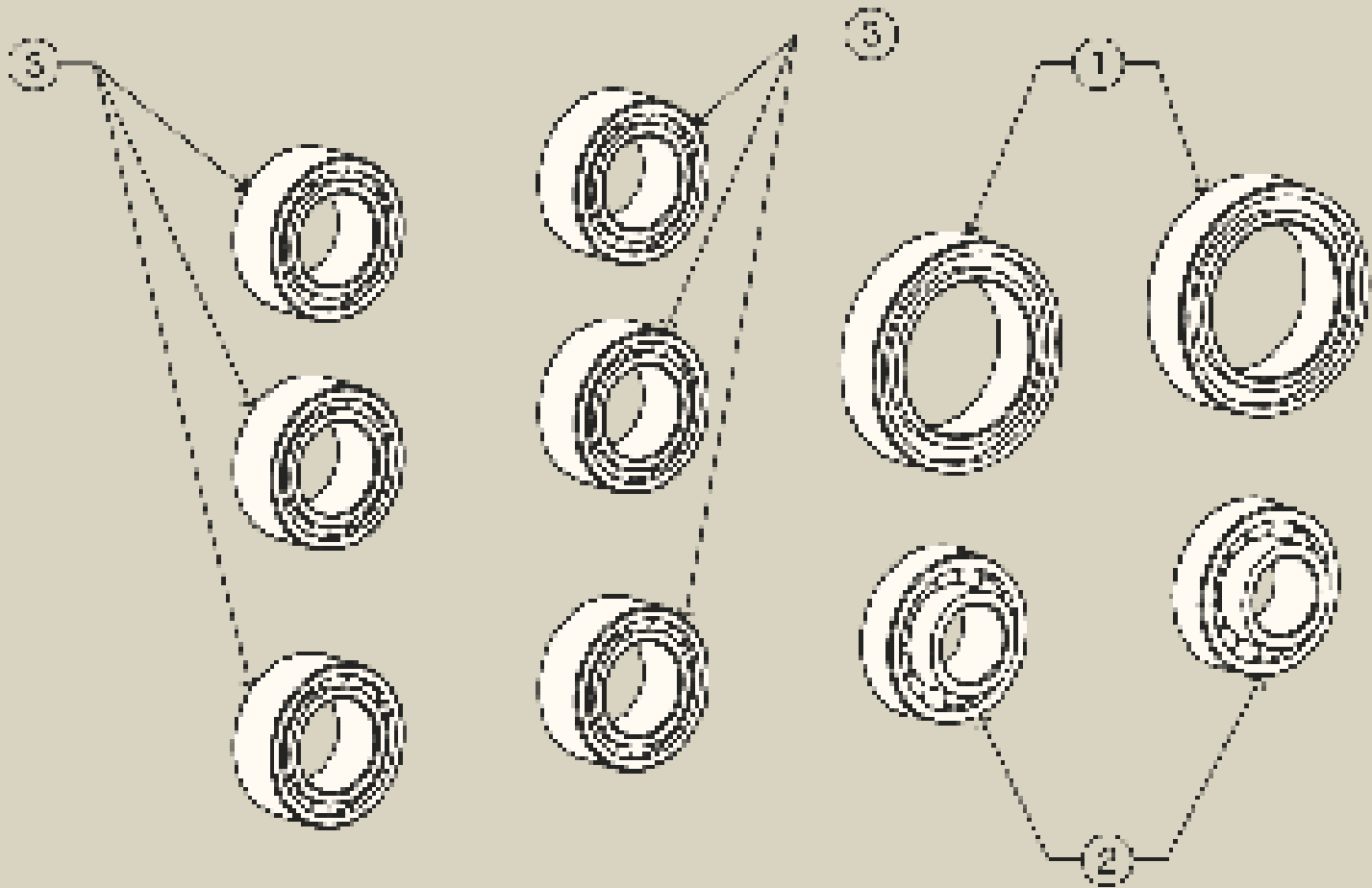

KFC08902 | BEARING KIT



KFC08901 SHOCK BOLT			
ITEMS	PART #	DESCRIPTION	QTY
1	MFV21002	SOCKET CAP SCREW M10 x 1.0 x 48mm	1
2	MFV24009 (Default)	UPPER SHOCK SCREW E-MTB SL	2

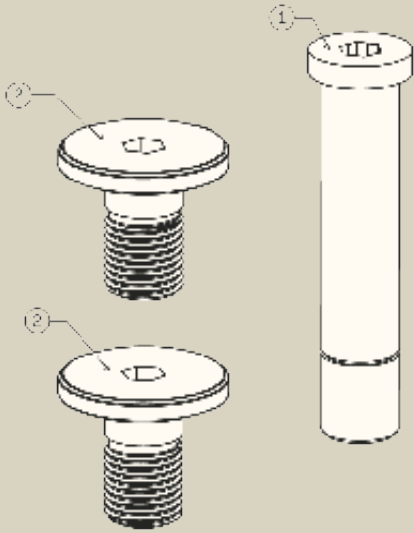

KFC08901 | SHOCK BOLT

KFC05602 DERAILLEUR HANGER			
ITEMS	PART #	DESCRIPTION	QTY
1	KFC04501	Chainsaw Cable Guide Kit	

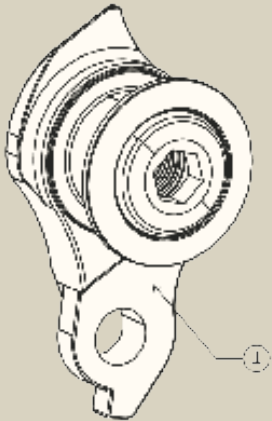

KFC05602 | DERAILLEUR HANGER UDH



KFC08908 CHAINSTAY PROTECTOR			
ITEMS	PART #	DESCRIPTION	QTY
1	MACP24005	CS PROTECTOR 072-9800	1

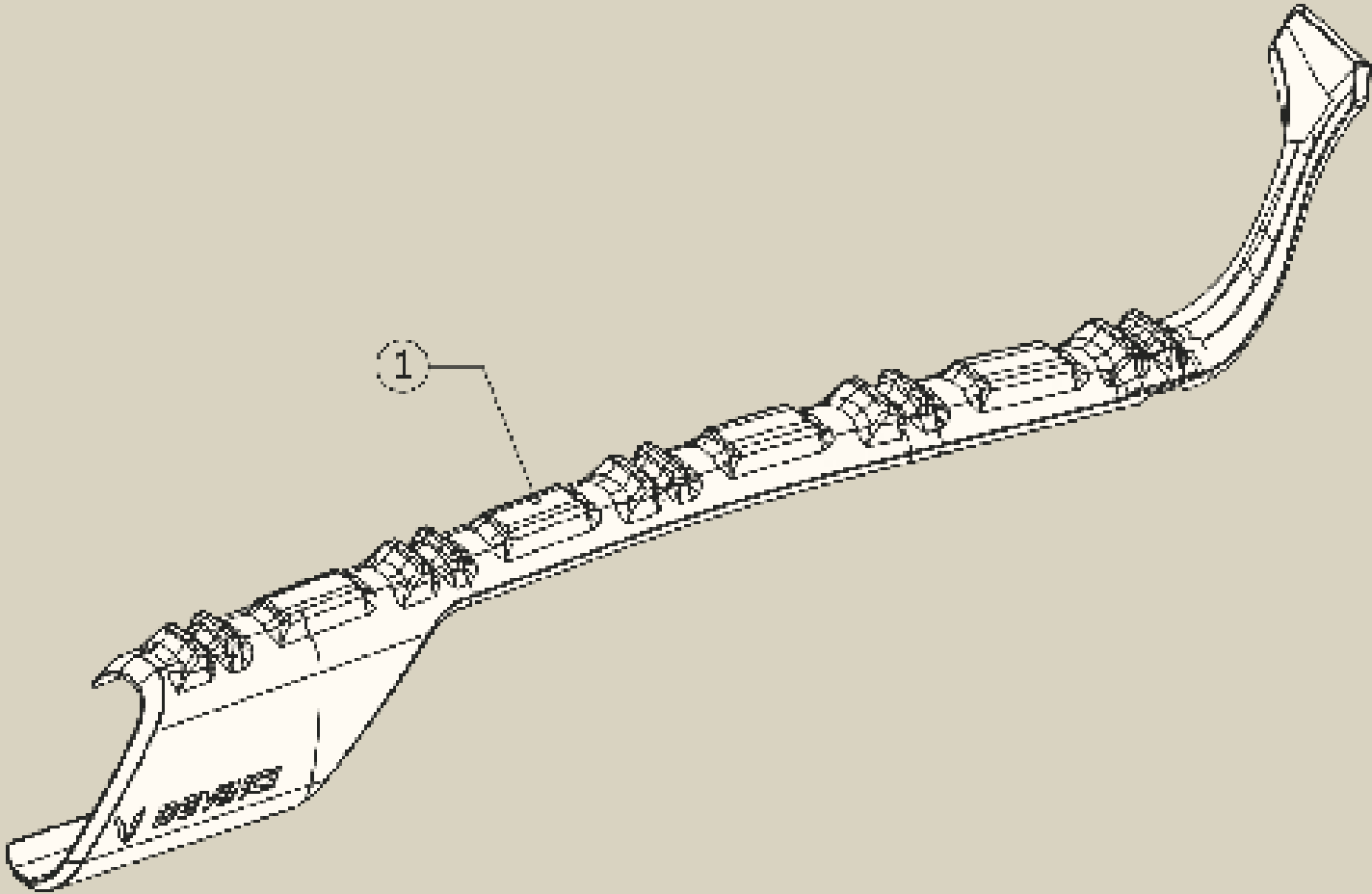

KFC08908 | CHAINSTAY PROTECTOR

A person with long hair, wearing a helmet and a light-colored t-shirt, is sitting on a mountain bike on a rocky ridge. The background features a vast, hazy landscape with rolling hills and mountains under a soft, orange-hued sky, suggesting a sunset or sunrise. The foreground is filled with dry, brownish vegetation.

WARRANTY

DEVINCI WARRANTY



At Devinci, durability, performance, and peace of mind are at the core of everything we build. That’s why our warranty is designed to protect your investment and support you long after your purchase.

WHAT’S COVERED

FOR THE ORIGINAL OWNER

- **Aluminum frames:** Lifetime warranty* for the bicycle’s useful life
- **Carbon fiber frames:** Lifetime warranty* for the bicycle’s useful life
- **Paint and decals:** 1-year warranty
- **Suspension pivots (bearings, bolts, axles):** 1-year warranty

*Proof of purchase is required for all warranty claims.

COMPONENTS

All components on Devinci bikes are covered by their respective manufacturer warranties. For questions, your authorized Devinci retailer is your go-to resource. <https://www.devinci.com/en/find-a-dealer/>

OUTSIDE THE WARRANTY? WE’VE GOT YOUR BACK.

CUSTOMER ASSISTANCE PROGRAM

Accidents happen. That’s why we created the [Devinci Customer Assistance Program](#).

If your situation isn’t covered under warranty—whether it’s a crash, damage, or just bad luck—we’ll help you get back on the road or trail with a **discount on replacement parts**, based on their original retail price. This program is offered **for life**, at our discretion, and is available through our customer service team or any authorized Devinci retailer.

WHAT’S NOT COVERED

Our warranty does not apply in the following cases:

- Bike not purchased from an authorized Devinci retailer
- Improper assembly or service not performed by an authorized retailer
- Accidents, misuse, or excessive/abusive riding
- Damage from high-intensity use (racing, bike parks, improper transport, etc.)
- Structural or cosmetic modifications to the frame
- Normal wear and tear or material fatigue over time
- Costs of replacing parts that are worn out or obsolete at the time of the claim

For any questions, please contact our customer service team or your nearest Devinci retailer.

DEVINCI WARRANTY POLICY

All Devinci frames are covered by a manufacturer’s warranty against defects in materials and workmanship for a specified period, as detailed below, starting from the date of purchase. Any parts replaced or repaired under this warranty are covered for the remaining duration of the original warranty period.

The bicycle owner must provide proof of purchase to make a warranty claim.

Replacement parts are subject to availability within Devinci’s inventory at the time of the claim. In some cases, the color, features, and/or model may differ from the original part.

At Devinci’s discretion, certain costs may apply when processing a warranty replacement or repair, including:

- Shipping fees
- Additional labor costs associated with the installation or repair of a part
- Costs of replacing parts that are worn out or obsolete at the time of the claim

WARRANTY DURATION

For the original purchaser:

- Aluminum frames are covered for the lifetime of the bicycle’s useful life.
- Carbon fiber frames are covered for the lifetime of the bicycle’s useful life.
- Paint and decals are covered for one (1) year from the original date of purchase.
- Suspension frame pivots (including bearings, bolts, and axles) are covered for one (1) year from the original date of purchase.
- The components assembled on Devinci bicycles are exclusively covered by the warranties provided by their respective manufacturers, with Devinci assuming no responsibility. Please contact your authorized Devinci dealer for more details on applicable warranties.

CUSTOMER ASSISTANCE PROGRAM

For those unexpected moments when your situation is not covered under our warranty policy, Devinci’s Customer Assistance Program is here to help. Whether it’s a crash, accidental damage, or simple bad luck, this program is designed to get you back on the road or trails as quickly as possible by offering a discount on replacement parts based on their original retail price.

This program is separate from Devinci’s manufacturer warranty and is managed at Devinci’s sole discretion. It is accessible through our customer service department or any authorized Devinci retailer.

WARRANTY EXCLUSIONS

At Devinci’s discretion, the warranty may be void under the following circumstances:

- The bicycle was not purchased from an authorized Devinci retailer.
- The bicycle was not fully assembled by an authorized Devinci retailer.
- Repairs were not performed by an authorized Devinci retailer.
- The instructions in the user manual and/or technical manual were not followed.
- Recommended periodic inspections and maintenance outlined in the user manual and/or technical manual were not performed.
- Non-compatible parts were installed. Compatible parts include original components or those specified as compatible in the user manual and/or technical manual.
- Paint damage caused by the application or removal of an adhesive frame protector.

DEVINCI WARRANTY

- Damage resulted from accidental or unforeseen events, such as:
 - Accidents, impacts, or falls
 - Misuse, abnormal or excessive use, or negligence
 - Intensive use beyond the scope of normal recreational cycling
 - Improper or repeated use of ski lifts, vehicle racks, or other transportation methods
 - Use in competition or in environments/activities beyond the intended design of the bicycle
- Additional damage caused by continued use of the bicycle after an initial defect, if a warranty claim was not filed or was denied.
- The frame and/or components were altered (e.g., polishing, structural or mechanical modifications, stripping, sanding, shot peening, etc.).
- The frame size or model is inappropriate for the rider.
- Damage caused by normal wear and tear, including material fatigue over time.

LIMITATION OF LIABILITY

This warranty represents the complete and final warranty coverage for Devinci frames. Devinci does not authorize any individual, including authorized dealers, to offer any additional warranty beyond what is explicitly stated herein. Any other obligations, representations, or illustrations made by any party are not binding on Devinci and are excluded from this warranty.

Subject to applicable laws in Quebec and Canada, Devinci assumes no liability for material, bodily, or moral damages suffered by the user, purchaser, or any other party due to the use of a Devinci frame or component, except in cases of negligence or intentional misconduct by Devinci, as determined by a competent court.

Unless otherwise prohibited by applicable law, Devinci disclaims all other warranties, express or implied, including but not limited to implied warranties of merchantability or fitness for a particular purpose. Devinci's liability will not exceed the actual purchase price of the bicycle, nor will it cover any special, incidental, or consequential damages related to the bicycle.

By claiming warranty rights, the purchaser agrees that any legal proceedings shall be conducted in the judicial district of Chicoutimi, Province of Quebec, Canada.



1987



WE MAKE RIDERS

HEAD OFFICE

1555 Main
Chicoutimi (Quebec) Canada
G7K1G8

www.devinci.com