

WE MAKE RIDERS

CHICOUTIMI, QUÉBEC



CARBON



TECHNICAL MANUAL

HATCHET PRO 2025+

DEVINCI



ABOUT OUR MANUALS

Like many sports, cycling involves risk of injury and accidents, so you must be fully aware of these risks. Neither the manufacturer, the retailer, nor the person who sold you the bike, nor the people who maintain the trails are responsible for these risks. As you are solely responsible, it is, therefore, essential that you read and fully understand all the parts contained in this manual.

To enjoy maximum safety and enjoyment right from the get go, it is important that you are familiar with your new bike, its handling and its possibilities. It is your duty to maintain your bike well and reduce the risk of injury. Biking can be a dangerous activity, even under the best conditions. These are risks associated with using a bicycle that cannot be predicted or avoided. These are the sole responsibility of the cyclist.

YOUR AUTHORIZED DEVINCI RETAILER

Your authorized Devinci retailer is at your service to guide your choices of bike and accessories which are best suited to the style of biking you wish to perform. This will help you maintain your equipment in good condition so that you can take full advantage of your investment. The staff at your authorized Devinci retailer have the training, experience and tools to carry out the repairs and provide you with reliable advice.

However, your authorized Devinci retailer cannot make decisions for you, and cannot be held responsible for your lack of knowledge, experience, qualification or common sense. However, it will take the necessary time to explain the operation of a component or to help you choose an accessory that meets your specific needs.

For further information, please see the Devinci's User Manual available on www.Devinci.com or ask your authorized Devinci retailer. He will take the time to answer any questions you may have and will advise you with great pleasure.



FRAME: TECHNICAL SPECIFICATIONS

4



CABLE ROUTING

8



SERVICE KITS

18



F R A M E

TECHNICAL SPECIFICATIONS

HEADTUBE DIMENSIONS		
1. UPPER (S.H.I.S)	IS52	1.5" IS
2. LOWER (S.H.I.S)	IS52	1.5" IS
BOTTOM BRACKET		
3. STANDARD	BB 386 EVO PF	
4. FRONT DERAILLEUR MOUNT	BRAZE-ON	
5. MINIMUM Q FACTOR	148 mm	
FORK		
6. FRONT HUB SPACING (over locknut dimension)	TA 12x100 mm	
7. HEADTUBE DIMENSIONS (S.H.I.S.)	28.6 40	1-1/8" to 1.5"
TRANSMISSION (1X)		
8. REAR HUB SPACING (over locknut dimension)	TA 12x142 mm	
9. MAX. & MIN. CHAINRING	46T	38T
TRANSMISSION (2X)		
10. REAR HUB SPACING (over locknut dimension)	TA 12x142 mm	
11. MAX. BIGGEST CHAINRING	53T	
12. SMALLEST CHAINRING MAX. & MIN.	46T	33T
TRANSMISSION		
13. SMALLEST COG COMPATIBLE	10T	
14. BIGGEST COG COMPATIBLE	50T	
15. RECOMMENDED CHAINLINE MIN. & MAX.	44.5 mm	47.5 mm
SEAT TUBE & SEAT CLAMP		
16. SEATPOST OUTSIDE DIAMETER	27.2 mm	
17. SEAT TUBE OUTSIDE DIAMETER	31.8 mm	
18. SEATPOST COMPATIBLE	YES Fully Internal	
BRAKES		
19. BRAKE MOUNT (FRAME & FORK)	Flat Mount 160 mm direct	
20. ROTOR MAX. & MIN. COMPATIBILITY (FRAME & FORK)	160 mm	180 mm
21. BRAKE MOUNT THICKNESS (FORK)	20 mm	
ACCESSORIES		
22. SPACE FOR A BOTTLE (FRAME)	OUI	
23. STORAGE SYSTEM	YES SHED	
24. REAR RACK & FENDER MOUNT	YES	
GEOMETRY INPUTS (BASED ON MEDIUM SIZE)		
HATCHET PRO CARBON		
25. FORK (AXLE-TO-CROWN [A] & OFFSET [B])	A. 395	B. 50
26. FRONT & REAR WHEEL GEOMETRY	708	
27. FRONT & REAR MAX ETRTO	42-622	
28. TIRE CLEARANCE	700c x 45 mm	

***DISCLAIMER:** We are testing many different tires to establish a clearance number that cover a wide spectrum of tires with appropriate frame clearance. However, it is impossible for us to test all tires and rim combination available on the market, so be mindful that some combinations may result in slight rubbing if higher than 45mm in actual width.

SIZES AVAILABLE
S | M | L | XL

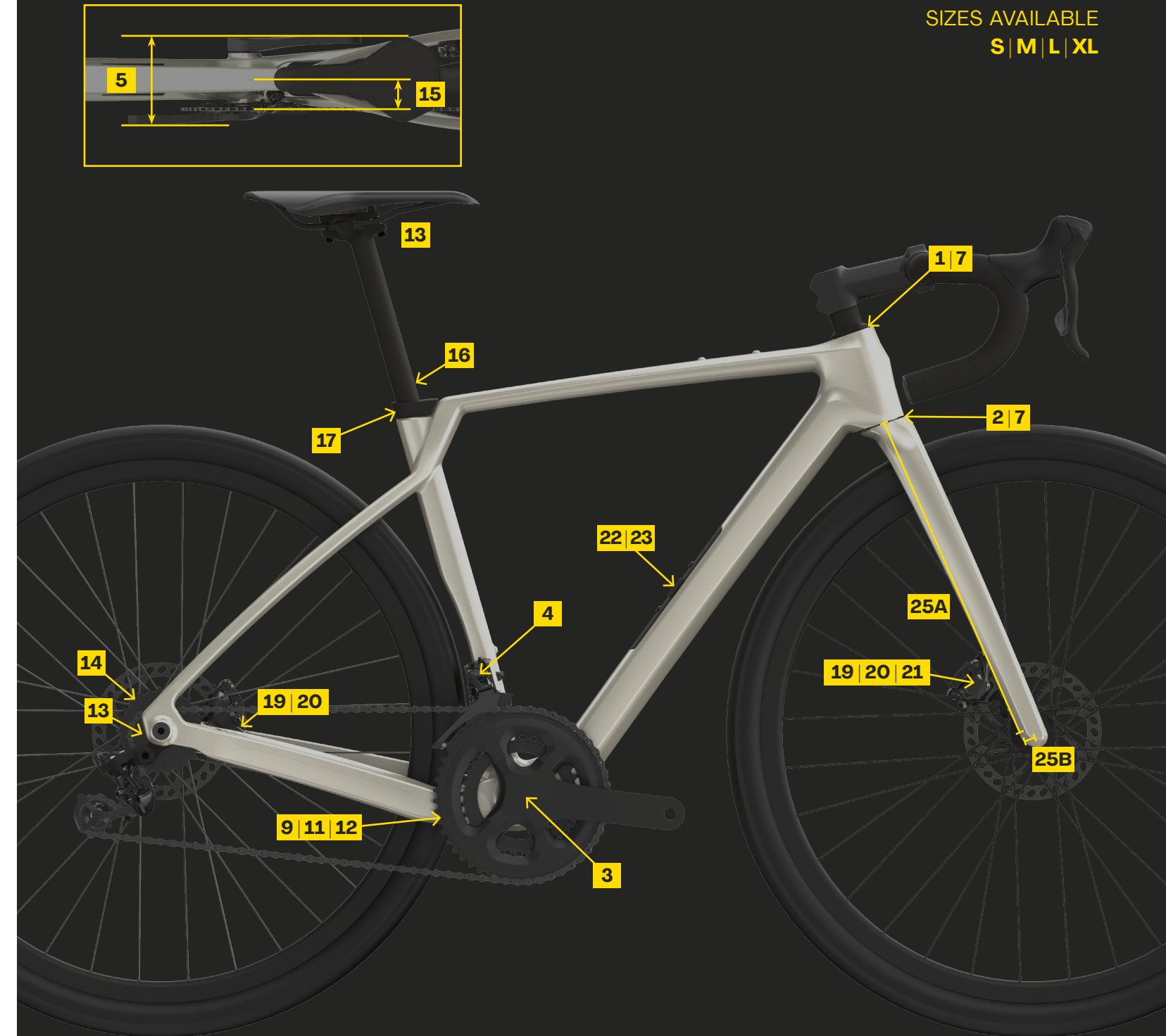

i THE STORAGE DOOR MUST BE PROPERLY ENGAGED TO ENSURE ITS ATTACHMENT AT THE DOWNTUBE LEVEL.

A "CLICK" WILL ACCOMPANY THE CLOSURE WHEN THE DOOR IS SECURELY LOCKED ONTO THE INNER SURFACE OF THE DOWNTUBE.

MAKE SURE THE LATCH IS CORRECTLY ENGAGED BEFORE EACH RIDE (ACCORDING TO IMAGE 2).

A close-up, low-angle shot of a bicycle handlebar and stem. The handlebar is wrapped in grey tape and features a Shimano brake lever on the left. The stem is dark blue with a white logo. The background is dark and out of focus. The text 'CABLE ROUTING' is overlaid in white, bold, sans-serif font.

CABLE
ROUTING

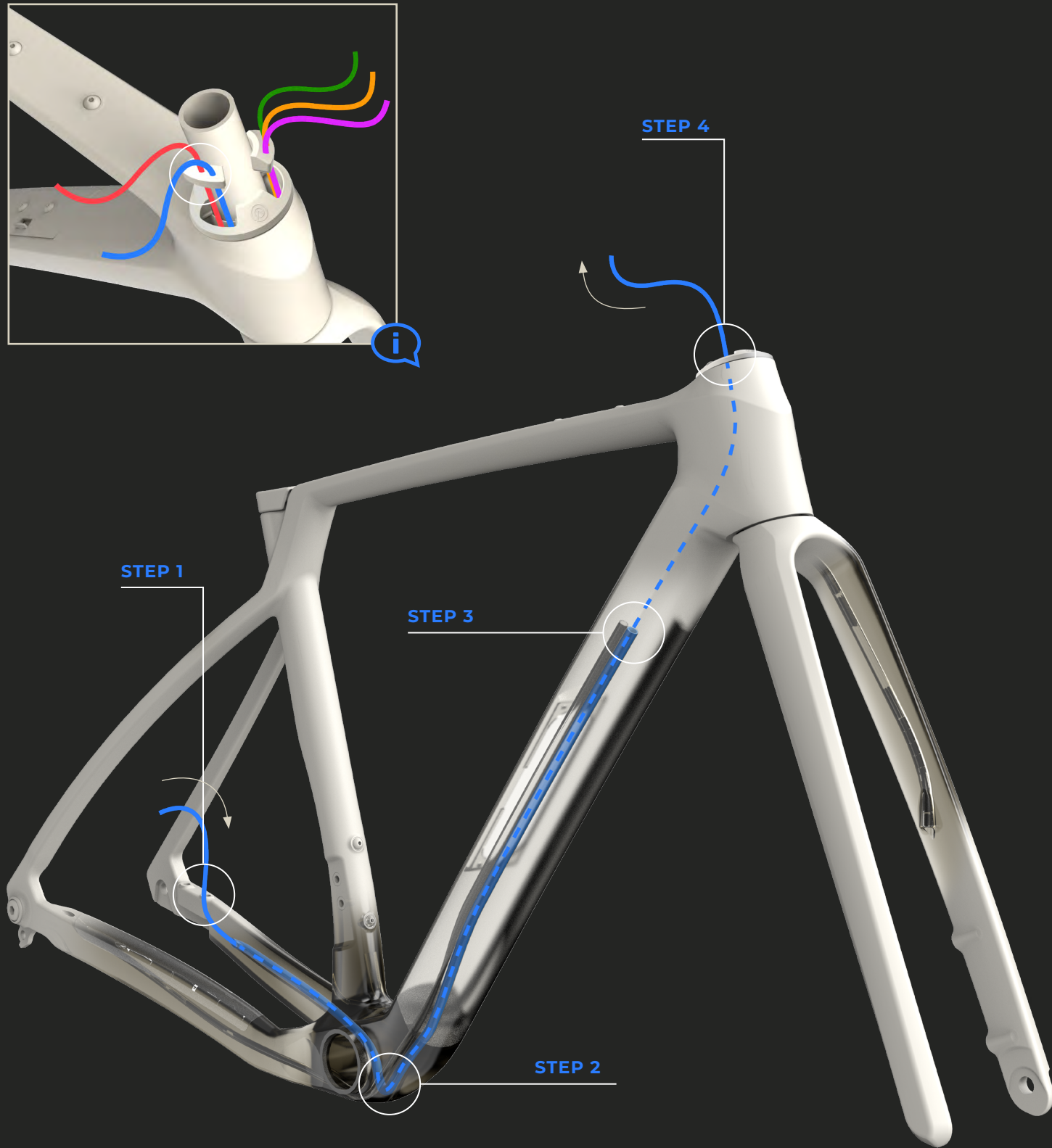

LEGEND

- Rear brake housing
- Housing outside the frame
- Housing inside the frame

CABLE ROUTING



REAR BRAKE HOUSING

STEP 1 | Insert the rear brake housing through the guide located on the top of the chainstay, on the left side.

STEP 2 | Route the rear brake housing through the frame using the straw.

STEP 3 | Pull the housing out through the head tube.

STEP 4 | Make sure to route the housing through the right cavity of the headset.

 The rear brake housing must occupy the upper cavity of the rubber guide to be installed on the headset. Make sure the housings remain parallel throughout the process to prevent friction with the fork.

CABLE ROUTING

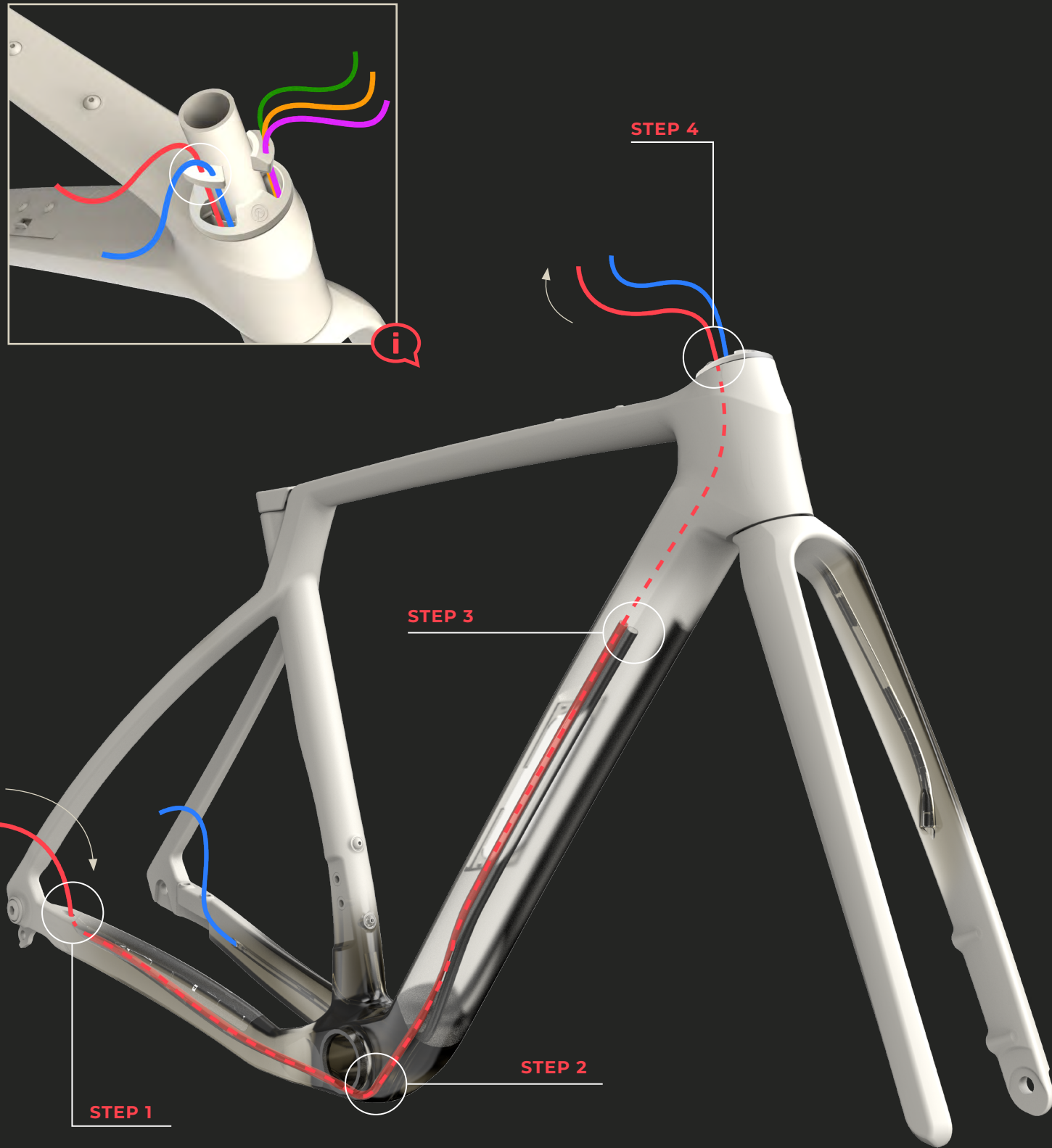

REAR DERAILLEUR HOUSING

STEP 1 | Insert the rear derailleur housing through the cavity located on the upper right surface of the chainstay.



STEP 2 | Route the rear derailleur housing through the frame using the straw.

STEP 3 | Pull the housing out through the head tube.

STEP 4 | Make sure to route the housing through the right cavity of the headset.

i The rear derailleur housing must occupy the lower cavity of the rubber guide to be installed on the headset. Ensure the housings remain parallel throughout the process to prevent friction with the fork.

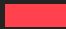
LEGEND

-  Rear derailleur housing
-  Housing outside the frame
-  Housing inside the frame

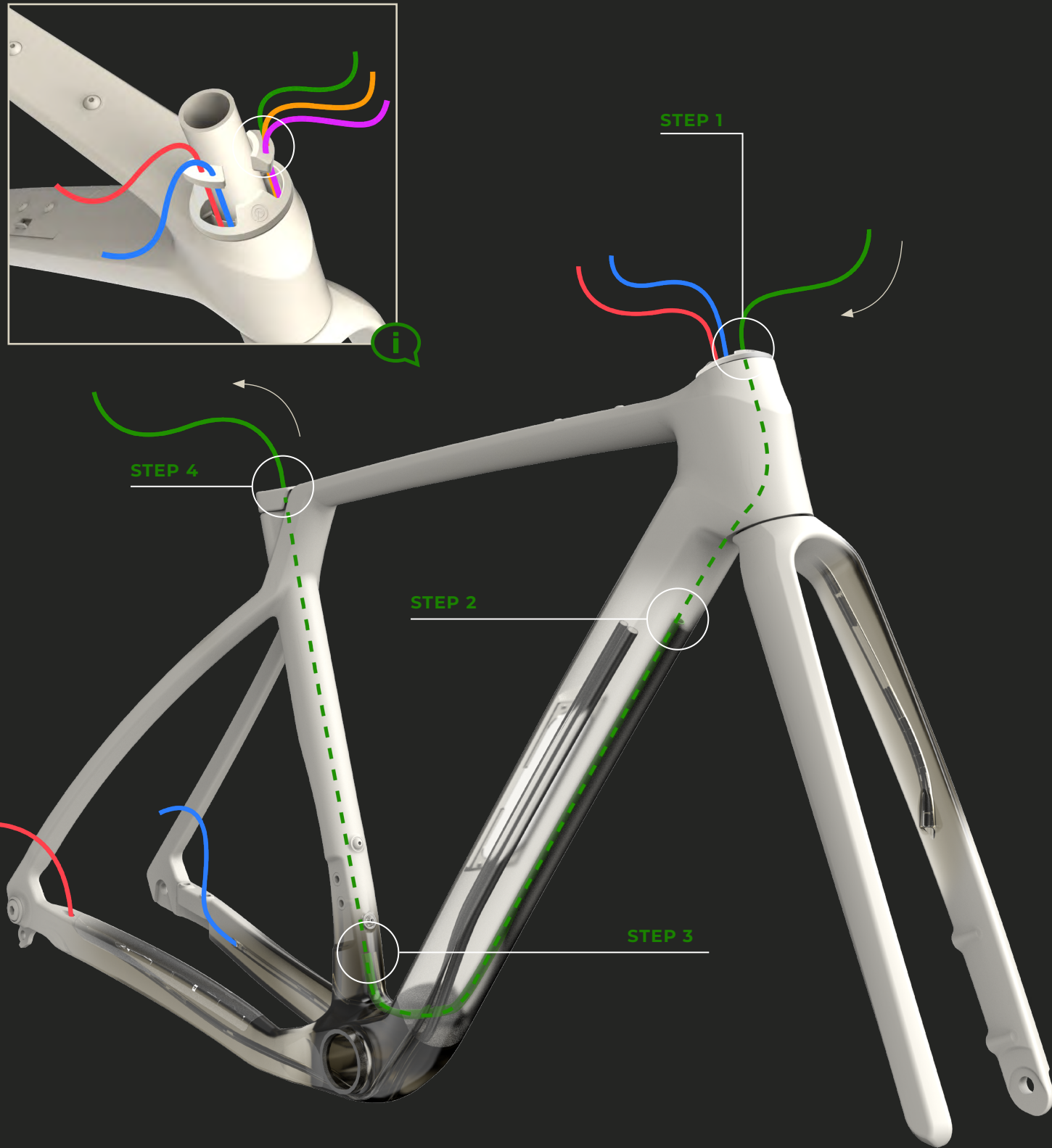

LEGEND

- Seatpost housing
- Housing outside the frame
- Housing inside the frame

CABLE ROUTING



SEATPOST HOUSING

STEP 1 | Insert the seatpost housing into the head tube through the cavity located on the left side.

 The seatpost housing must occupy the lower (smaller) cavity of the left rubber guide to be installed on the headset. Ensure the housings remain parallel throughout the process to prevent friction with the fork.

STEP 2 | Slide the seatpost housing into the upper left straw located in the downtube.

STEP 3 | Gently slide the housing through the straw.

STEP 4 | Pull the housing out of the frame through the seat tube.

CABLE ROUTING

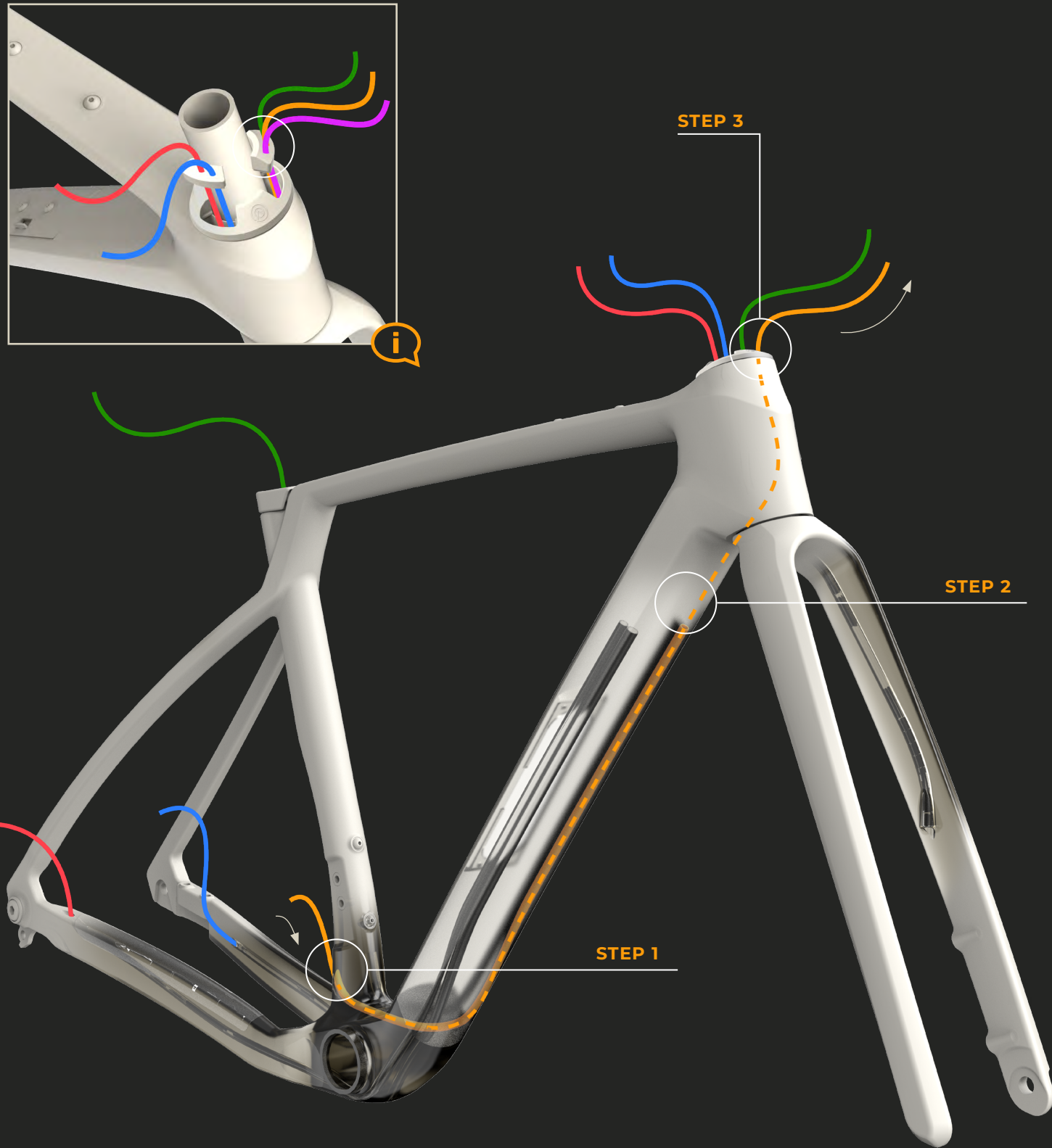

FRONT DERAILLEUR HOUSING

STEP 1 | Insert the front derailleur housing into the downtube through the cavity located at the bottom of the seat tube, just above the bottom bracket.

STEP 2 | Slide the front derailleur housing into the downtube through the designated straw.

STEP 3 | Pull the housing out through the left cavity of the headset.

i The front derailleur housing must occupy the central cavity of the left rubber guide to be installed on the headset. Ensure the housings remain parallel throughout the process to prevent friction with the fork.

LEGEND

- Seatpost housing
- Housing outside the frame
- Housing inside the frame

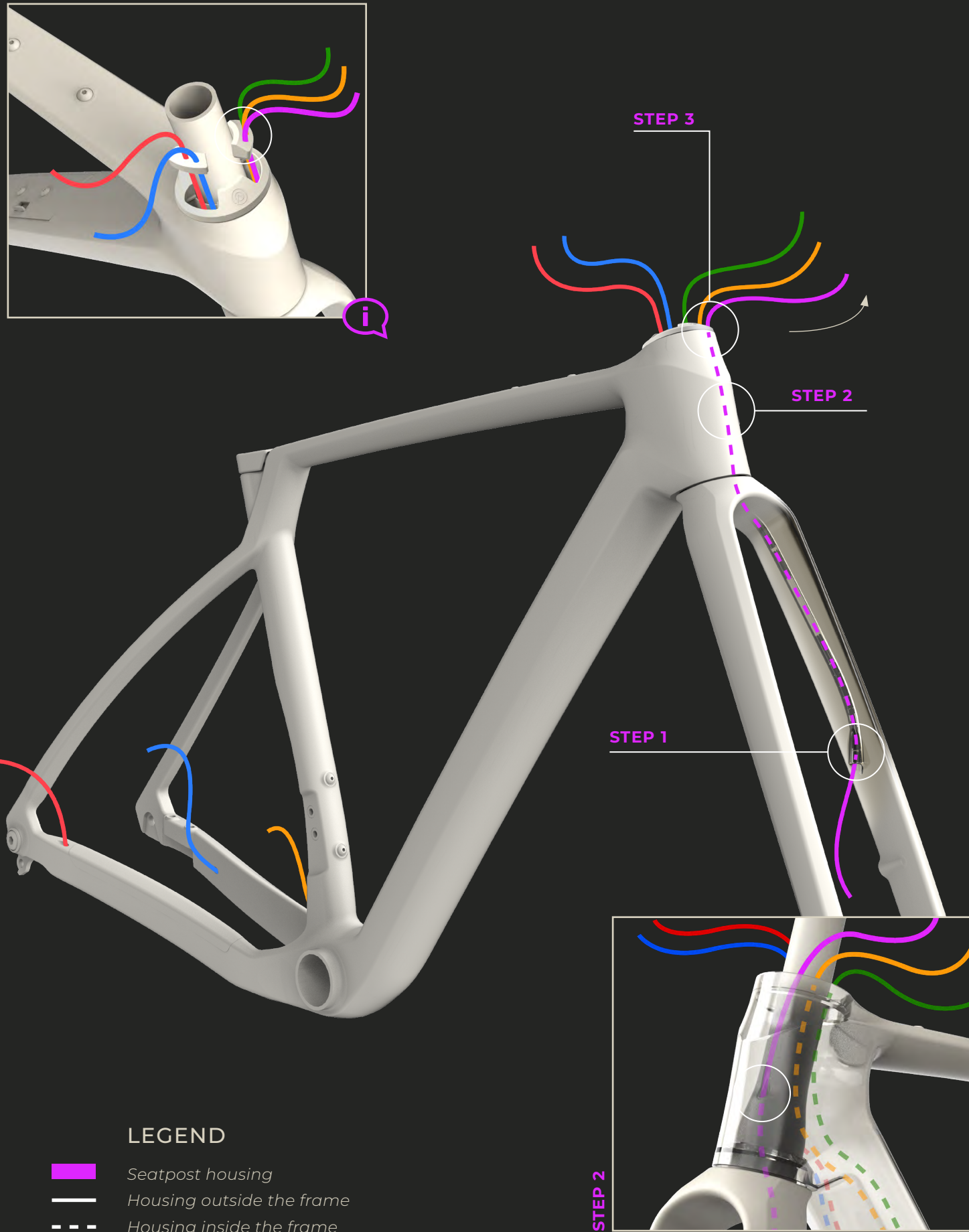

CABLE ROUTING

FRONT BRAKE HOUSING

STEP 1 | Insert the housing through the left cavity at the bottom of the fork.

STEP 2 | Insert the front brake housing into the fork through the straw.

STEP 3 | Pull the front brake housing out through the left cavity of the headset.

i The front brake housing must occupy the upper cavity of the left rubber guide to be installed on the headset. Ensure the housings remain parallel throughout the process to prevent friction with the fork.



CABLE ROUTING OVERVIEW

LEGEND

-  Rear brake housing
-  Rear derailleur housing
-  Seatpost housing
-  Front brake housing
-  Front derailleur housing
-  Routing outside the frame
-  Routing inside the frame

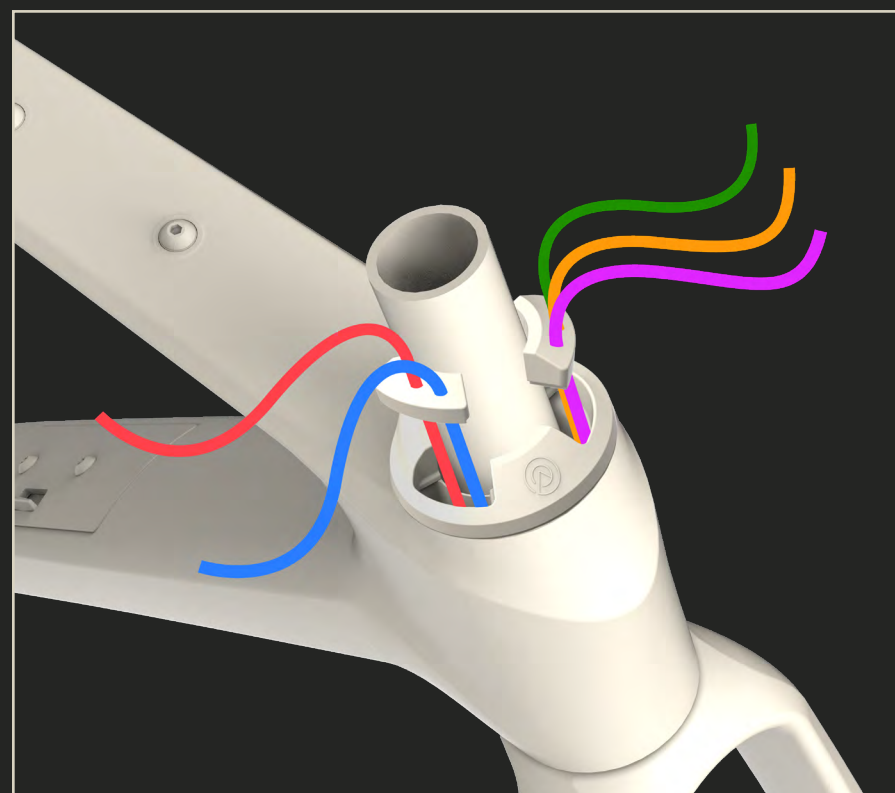

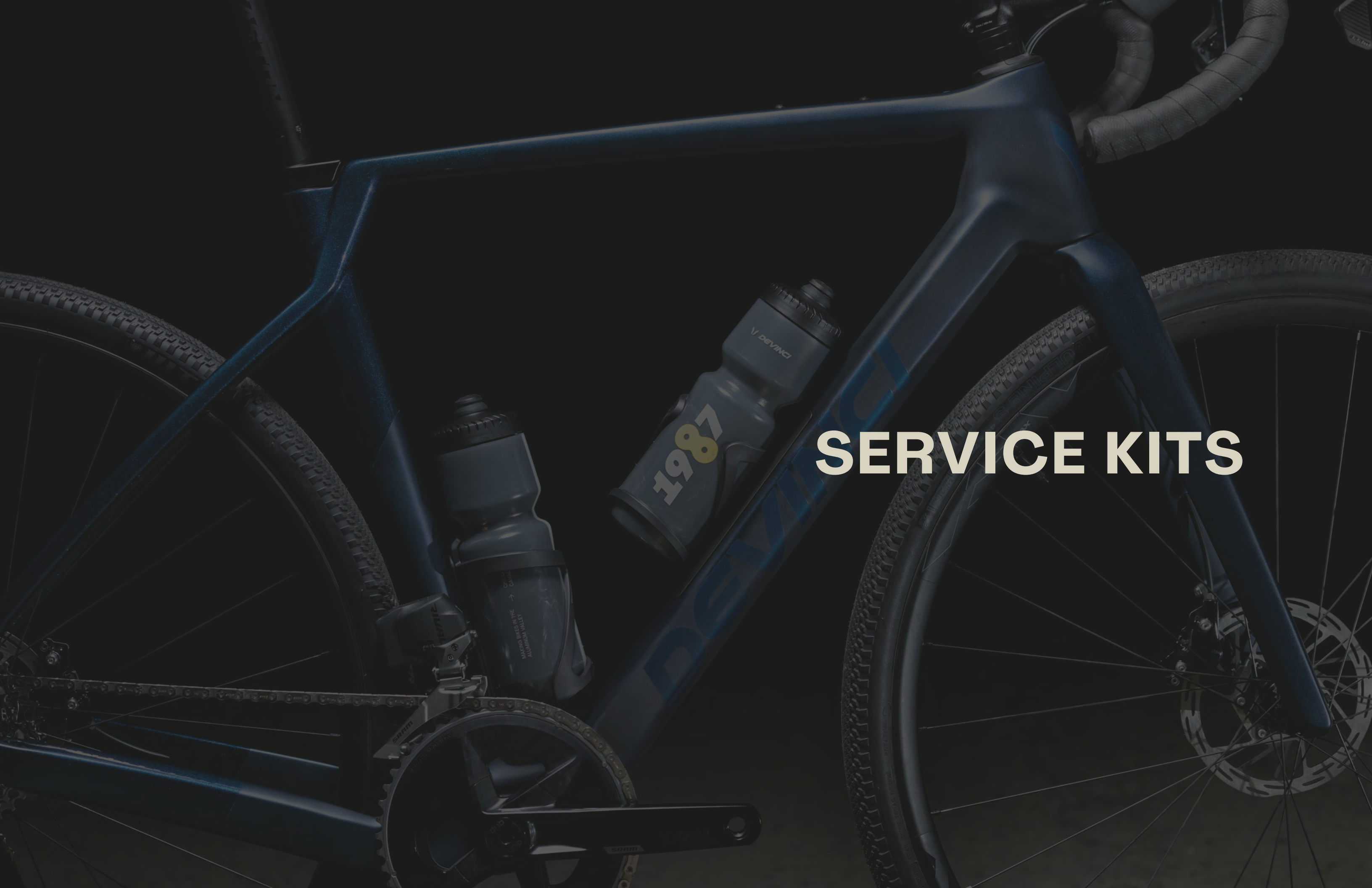

SERVICE KITS

KFC07801 | HEADSET

ITEMS	PART #	DESCRIPTION	QTY
1	MAAH24003	Head set Accros AIF-557	1

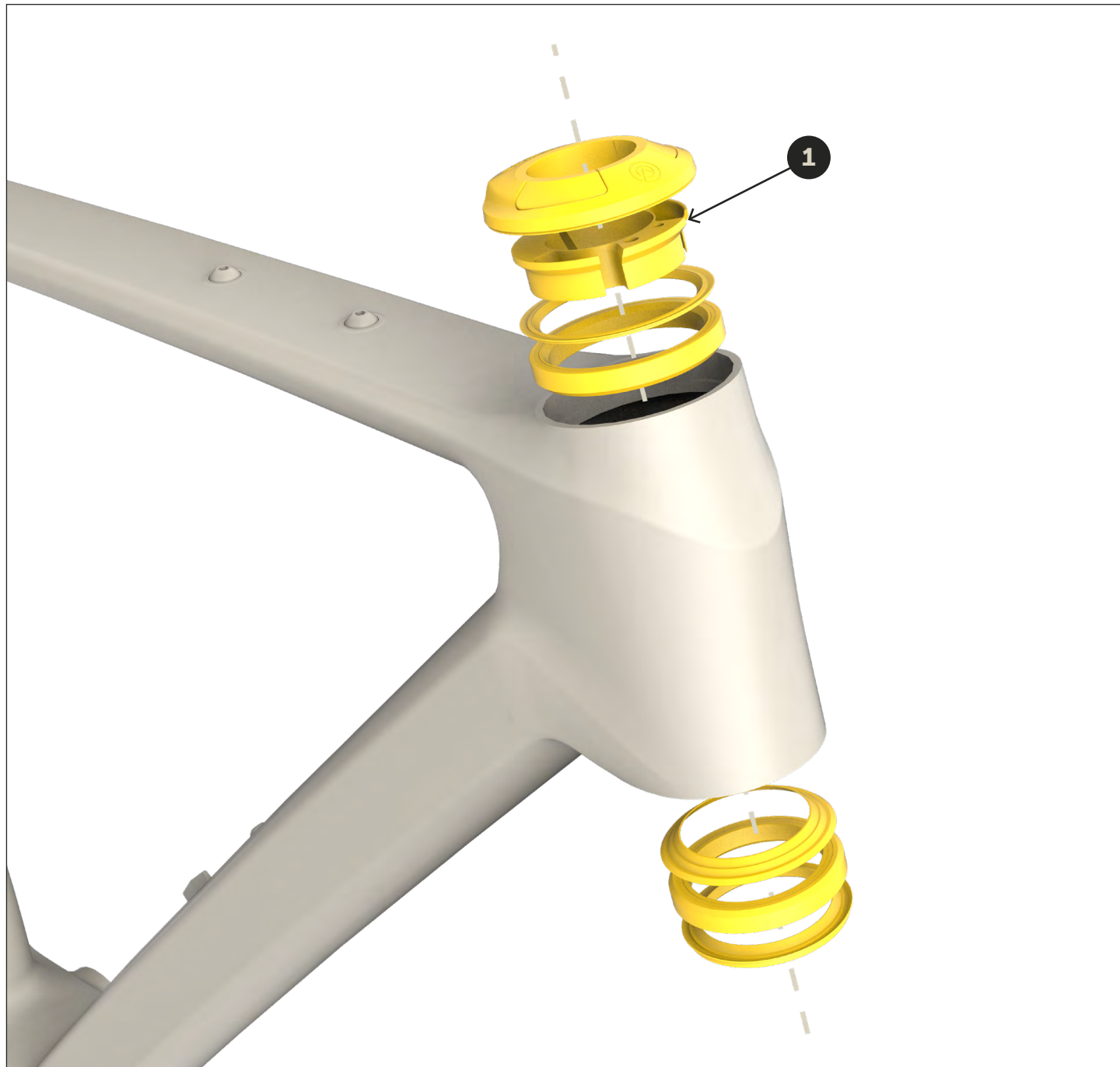

KFC07802 | SEATCLAMP

ITEMS	PART #	DESCRIPTION	QTY
1	MASC24001	Seat Clamp	1

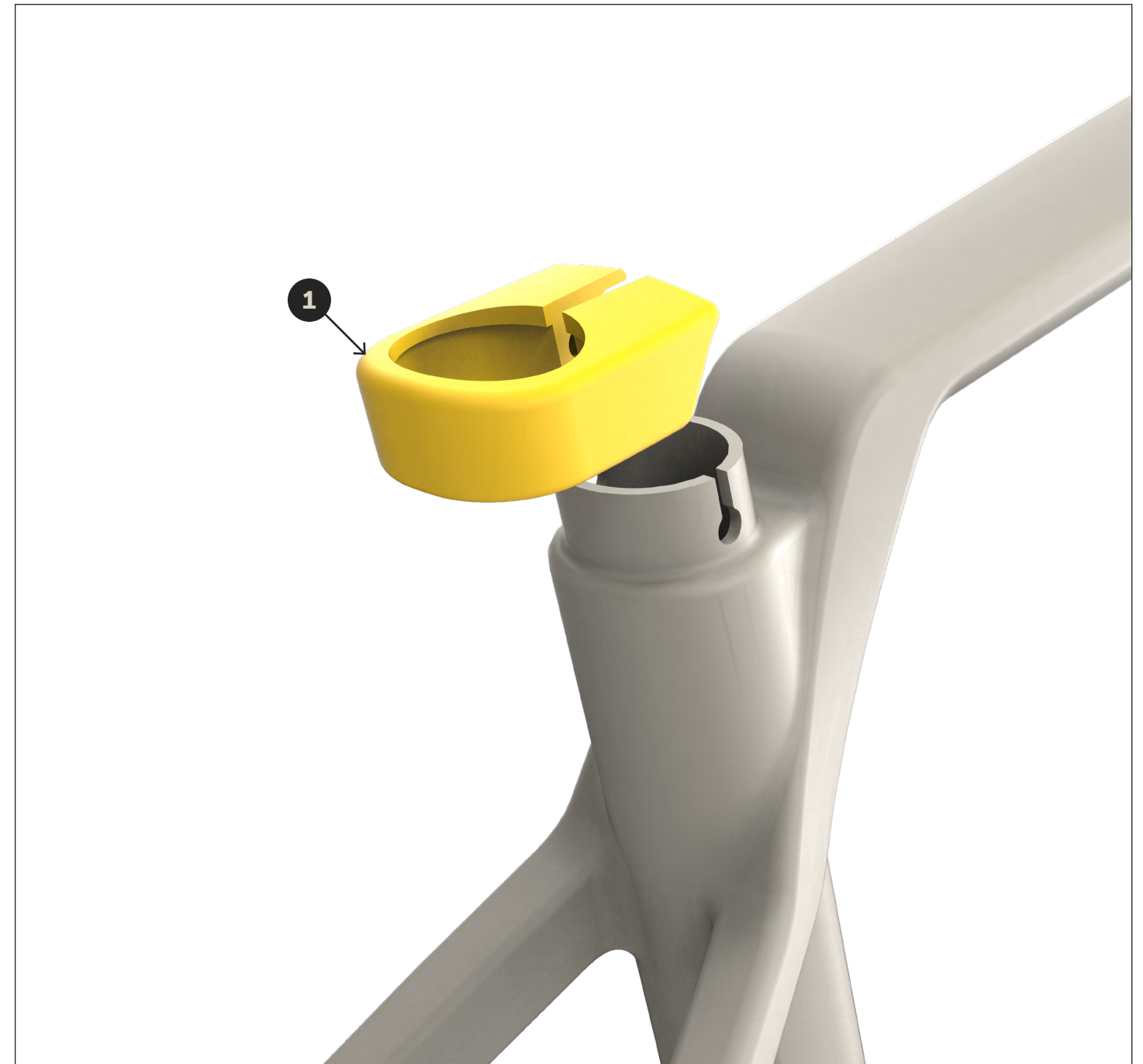

KFC07803 | PROTECTORS

ITEMS	PART #	DESCRIPTION	QTY
1	MACP24006	FD Hanger Cover Open Road	1
2	MACP24007	CS Protecteur Vinyl Clear	1

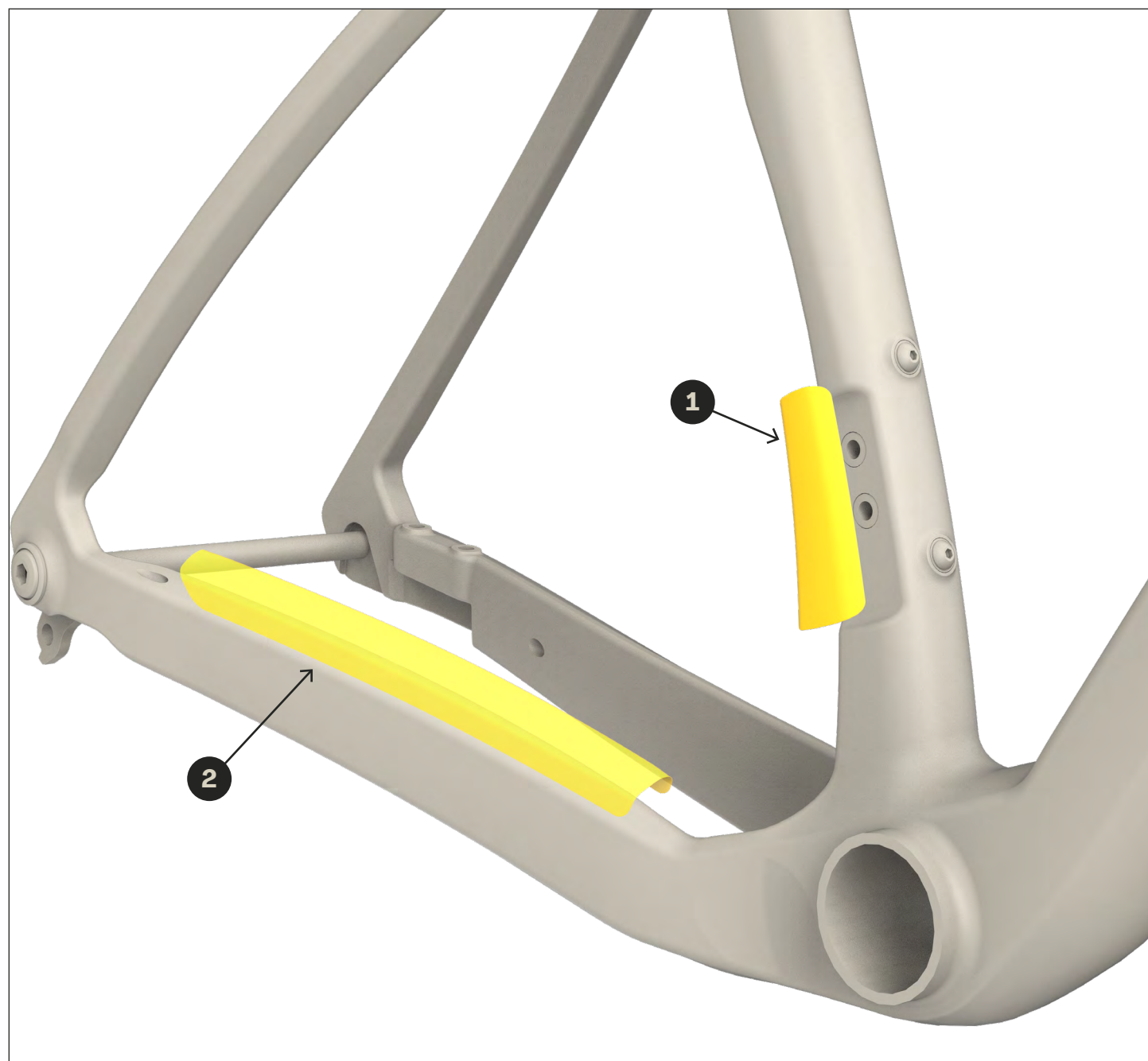
KFC07804 | AXLES

ITEMS	PART #	DESCRIPTION	QTY
1	MAAX24001	Front Thru Axle M12x1.0x100mm (118.5)	1
2	MAAX24003	Rear Thru Axle M12x1.0x165.5mm UDH	1



KFC07805 | FRONT DERAILLEUR HANGER

ITEMS	PART #	DESCRIPTION	QTY
1	MFD21005	<i>FD Hanger Open Road</i>	1



KFC07806 | UNIVERSAL DERAILLEUR HANGER

ITEMS	PART #	DESCRIPTION	QTY
1	MFD23003	<i>UDH Hanger w/25mm washer</i>	1

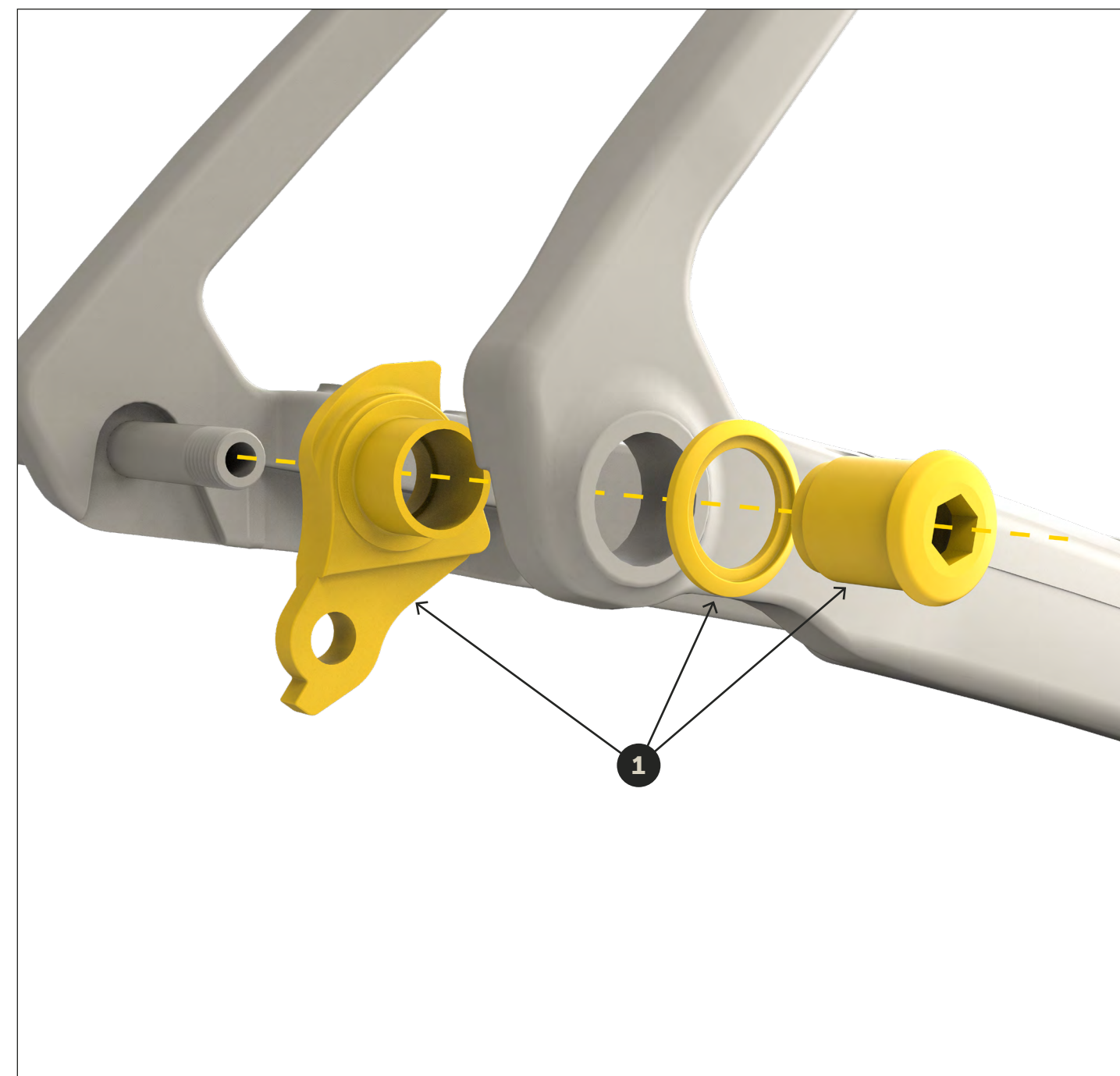



Head Office

1555 Manic
Chicoutimi (Quebec) Canada
G7K 1G8

www.devinci.com
