

WE MAKE RIDERS

CHICOUTIMI, QUÉBEC



CARBON



TECHNICAL MANUAL

HATCHET PRO 2025+

DEVINCI



ABOUT OUR MANUALS

Like many sports, cycling involves risk of injury and accidents, so you must be fully aware of these risks. Neither the manufacturer, the retailer, nor the person who sold you the bike, nor the people who maintain the trails are responsible for these risks. As you are solely responsible, it is, therefore, essential that you read and fully understand all the parts contained in this manual.

To enjoy maximum safety and enjoyment right from the get go, it is important that you are familiar with your new bike, its handling and its possibilities. It is your duty to maintain your bike well and reduce the risk of injury. Biking can be a dangerous activity, even under the best conditions. These are risks associated with using a bicycle that cannot be predicted or avoided. These are the sole responsibility of the cyclist.

YOUR AUTHORIZED DEVINCI RETAILER

Your authorized Devinci retailer is at your service to guide your choices of bike and accessories which are best suited to the style of biking you wish to perform. This will help you maintain your equipment in good condition so that you can take full advantage of your investment. The staff at your authorized Devinci retailer have the training, experience and tools to carry out the repairs and provide you with reliable advice.

However, your authorized Devinci retailer cannot make decisions for you, and cannot be held responsible for your lack of knowledge, experience, qualification or common sense. However, it will take the necessary time to explain the operation of a component or to help you choose an accessory that meets your specific needs.

For further information, please see the Devinci's User Manual available on www.Devinci.com or ask your authorized Devinci retailer. He will take the time to answer any questions you may have and will advise you with great pleasure.





F R A M E

TECHNICAL SPECIFICATIONS

| HEADTUBE DIMENSIONS | | |
|--|--------------------------|----------------|
| 1. UPPER (S.H.I.S) | IS52 | 1.5" IS |
| 2. LOWER (S.H.I.S) | IS52 | 1.5" IS |
| BOTTOM BRACKET | | |
| 3. STANDARD | BB 386 EVO PF | |
| 4. FRONT DERAILLEUR MOUNT | BRAZE-ON | |
| 5. MINIMUM Q FACTOR | 148 mm | |
| FORK | | |
| 6. FRONT HUB SPACING (over locknut dimension) | TA 12x100 mm | |
| 7. STEERER TUBE DIMENSIONS (S.H.I.S.) | 28.6 40 | 1-1/8" to 1.5" |
| TRANSMISSION (1X) | | |
| 8. REAR HUB SPACING (over locknut dimension) | TA 12x142 mm | |
| 9. MAX. & MIN. CHAINRING | 46T | 38T |
| TRANSMISSION (2X) | | |
| 10. REAR HUB SPACING (over locknut dimension) | TA 12x142 mm | |
| 11. MAX. BIGGEST CHAINRING | 53T | |
| 12. SMALLEST CHAINRING MAX. & MIN. | 46T | 33T |
| TRANSMISSION | | |
| 13. SMALLEST COG COMPATIBLE | 10T | |
| 14. BIGGEST COG COMPATIBLE | 50T | |
| 15. RECOMMENDED CHAINLINE MIN. & MAX. | 44.5 mm | 47.5 mm |
| SEAT TUBE & SEAT CLAMP | | |
| 16. SEATPOST OUTSIDE DIAMETER | 27.2 mm | |
| 17. SEAT TUBE OUTSIDE DIAMETER | 31.8 mm | |
| 18. DROPPER POST COMPATIBLE | YES Fully Internal | |
| BRAKES | | |
| 19. BRAKE MOUNT (FRAME & FORK) | Flat Mount 160 mm direct | |
| 20. ROTOR MAX. & MIN. COMPATIBILITY (FRAME & FORK) | 160 mm | 180 mm |
| 21. BRAKE MOUNT THICKNESS (FORK) | 20 mm | |
| ACCESSORIES | | |
| 22. ROOM FOR A BOTTLE (FRAME) | YES 2 BOTTLES | |
| 23. STORAGE SYSTEM | YES SHED | |
| 24. REAR RACK & FENDER MOUNT | YES | |
| GEOMETRY INPUTS (BASED ON MEDIUM SIZE) | | |
| HATCHET PRO CARBON | | |
| 25. FORK (AXLE-TO-CROWN [A] & OFFSET [B]) | A. 395 | B. 50 |
| 26. FRONT & REAR WHEEL GEOMETRY | 708 | |
| 27. FRONT & REAR MAX ETRTO | 42-622 | |
| 28. TIRE CLEARANCE | 700c x 45 mm | |

***DISCLAIMER:** We are testing many different tires to establish a clearance number that cover a wide spectrum of tires with appropriate frame clearance. However, it is impossible for us to test all tires and rim combination available on the market, so be mindful that some combinations may result in slight rubbing if higher than 45mm in actual width.



i THE SHED STORAGE DOOR MUST BE SECURELY ENGAGED TO ENSURE PROPER ATTACHMENT TO THE DOWNTUBE.

A DISTINCT 'CLICK' WILL CONFIRM THAT IT IS LOCKED ONTO THE INNER SURFACE OF THE DOWNTUBE.

BEFORE EACH RIDE, MAKE SURE THE LATCH IS CORRECTLY ENGAGED (AS SHOWN IN IMAGE 2).

A close-up, low-angle shot of a bicycle handlebar and stem. The handlebar is wrapped in grey tape and features a Shimano ST-RM700 trigger shifter on the left. The stem is blue with a white logo. The background is dark and out of focus. The text 'CABLE ROUTING' is overlaid in white, bold, sans-serif font.

CABLE
ROUTING

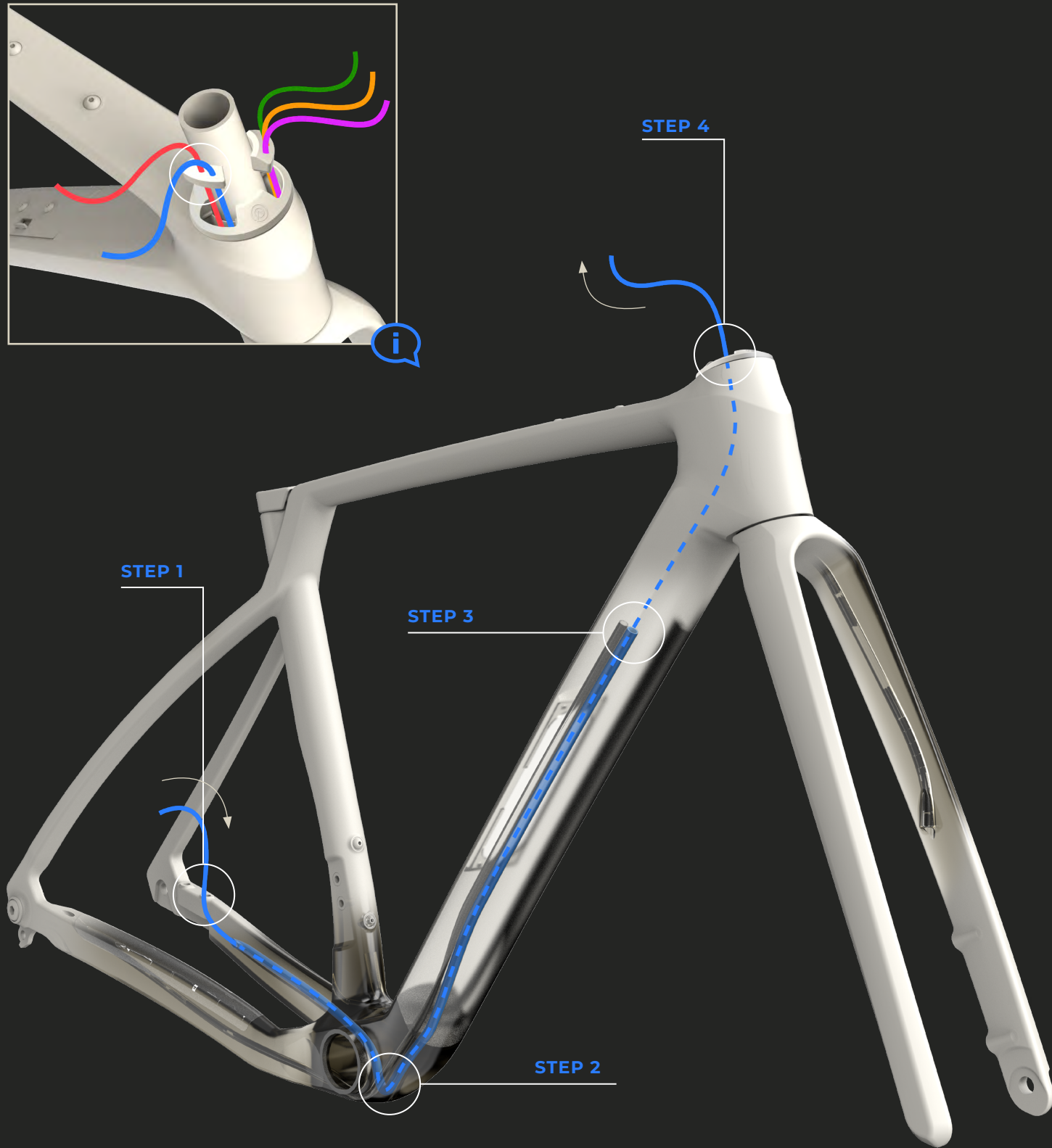

LEGEND

- █ Rear brake housing
- Housing outside the frame
- - - Housing inside the frame

CABLE ROUTING

REAR BRAKE HOUSING

STEP 1 | Insert the rear brake housing through the guide located on the top of the chainstay, on the left side.

STEP 2 | Route the rear brake housing through the frame using the straw.

STEP 3 | Pull the housing out through the head tube.

STEP 4 | Make sure to route the housing through the right cavity of the headset.

 The rear brake housing must occupy the upper cavity of the rubber guide to be installed on the headset. Make sure the housings remain parallel throughout the process to prevent friction with the fork.

CABLE ROUTING

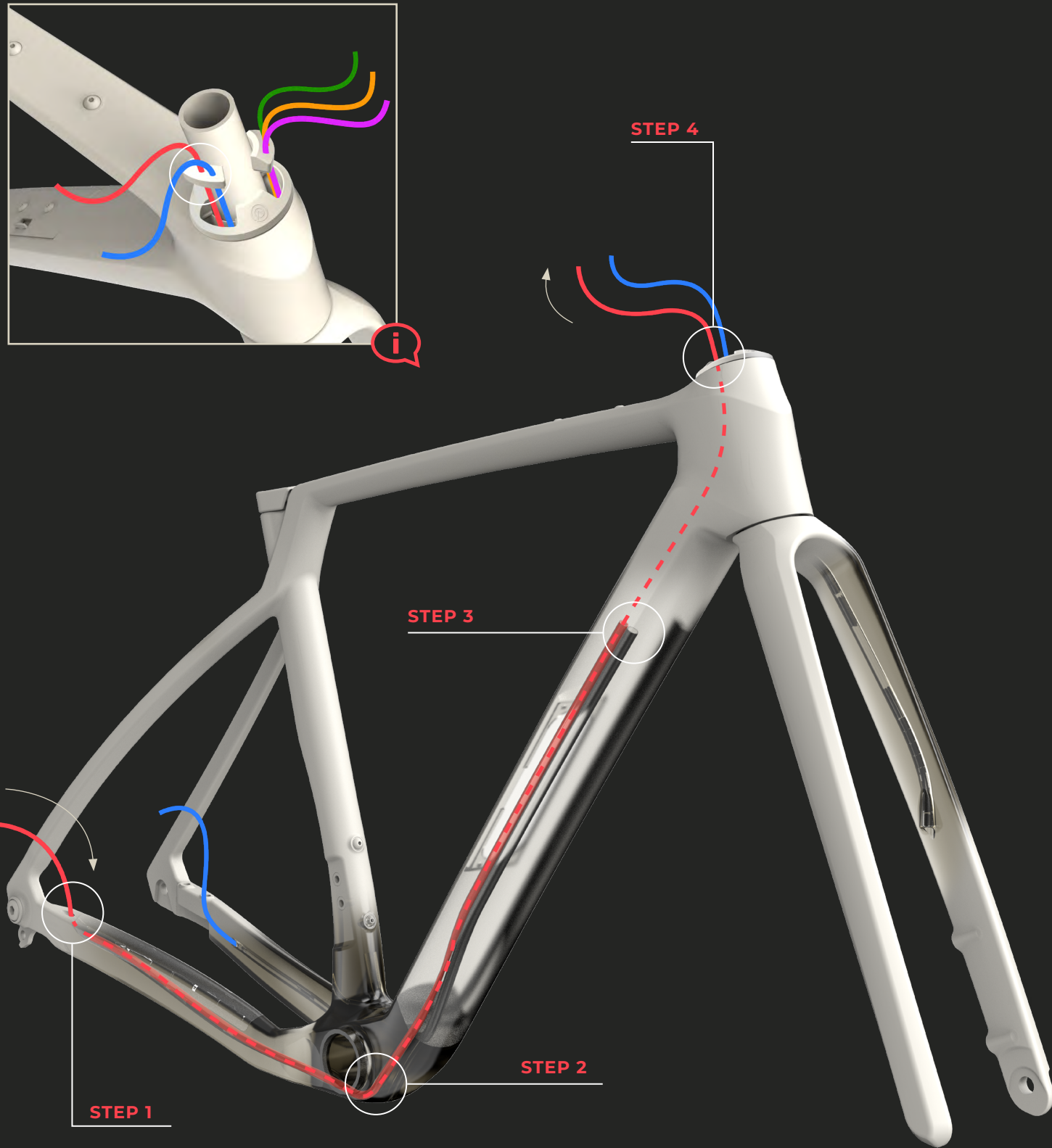

REAR DERAILLEUR HOUSING

STEP 1 | Insert the rear derailleur housing through the cavity located on the upper right surface of the chainstay.

STEP 2 | Route the rear derailleur housing through the frame using the straw.

STEP 3 | Pull the housing out through the head tube.

STEP 4 | Make sure to route the housing through the right cavity of the headset.

i The rear derailleur housing must occupy the lower cavity of the rubber guide to be installed on the headset. Ensure the housings remain parallel throughout the process to prevent friction with the fork.

LEGEND

- Rear derailleur housing
- Housing outside the frame
- Housing inside the frame

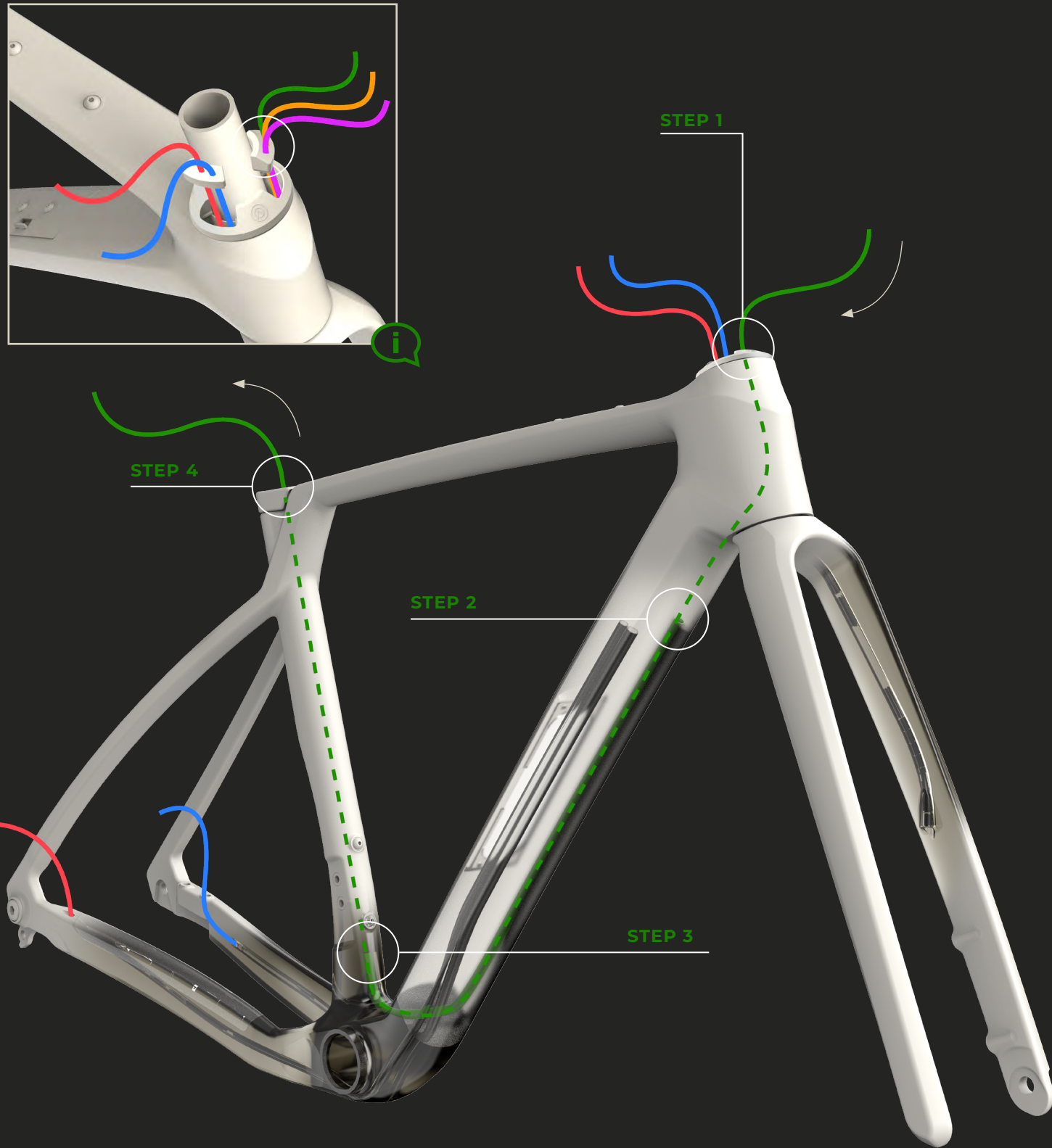

LEGEND

- Seatpost housing
- Housing outside the frame
- Housing inside the frame

CABLE ROUTING

SEATPOST HOUSING

STEP 1 | Insert the seatpost housing into the head tube through the cavity located on the left side.

 The seatpost housing must occupy the lower (smaller) cavity of the left rubber guide to be installed on the headset. Ensure the housings remain parallel throughout the process to prevent friction with the fork.

STEP 2 | Slide the seatpost housing into the upper left straw located in the down tube.

STEP 3 | Gently slide the housing through the straw.

STEP 4 | Pull the housing out of the frame through the seat tube.

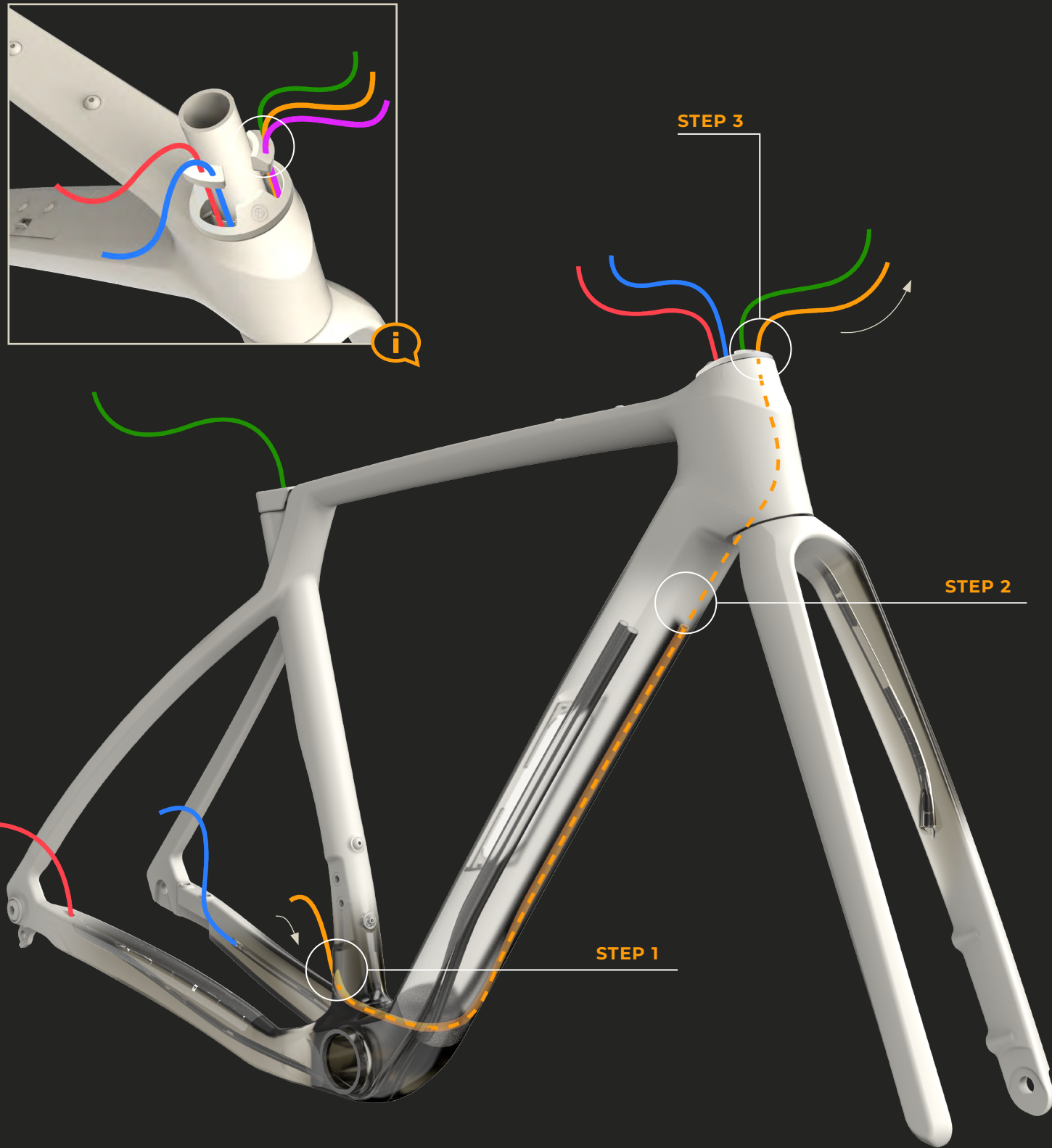

LEGEND

- Seatpost housing
- Housing outside the frame
- Housing inside the frame

CABLE ROUTING

FRONT DERAILLEUR HOUSING

- STEP 1** | Insert the front derailleur housing into the downtube through the cavity located at the bottom of the seat tube, just above the bottom bracket.
- STEP 2** | Slide the front derailleur housing into the downtube through the designated straw.
- STEP 3** | Pull the housing out through the left cavity of the headset.

i The front derailleur housing must occupy the central cavity of the left rubber guide to be installed on the headset. Ensure the housings remain parallel throughout the process to prevent friction with the fork.

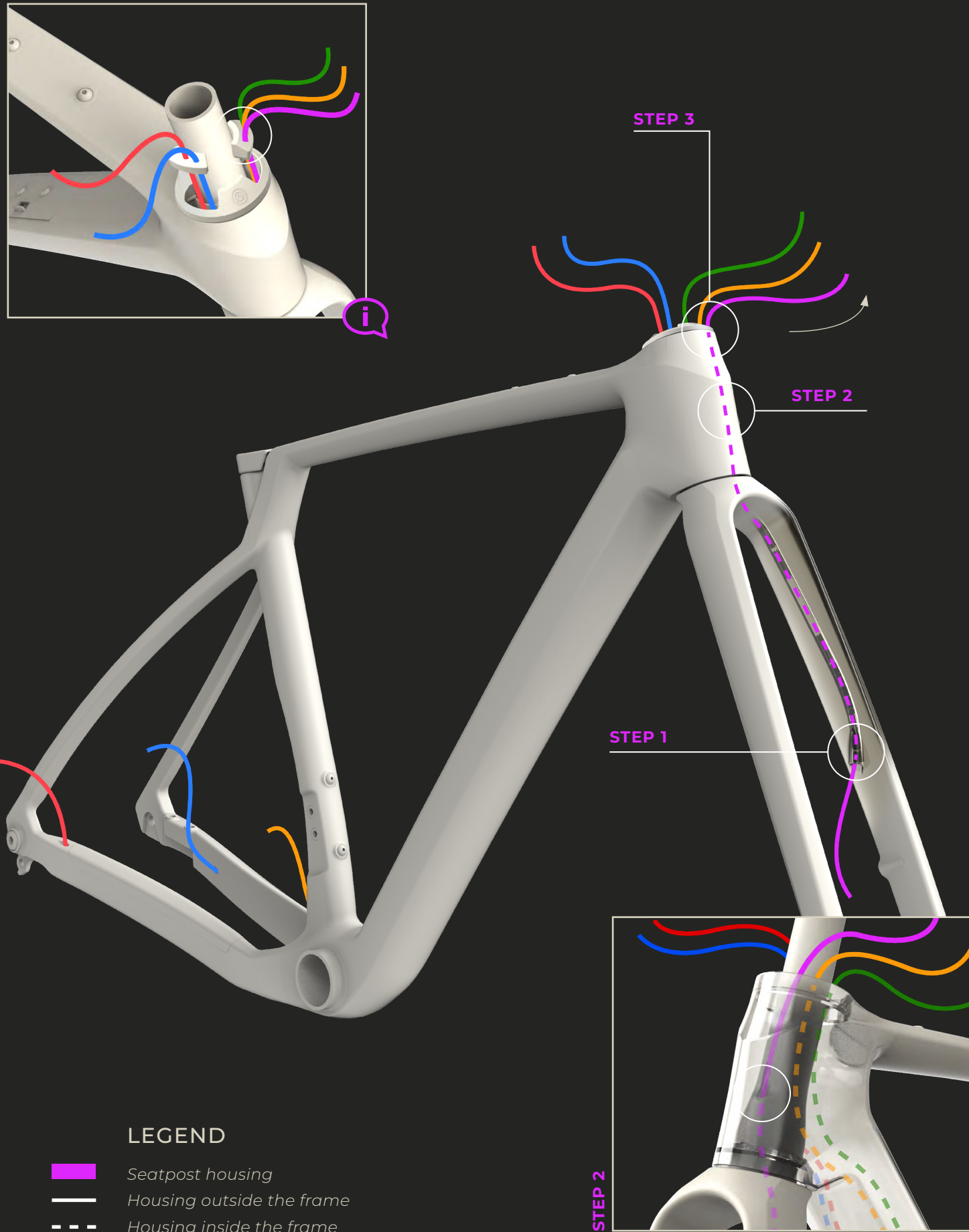

LEGEND

- Seatpost housing
- Housing outside the frame
- Housing inside the frame

CABLE ROUTING

FRONT BRAKE HOUSING

STEP 1 | Insert the housing through the left cavity at the bottom of the fork.

STEP 2 | Insert the front brake housing into the fork through the straw.





STEP 3 | Pull the front brake housing out through the left cavity of the headset.

i The front brake housing must occupy the upper cavity of the left rubber guide to be installed on the headset. Ensure the housings remain parallel throughout the process to prevent friction with the fork.

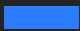

CABLE ROUTING OVERVIEW

LEGEND

-  Rear brake housing
-  Rear derailleur housing
-  Seatpost housing
-  Front brake housing
-  Front derailleur housing
-  Routing outside the frame
-  Routing inside the frame

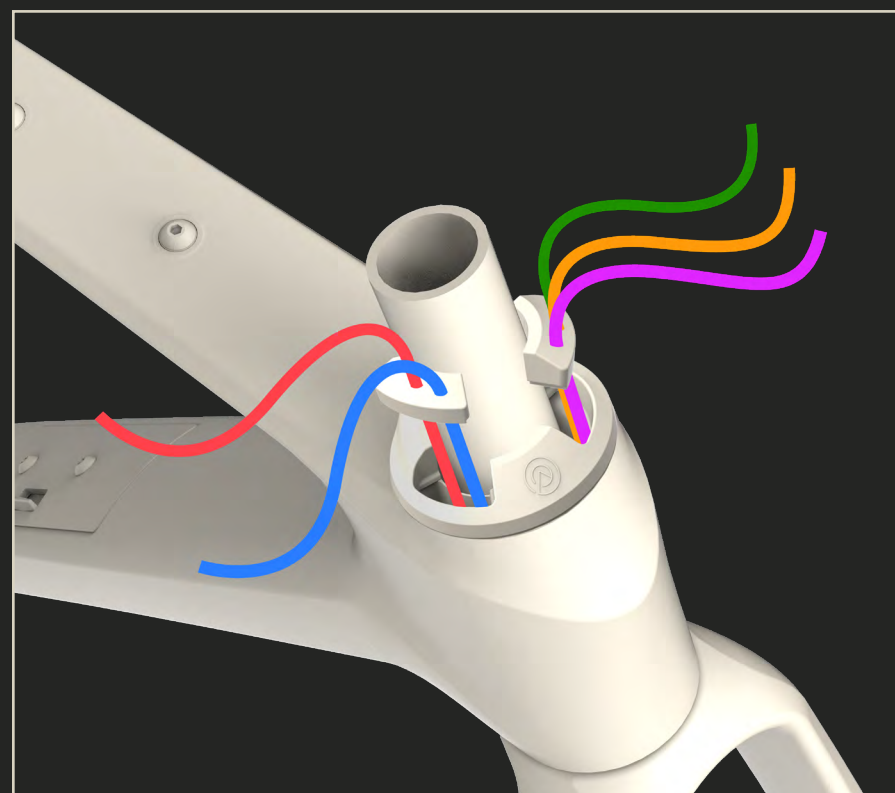

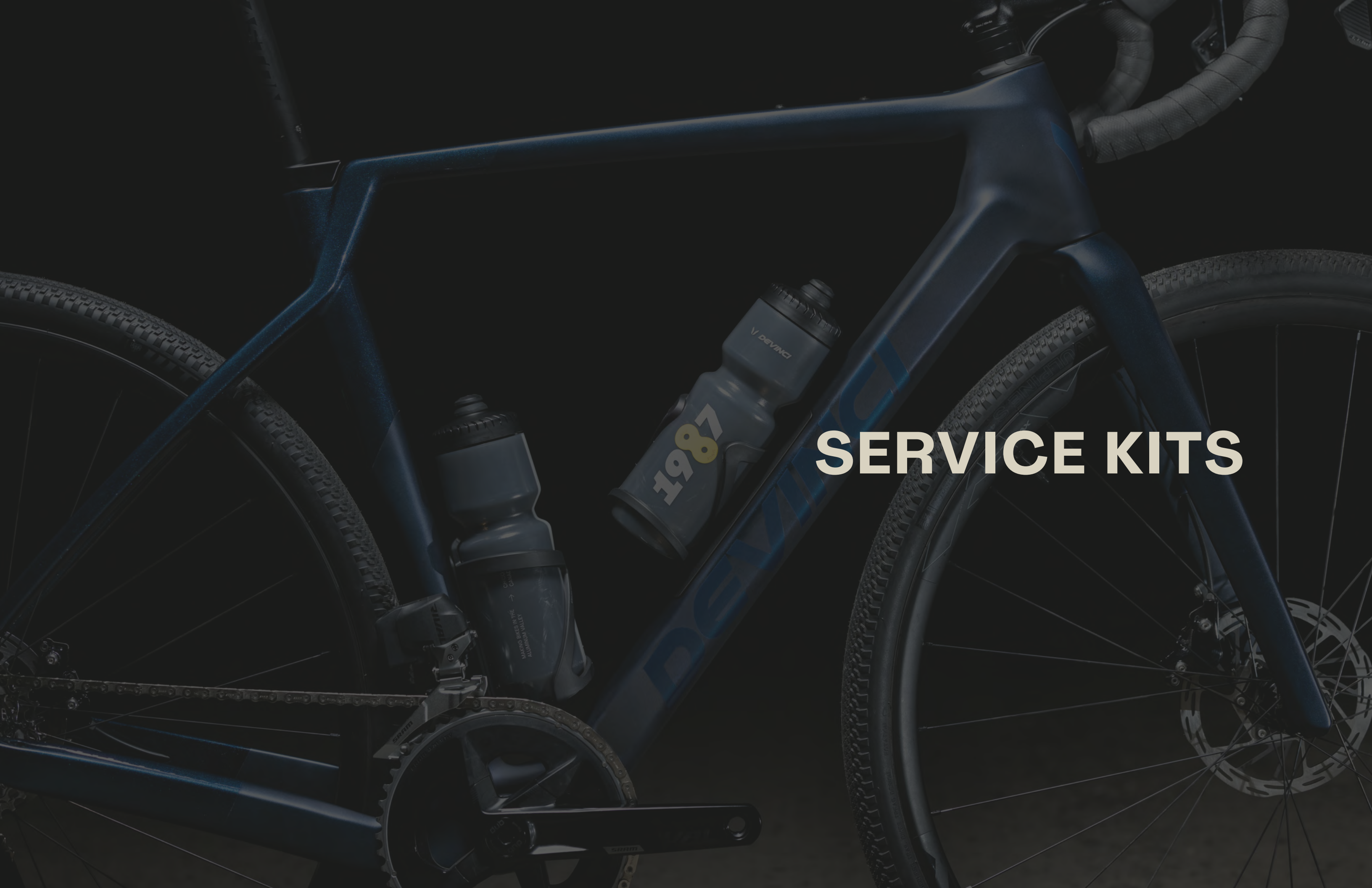

SERVICE KITS

KFC07801 | HEADSET

| ITEMS | PART # | DESCRIPTION | QTY |
|-------|-----------|-------------------------|-----|
| 1 | MAAH24003 | Head set Accros AIF-557 | 1 |

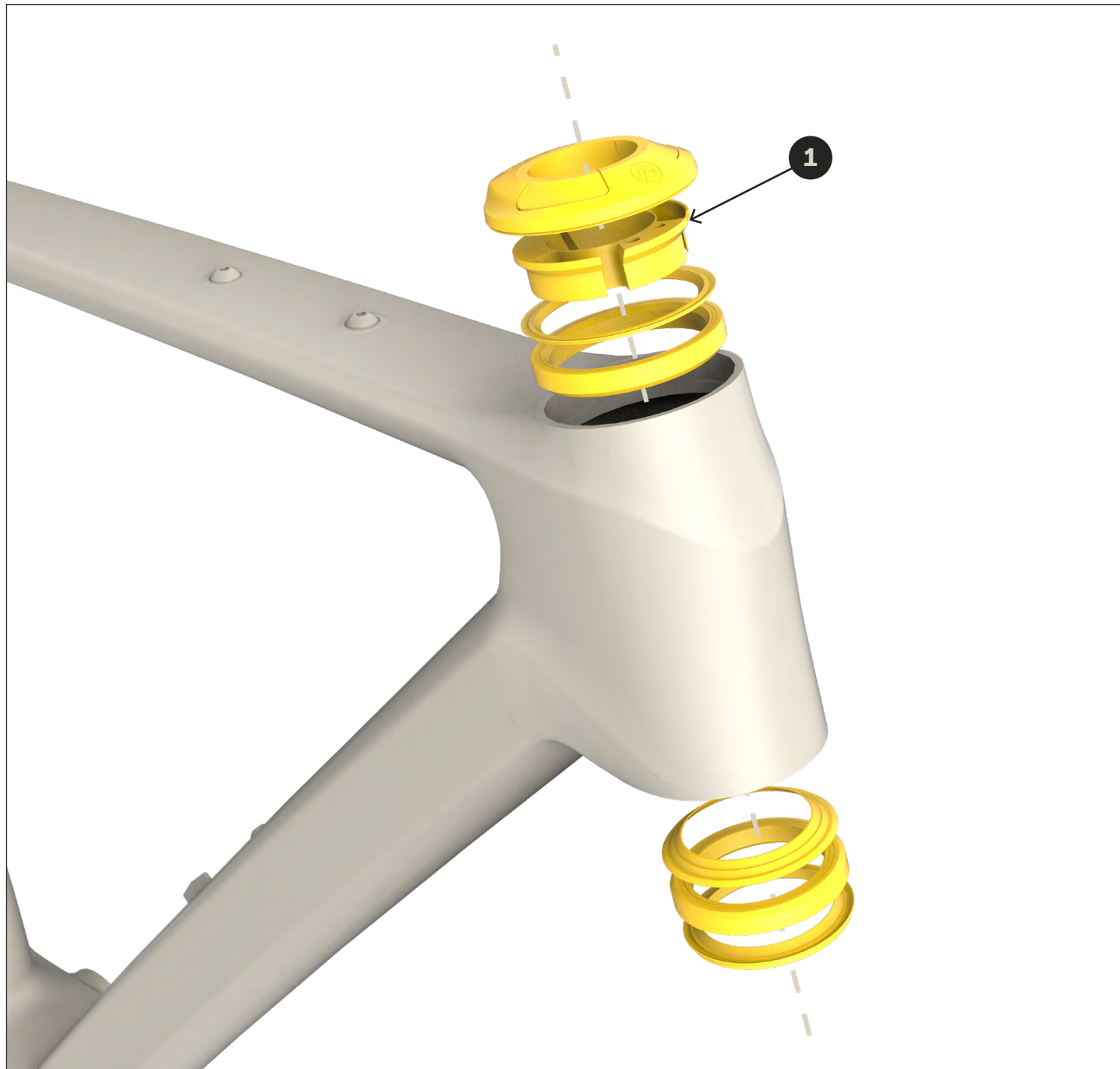
KFC07802 | SEATCLAMP

| ITEMS | PART # | DESCRIPTION | QTY |
|-------|-----------|-------------|-----|
| 1 | MASC24001 | Seat Clamp | 1 |

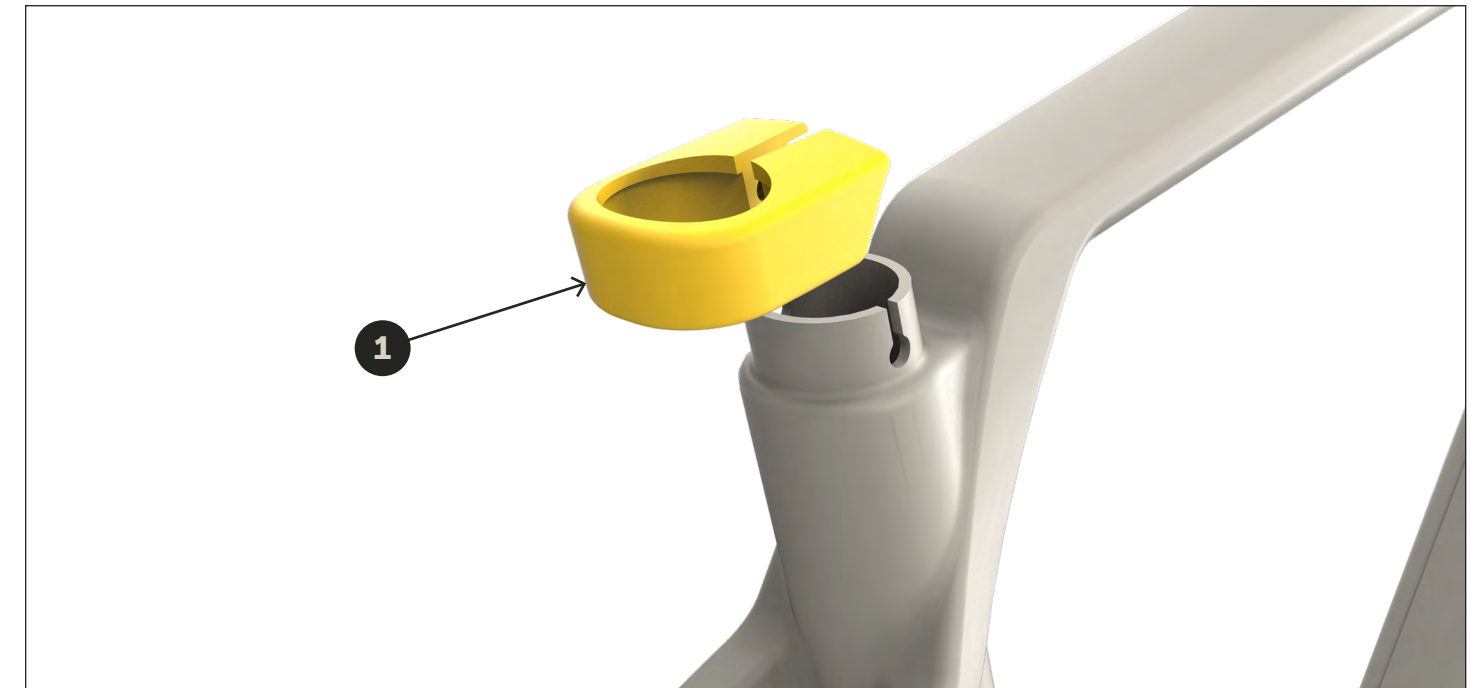

SERVICE PART - ROBERT AXLE PROJECT AVAILABLE AT [ROBERTAXLEPROJECT.COM](https://robertaxleproject.com)

| IDENTIFICATION | SPECIFICATIONS |
|---|---|
| 12MM THRU AXLE FOR TRAINER  | 160 to 172mm with 1.0 Thread The true length of the axle shaft is 172 mm, but can be shortened using the included spacers – a flat spacer and a tapered X-12 spacer. This allows for axle lengths of 162, 167 or 172 mm. Please note: Thru-axle lengths do not equal hub standards. An axle has to be longer than the hub to fit in the frame. A 12x142 hub does not equal a 142 mm long axle. SKU: TRA213 |
| 12MM THRU AXLE FOR KID TRAILER  | The true length of the axle shaft is 172 mm, but can be shortened using the included spacers – a flat 5 mm spacer and a tapered 5 mm X-12 spacer. This allows for axle lengths of 162, 167, or 172 mm. Please note: Thru-axle lengths do not equal hub standards. An axle has to be longer than the hub to fit in the frame. A 12x142(+) hub does not equal a 142mm long axle. SKU: KID213 |

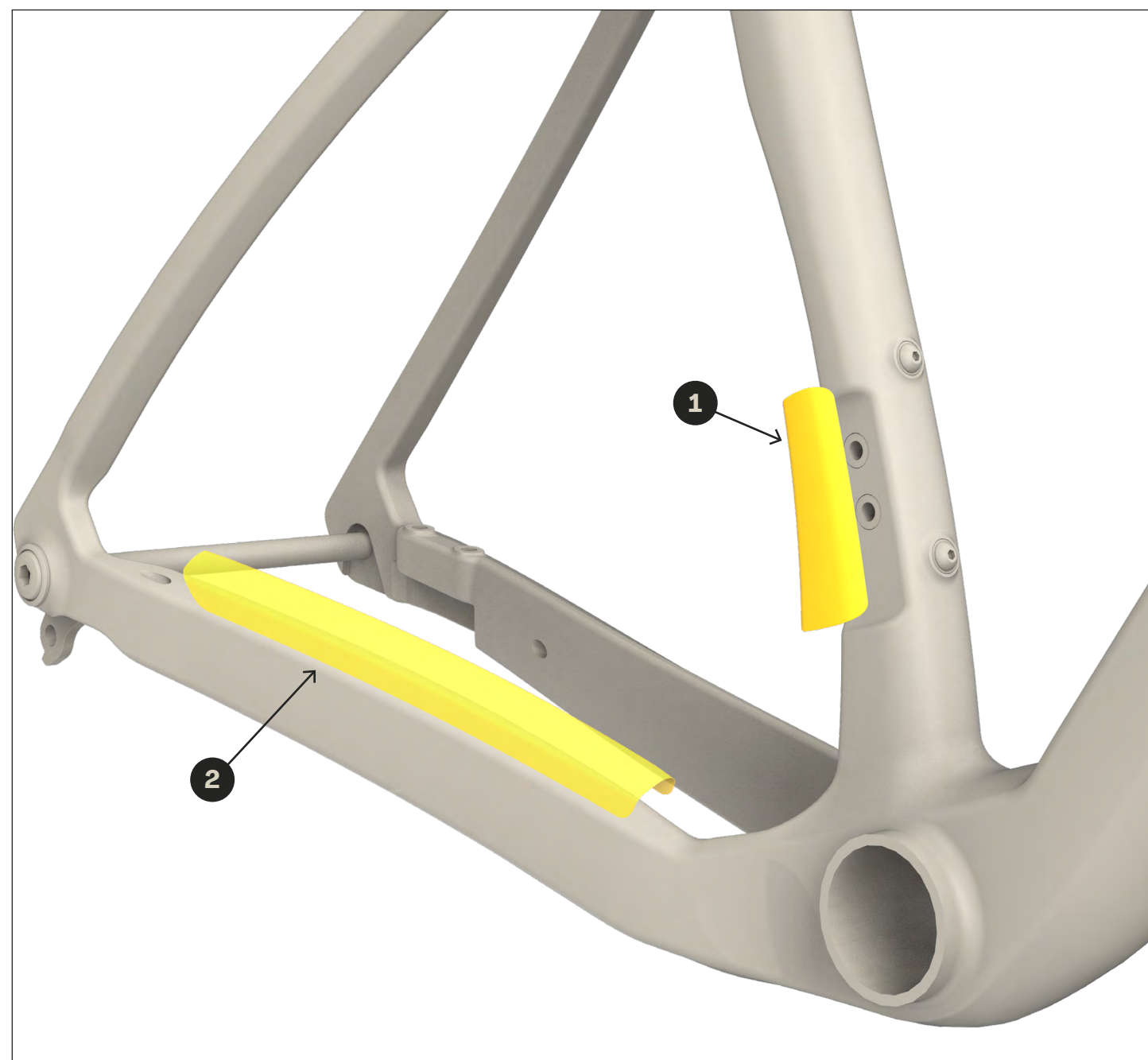

KFC07803 | PROTECTORS

| ITEMS | PART # | DESCRIPTION | QTY |
|-------|-----------|---------------------------|-----|
| 1 | MACP24006 | FD Hanger Cover Open Road | 1 |
| 2 | MACP24007 | CS Protecteur Vinyl Clear | 1 |



KFC07804 | AXLES

| ITEMS | PART # | DESCRIPTION | QTY |
|-------|-----------|---------------------------------------|-----|
| 1 | MAAX24001 | Front Thru Axle M12x1.0x100mm (118.5) | 1 |
| 2 | MAAX24003 | Rear Thru Axle M12x1.0x165.5mm UDH | 1 |





KFC07805 | FRONT DERAILLEUR HANGER

| ITEMS | PART # | DESCRIPTION | QTY |
|-------|----------|---------------------|-----|
| 1 | MFD21005 | FD Hanger Open Road | 1 |



KFC07806 | UNIVERSAL DERAILLEUR HANGER

| ITEMS | PART # | DESCRIPTION | QTY |
|-------|----------|--------------------------|-----|
| 1 | MFD23003 | UDH Hanger w/25mm washer | 1 |

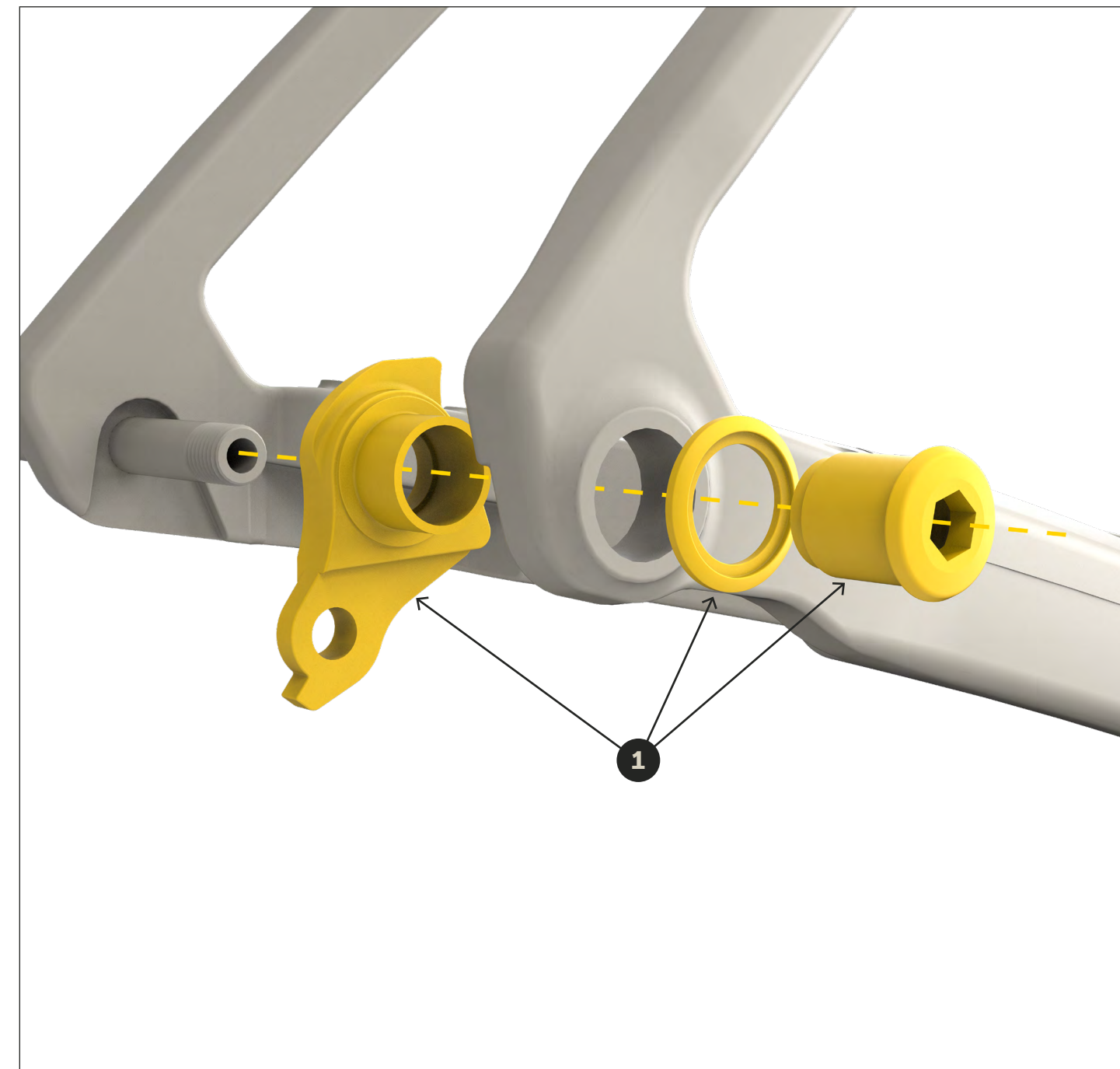

KFC09006 | 'SHED' STORAGE ASSEMBLY

| ITEMS | PART # | DESCRIPTION | QTY |
|-------|-------------|---|-----|
| 1 | MPAC24001 | PORTE DE RANGEMENT ASSEMBLÉE | 1 |
| 1.1 | MFP24027 | SYSTEM DOOR | 1 |
| 1.2 | MFP24028 | MECANISM COVER | 1 |
| 1.3 | MFP24029 | SYSTEM LOCK | 1 |
| 1.4 | MFV097132 | FLAT HEAD THREAD FORMING SCREW FOR PLASTIC, #4 X 3/8" | 2 |
| 1.5 | MFV07003-01 | ALLEN BUTTON SCREW M5x0.8 X 12 | 2 |
| 1.6 | MFP24030 | SYSTEM SEAL | 1 |

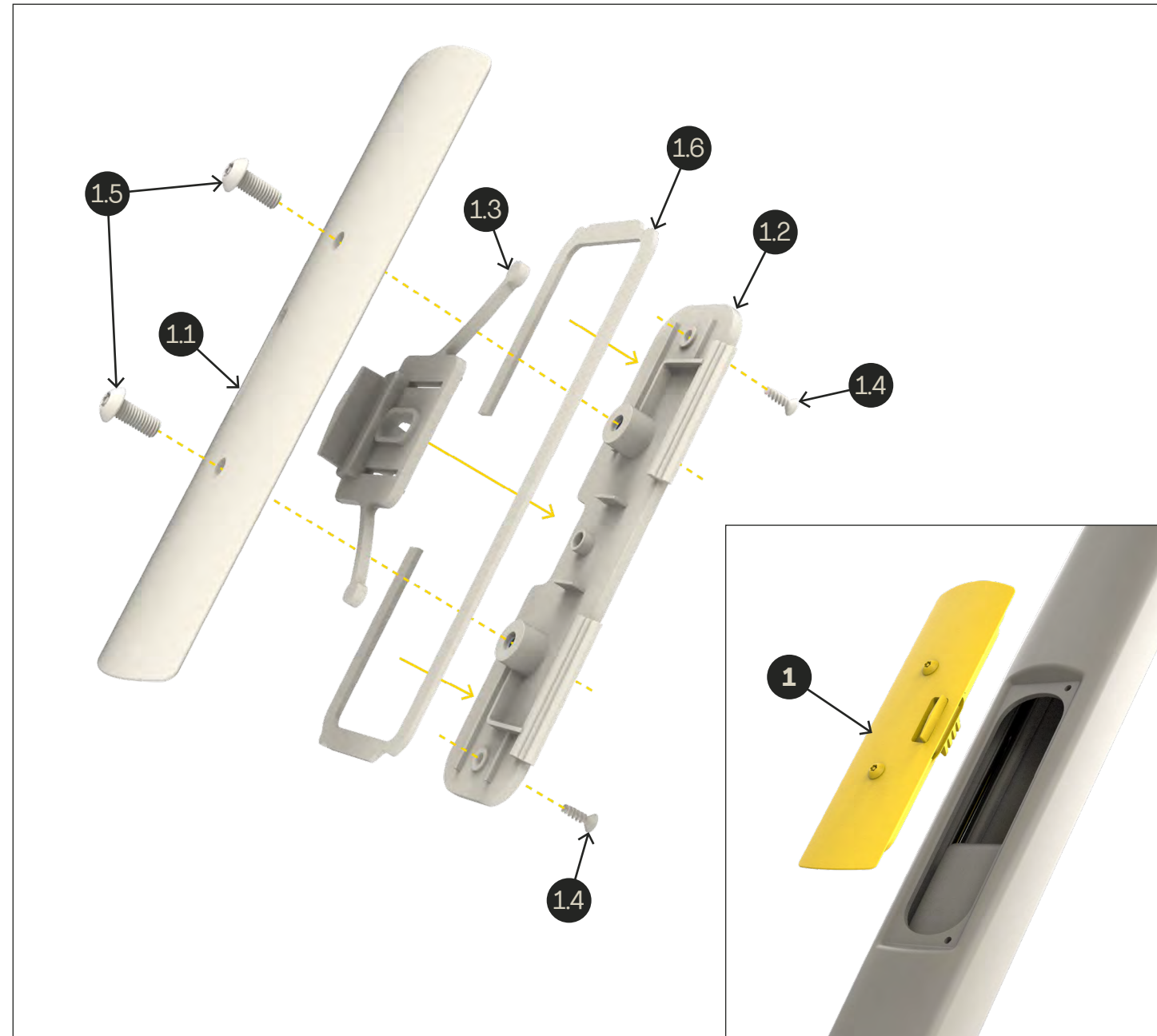

KFC09007 | TOOL BAG FOR SHED STORAGE



| ITEMS | PART # | DESCRIPTION | QTY |
|-------|----------|-------------|-----|
| 1 | MFP24031 | Tool bag | 1 |





WARRANTY



DEVINCI'S RIDE IN PEACE WARRANTY

ALL OUR FRAMES HAVE A LIFETIME WARRANTY

WARRANTY COVERAGE

All Devinci frames are covered by a manufacturer's warranty against defects in materials and workmanship for a specified period, as detailed below, starting from the date of purchase. Any parts replaced or repaired under this warranty are covered for the remaining duration of the original warranty period.

The bicycle owner must provide proof of purchase to make a warranty claim.

Replacement parts are subject to availability within Devinci's inventory at the time of the claim. In some cases, the color, features, and/or model may differ from the original part.

At Devinci's discretion, certain costs may apply when processing a warranty replacement or repair, including:

- Shipping fees
- Additional labor costs associated with the installation or repair of a part
- Costs of replacing parts that are worn out or obsolete at the time of the claim.

WARRANTY PERIOD

- For the original purchaser:
 - Aluminum frames are covered for the lifetime of the bicycle's useful life.
 - Carbon fiber frames are covered for five (5) years from the original date of purchase.

- For subsequent owners:
 - Frames are covered for three (3) years from the original date of purchase.

→ Paint and decals are covered for a period of 1 year.

→ Pivots (including bearings, bolts and axis) are covered for 1 year.

Components assembled on Devinci frames are guaranteed by their respective manufacturers. Contact your authorized Devinci retailer for more information regarding the applicable warranty.

WARRANTY EXCLUSIONS

At Devinci's discretion, the warranty may not apply in the following situations:

1. The bicycle was not purchased at an authorized Devinci retailer;
2. The bicycle was not entirely assembled by an authorized Devinci retailer;
3. The bicycle was not repaired by an authorized Devinci retailer;
4. The instructions contained in the user's manual and/or the technical manual were not entirely respected;
5. Periodic inspection/maintenance recommended in the user's manual and/or the technical manual were not entirely respected;
6. Incompatible parts/components were assembled on the bicycle. Compatible parts includes the original parts and those who comply to the technical manual's recommendations;
7. Paint was damaged in relation to the installation or removal of an adhesive frame protector;
8. The damages were caused by a case of force majeure, such as:
 - An accident, impact or crash;
 - Abusive, abnormal or excessive use, neglect.
 - Intensive use.
 - Improper or repeated use of mechanical lift, car racks or any other mean of bike transport.

Using a bike in competitions, or in environments or types of terrain/activities other than those for which the bike is designed are some examples of intensive or abusive use.9. Using a bike previously damaged by a case of force majeure.

10. The frame and/or its components have been modified (ex: polishing, grinding, sanding, strain harde-



ning, shot peening, structural or mechanical modifications, etc.)

11. The frame is inadequate (size, model) considering the user size.

12. The damages are caused by normal wear and tear, including those caused by natural material fatigue mechanisms.

LIMITATION OF LIABILITY

The present warranty is an integral warranty, complete and final, for Devinci frames. Devinci does not give authorization to any other person, including the authorized Devinci retailers, to assume or grant, expressly or implicitly, any or all addition(s) or extension(s) to the warranty specified herein. Any other obligation or responsibility expressed by any other person(s) and any demonstration or illustration of Devinci frames is in no way linked to Devinci and is furthermore excluded from this warranty. Devinci assumes no liability in case of any property damage, moral or bodily injury to the user, the buyer or any other person(s), resulting from the use of a devinci frame or one of its components.

Except as limited or expressly forbidden by law, regarding any other condition or guarantee, express or implied, based in law, established commercial customs and usage, including, but not limited to, guarantee of merchantability or adaptation to a specific end, devinci declines any responsibility for any amount exceeding the actual purchase price of the bicycle nor for any particular, accessory or consecutive damages that may occur in connection with said bicycle.

With regard to the exercising of rights resulting from the present warranty, the buyer of a devinci frame agrees to elect domicile in the judicial district of chicoutimi, in the province of quebec, canada, as an appropriate place for the hearing of all claims or legal proceedings.

RIDER ASSISTANCE PROGRAM

For those moments when life takes an unexpected turn and your situation isn't covered by our warranty, Devinci's Rider Assistance Program has you covered. Whether it's a crash, accidental damage, or just plain bad luck, we offer a discount below the original retail price to help you get back on your bike as soon as possible. This program is accessible through our customer service department or any Authorized Devinci Dealer.

WARRANTY CLAIM

As mentioned in our warranty policies, the frames of Cycles Devinci inc. are guaranteed against all manufacturing defects to the first owner. To start the warranty process, please refer to your local Devinci authorized dealer with your proof of purchase.

For more information concerning our different contact informations, go to www.devinci.com/contact-us



Head Office

1555 Manic
Chicoutimi (Quebec) Canada
G7K 1G8

www.devinci.com
